



CONSTRUCTION DIVISION
 2441 Headington Road
 Placerville CA 95667
 Phone: (530) 642-4987
 Fax: (530) 295-2655

JAMES W. WARE, P.E.
 Director of Transportation

 Internet Web Site:
<http://edcgov.us/dot>

MAIN OFFICE
 2850 Fairlane Court
 Placerville CA 95667
 Phone: (530) 621-5900
 Fax: (530) 626-0387

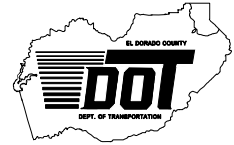

DATE: August 4, 2011

TO: All Prospective Bidders

SUBJECT: Addendum No. 2
El Dorado Trail Culvert Replacement Project
(Contract No. PW 11-30587, Project No. 99565)

Submit proposals for this work with the understanding and full consideration of this addendum. The revisions declared in this addendum are essential parts of the Contract.

ITEM NO.	LOCATION, PAGE OR DRAWING NO.	DESCRIPTION OF CHANGE
2.01	Plan Sheets 1 through 10	Revisions to the existing ground and design elevations have been made on the plans to address the error found in the topographic survey. Revised Plan Sheet D-1 (3 of 10) issued with Addendum No. 1 has also been revised to show a single concrete cut off wall. Revised Plan Sheet CS-1 (5 of 10) issued with Addendum No. 1 has no further revisions, but has been attached to this addendum. Bidders are instructed to replace original Plan Sheets 1, 2, 4, 6, 7, 8, and 9 of 10 and revised Plan Sheets 3 and 5 of 10 (issued with Addendum No. 1) with the revised Plan Sheets 1 of 10 through 10 of 10 attached to this Addendum No. 2.
2.02	N-1 and SP-7	Section 4-1.01 "General" of the special provisions Replace the 4 th and 5 th paragraphs with the following: <i>"The work shall be diligently prosecuted to completion before the expiration of THIRTY-FIVE (35) WORKING DAYS.</i> <i>The Contractor shall pay to the</i>

		<p><i>County of El Dorado the sum of One Thousand Dollars (\$1,000) per day, for each and every calendar day's delay in finishing the work in excess of THIRTY-FIVE (35) WORKING DAYS."</i></p> <p>Add the following as the last paragraph of this section:</p> <p><i>"Since portions of the work may become weather dependent, bidder shall be aware that weather related temporary suspensions of work may occur. In the event that a suspension of work is ordered by the Engineer due to unsuitable weather conditions, and in the sole judgment of the Engineer, the Contractor has prosecuted the work with energy and diligence prior to the time that the operations were suspended, the cost of providing and maintaining temporary erosion control and site stabilization during the temporary suspension will be paid for as extra work as provided in Section 4-1.03D of the Standard Specifications.</i></p> <p><i>Except as provided above, any temporary suspension of work shall be in accordance with Section 8-1.05, TEMPORARY SUSPENSION OF WORK, of the Standard Specifications."</i></p>
2.03	SP-38	<p>Section 10-1.01 "Order of Work" of the special provisions</p> <p>Add the following as the last paragraph of this section:</p> <p><i>"The Contractor shall complete all work necessary to have the new 54" Corrugated Steel Pipe in place including placement of pipe, joints secure, no less than two (2) vertical feet of backfill over the top of the pipe, and have the pipe</i></p>

		<i>capable of passing stream flows, within 25 working days after the notice to proceed is issued.</i>
2.04	Item 1.04 of Addendum No.1	Change “ <i>concrete cut off walls</i> ” to “ <i>concrete cut off wall.</i> ”
2.05	Item 1.08 of Addendum No. 1 Pages C-9rev and P-3rev	Replace Page C-9rev of Exhibit A Contractor’s Bid and Bid Price Schedule issued with Addendum No. 1 with Page C-9rev 2 attached to this Addendum No. 2. Replace Page P-3rev of the Proposal Pay items and Bid Price Schedule issued with Addendum No. 1 with Page P-3rev 2 attached to this Addendum No. 2.

Page C-9rev 2, Exhibit A Contractor’s Bid and Bid Price Schedule, shall be attached to page C-9rev issued with Addendum No. 1 and page C-9 in the original Draft Agreement in the Contract Document Booklet. Page P-3rev 2, Proposal Pay Items and Bid Price Schedule, shall be attached to page P-3rev issued with Addendum No. 1 and page P-3 in the original Proposal in the Contract Document booklet. The remaining pages of this addendum, excluding the revised plan sheets, shall be attached to the Contract Documents booklet.

Indicate receipt of this addendum by filling in the number of this addendum in the space provided on the signature page of the proposal.

Holders who have already mailed their proposal can contact Janel Gifford at (email: Janel.Gifford@edcgov.us) to arrange return of their proposal.

Inform all suppliers and subcontractors as necessary.

The DOT is only sending this addendum by posting on the following website: <http://www.edcgov.us/Government/DOT/Bids.aspx>.

If you are not a Contract Documents Holder, but request a set of documents to bid on this project, you must comply with the requirements of this addendum when submitting your bid.

Attachments:

Revised Plan Sheets 1 of 10 through 10 of 10	10 pages
Page C-9rev 2 Exhibit A Contractor's Bid and Bid Price Schedule	1 page
Page P-3rev 2 Proposal Pay Items and Bid Price Schedule	1 page

End of Addendum No. 2

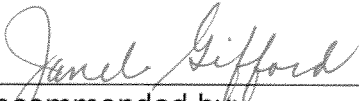

Recommended by:
Janel Gifford, P.E.
Office Engineer

8/5/11
Date



Approved by:
Robert S. Slater, P.E.
Assistant Director of Transportation
for James W. Ware, P.E.
Director of Transportation

8/5/11
Date

DEPARTMENT OF TRANSPORTATION COUNTY OF EL DORADO, CA

PROJECT PLANS FOR THE CONSTRUCTION OF EL DORADO TRAIL CULVERT REPLACEMENT

IN THE COUNTY OF EL DORADO, DISTRICT 3
NORTH SIDE OF HIGHWAY 50 AT MP 19.5 ON THE EL DORADO TRAIL

To be supplemented with Standard Plans and Specifications dated May 2006,
including the amendments to the May 2006 Standard Specifications, of the
California Department of Transportation, unless otherwise noted.

INDEX OF SHEETS

SHEET	PLAN SHEET	TITLE
1		TITLE SHEET
2	L-1R	LAYOUT
3	D-1R	DRAINAGE LAYOUT
4	DM-1R	DEMOLITION AND EXCAVATION
5	CS-1	CONSTRUCTION AREA SIGNS, TRAIL CLOSURE, AND OVERLAY LIMITS
6-10	X-1R THRU X-5R	EXISTING GROUND CROSS SECTIONS

ABBREVIATIONS:

AP - ANGLE POINT

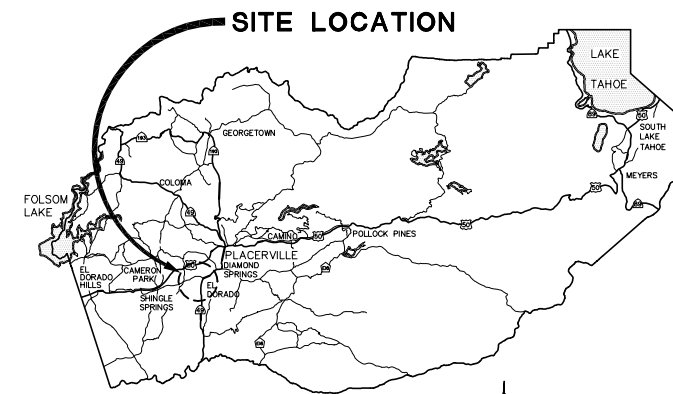

VICINITY MAP
COUNTY OF EL DORADO

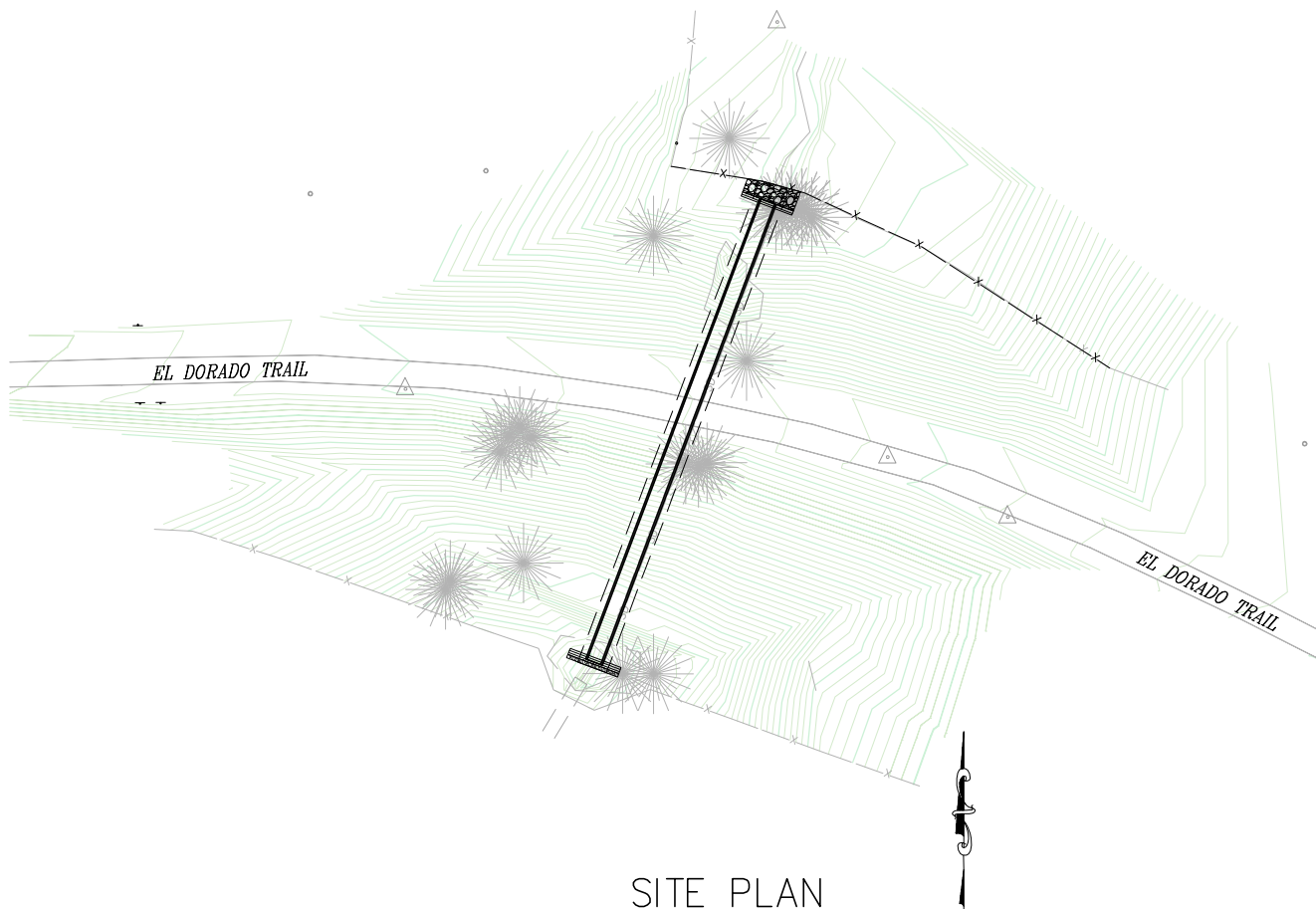

SITE PLAN
SCALE: 1"=30'

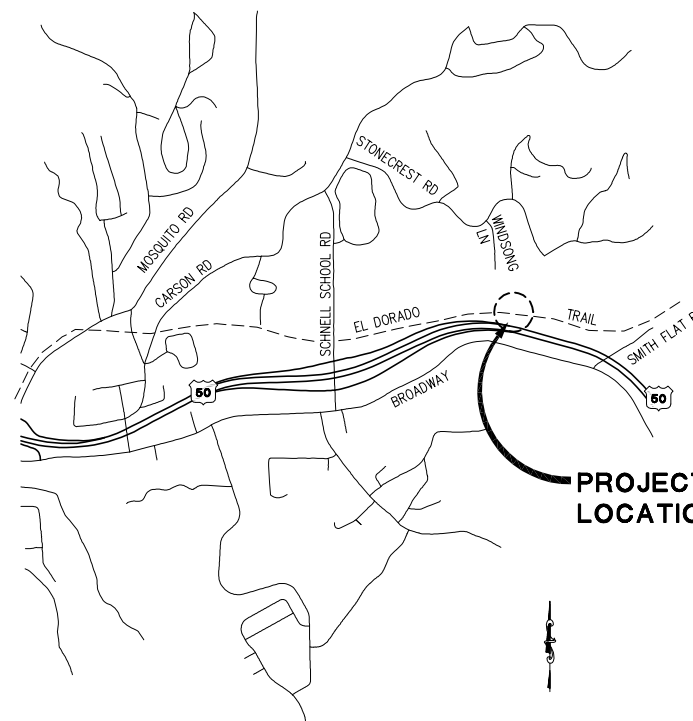

LOCATION MAP
NOT TO SCALE

CONTRACTOR'S LICENSE CLASSIFICATION: Bidders shall be properly licensed to perform the Work pursuant to the State Contractor's License Act (Business and Professions Code section 7000 et seq.) and shall possess a CLASS A LICENSE or equivalent combination of Classes required by the categories and type of Work included in the Contract Documents and Plans. If the Contractor possesses a Class A license instead of the equivalent combination of Classes required by the categories and type of work included in the Contract Documents and Plans, then the Contractor or a subcontractor must also possess a CLASS C27 "Landscaping Contractor" license. Failure of the successful Bidder to obtain proper and adequate licensing at the time bids are submitted shall constitute a failure to execute the Contract, and forfeiture as provided under that section.

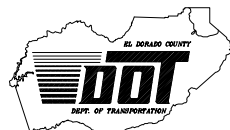

Dwight G. Anderson 07-12-11
DATE
SUBMITTED BY:
CIVIL ENGINEER
STATE OF CALIFORNIA NO. 69999

BOARD OF SUPERVISORS

I	JOHN KNIGHT
II	RAYMOND J. NUTTING
III	JAMES SWEENEY
IV	RON V. BRIGGS
V	NORMA SANTIAGO

COUNTY OF EL DORADO DEPARTMENT OF TRANSPORTATION

(530) 621-5900
2850 FAIRLANE CT
PLACERVILLE, CA 95667

ADOPTED AND APPROVED BY:	DATE
<i>[Signature]</i>	7-19-11
RAYMOND J. NUTTING CHAIR, EL DORADO COUNTY BOARD OF SUPERVISORS	
APPROVED BY:	DATE
<i>[Signature]</i>	7/18/11
JAMES W. WARE, P.E. NO. 69036 DIRECTOR, EL DORADO COUNTY DEPARTMENT OF TRANSPORTATION	
MATTHEW D. SNEITZER, P.E. NO. C68832 DEPUTY DIRECTOR ENGINEERING DIVISION, EL DORADO COUNTY DEPARTMENT OF TRANSPORTATION	7/18/11

REVISIONS

MARK	DATE	BY	REVISIONS
2	08/01/11	SGM	REVISIONS TO EXISTING GROUND AND DESIGN ELEVATIONS

PW NO. PW 11-30587 PROJECT NO. 99565

EL DORADO TRAIL CULVERT REPLACEMENT

TITLE-R SHEET
1 OF 10
SHEET

ORIGINAL SCALE IS IN INCHES
 Drawing name: C:\Civil 3D\Projects\99565 El Dorado Trail Culvert\Repair\CADD\Files\Sheets\L-1R.dwg Layout Tab: L-1 Aug 02, 2011 10:52am abishop
 FOR REDUCED PLANS
 2
 1
 0

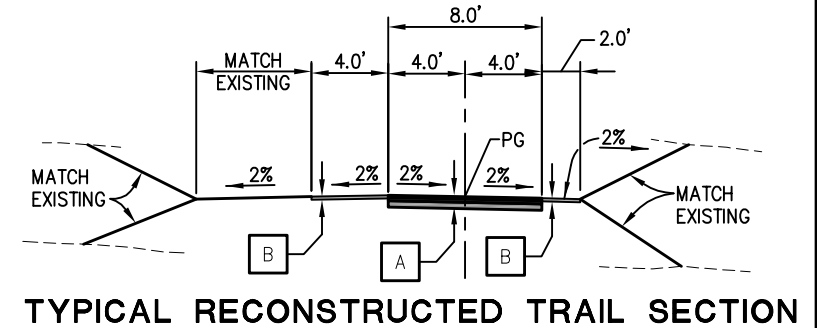
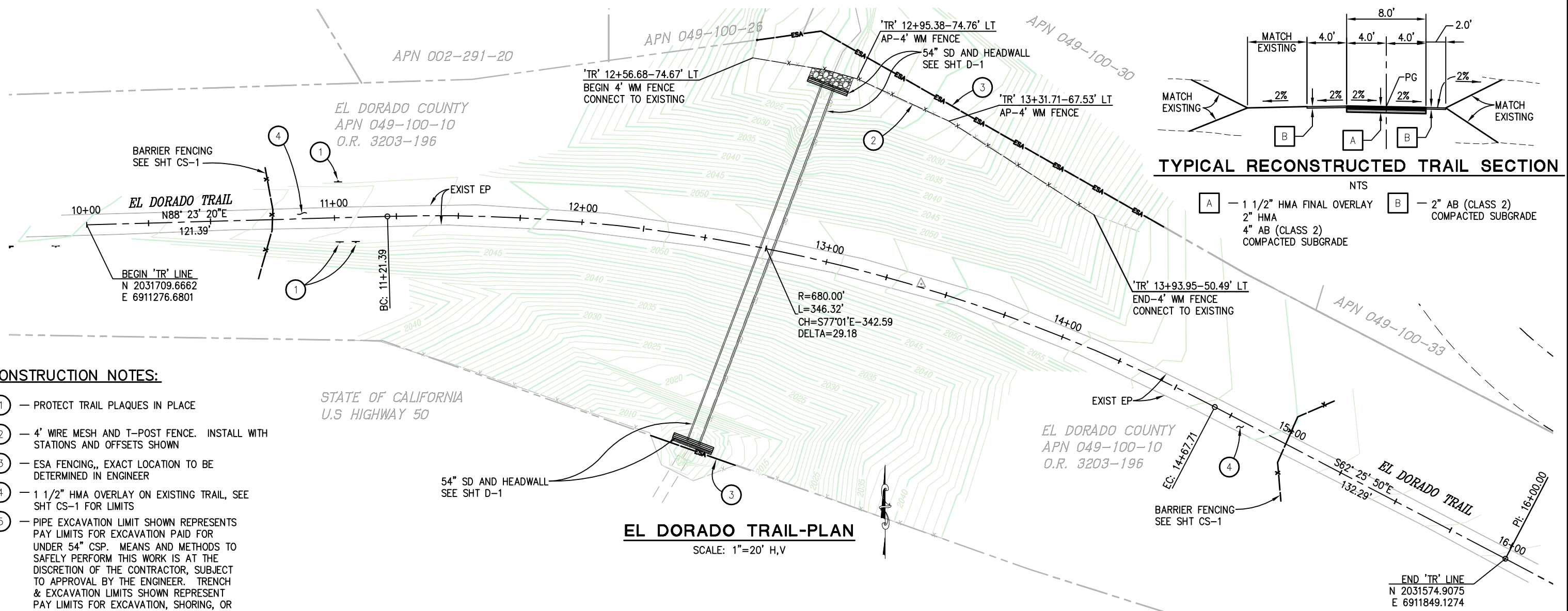

- NTS
- A - 1 1/2" HMA FINAL OVERLAY
 - B - 2" AB (CLASS 2) COMPACTED SUBGRADE

CONSTRUCTION NOTES:

- ① - PROTECT TRAIL PLAQUES IN PLACE
- ② - 4' WIRE MESH AND T-POST FENCE. INSTALL WITH STATIONS AND OFFSETS SHOWN
- ③ - ESA FENCING,, EXACT LOCATION TO BE DETERMINED IN ENGINEER
- ④ - 1 1/2" HMA OVERLAY ON EXISTING TRAIL, SEE SHT CS-1 FOR LIMITS
- ⑤ - PIPE EXCAVATION LIMIT SHOWN REPRESENTS PAY LIMITS FOR EXCAVATION PAID FOR UNDER 54" CSP. MEANS AND METHODS TO SAFELY PERFORM THIS WORK IS AT THE DISCRETION OF THE CONTRACTOR, SUBJECT TO APPROVAL BY THE ENGINEER. TRENCH & EXCAVATION LIMITS SHOWN REPRESENT PAY LIMITS FOR EXCAVATION, SHORING, OR OTHER MEANS CONTRACTOR MAY DETERMINE NECESSARY TO SAFELY CONSTRUCT THE WORK.

GENERAL NOTES:

1. SEE SHEET DM-1 FOR DEMOLITION AND EXCAVATION DETAILS
2. SEE SHEET D-1 FOR STORM DRAINAGE DETAILS
3. EROSION CONTROL (TYPE D) SHALL BE APPLIED TO ALL EXPOSED DISTURBED SOIL AREAS
4. FIBER ROLLS SHALL BE INSTALLED ON LEVEL CONTOURS WITH MINIMUM SPACING OF EVERY 10' IN ELEVATION CHANGE
5. SLOPES STEEPER THAN 2:1 HORIZONTAL:VERTICAL SHALL BE COVERED WITH EROSION CONTROL BLANKET
6. CONTRACTOR SHALL LIMIT DISTURBANCE TO LESS THAN ONE ACRE.

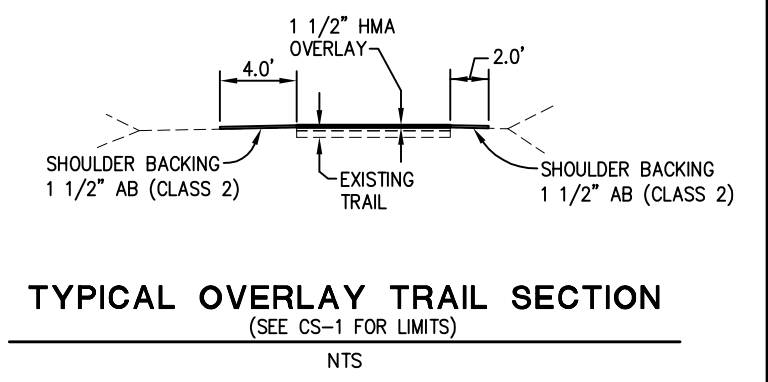
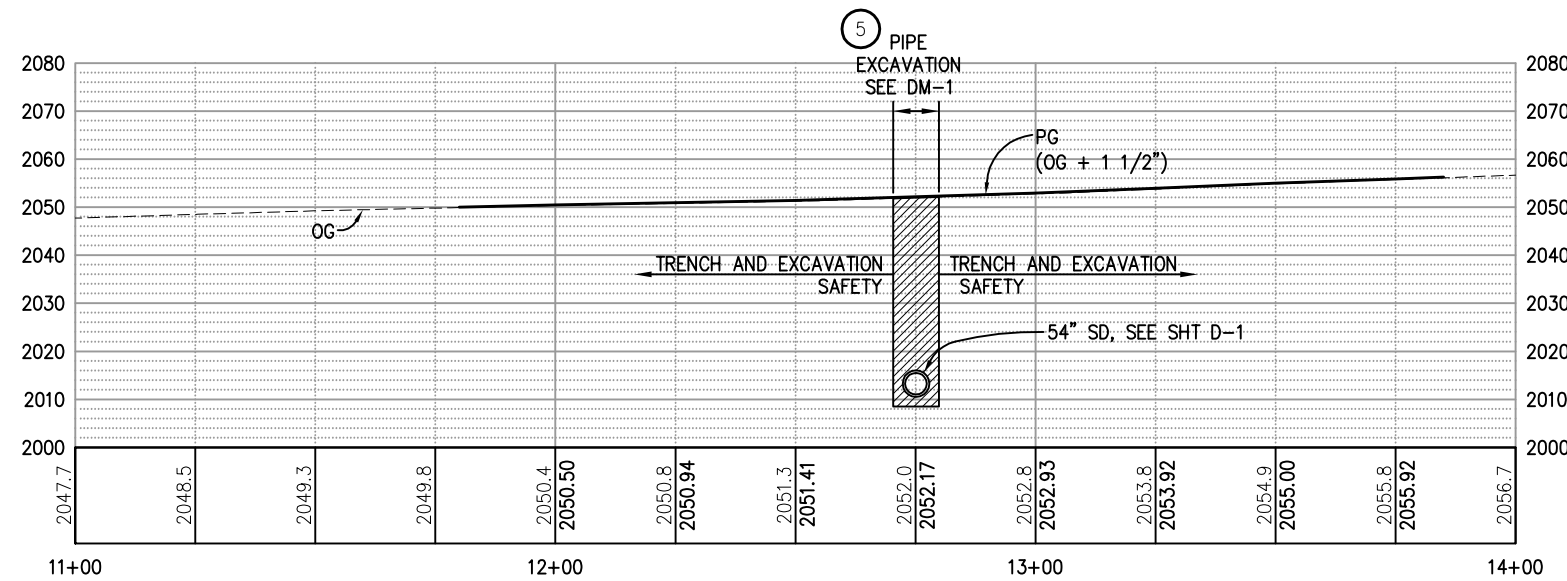

PREPARED UNDER THE SUPERVISION OF:
Dwight D. Anderson
 REGISTERED CIVIL ENGINEER
 07-12-11

DESIGNED: DA
 DRAWN: SGM
 CHECKED: AB
 DATE: 08/01/11
 ROAD NUMBER: -

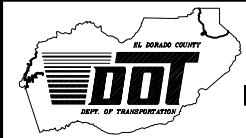

EL DORADO COUNTY
 DEPARTMENT OF TRANSPORTATION

EL DORADO TRAIL CULVERT REPLACEMENT

LAYOUT SCALE : AS SHOWN

SHEET
L-1R
 2 OF 10
 W.O. No. **99565**

REVISION	NUMBER	DATE	DESCRIPTION	BY
2	08/01/11		REVISIONS TO EXISTING GROUND AND DESIGN ELEVATIONS	SGM

ORIGINAL SCALE IS IN INCHES
Drawing name: C:\Civil 3D\Projects\99565 El Dorado Trail Culvert Repair\CADD\Files\Sheets\0-1.dwg Layout Tab: D-1 Aug 03, 2011 - 2:12pm abishop
FOR REDUCED PLANS

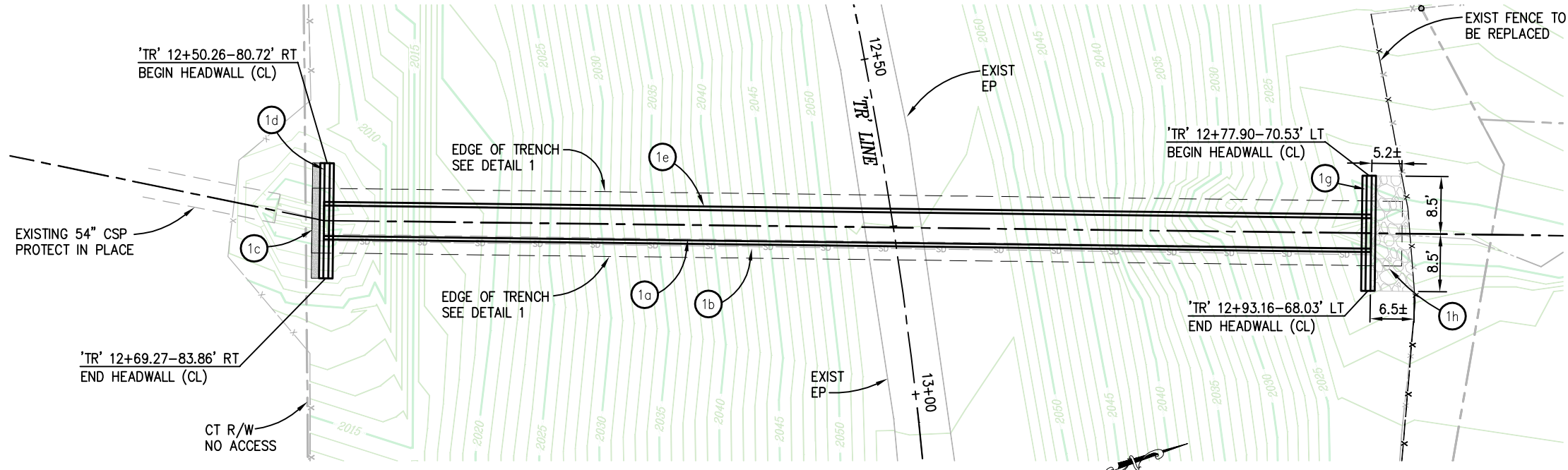

DRAINAGE SYSTEM-PLAN
SCALE: 1"=10'

- GENERAL NOTES:**
- REFER TO SHEET DM-1 FOR EXCAVATION AND TRENCHING.
 - TRAIL ALIGNMENT SHOWN FOR REFERENCE. SEE SHEET L-1

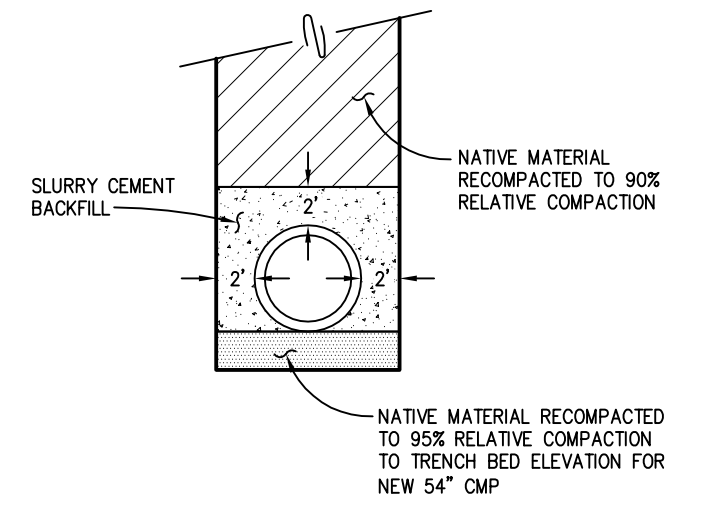

1 TRENCH DETAIL
NTS

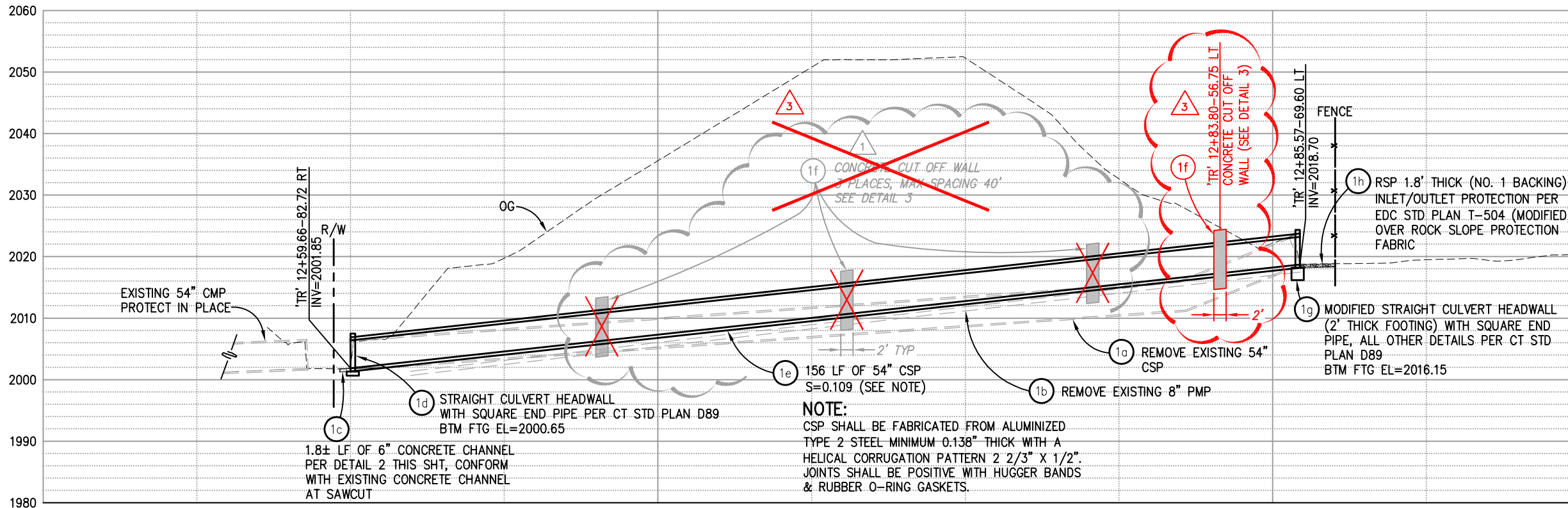

DRAINAGE SYSTEM-PROFILE
SCALE: 1"=10' H,V

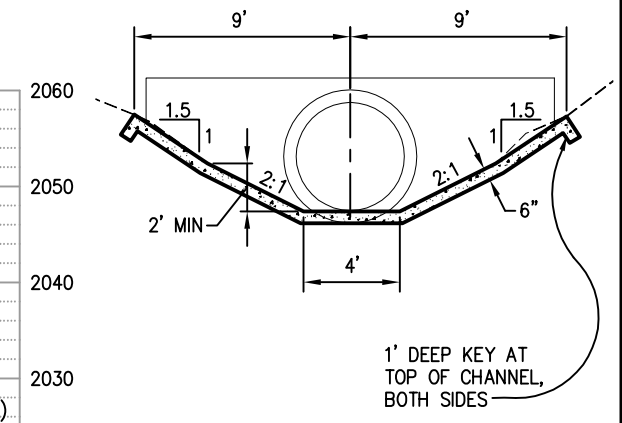

2 CONCRETE CHANNEL
NTS

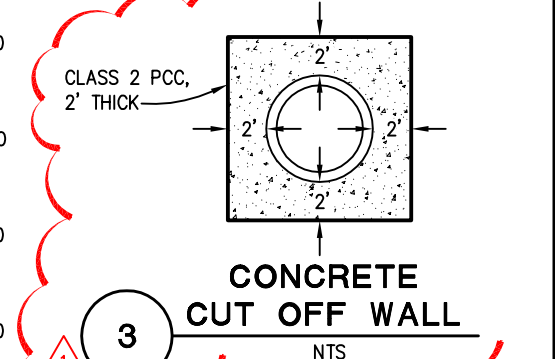

3 CONCRETE CUT OFF WALL
NTS

DRAINAGE LAYOUT SCALE: 1" = 10' H,V

REVISION	DATE	DESCRIPTION	BY
1	07/27/11	ADDED CONCRETE CUT OFF WALLS	SGM
2	08/01/11	REVISIONS TO EXISTING GROUND AND DESIGN ELEVATIONS	SGM
3	08/01/11	MODIFY CUT OFF WALL FROM REVISION 1	ARB



PREPARED UNDER THE SUPERVISION OF:
Dwight G. Anderson
REGISTERED CIVIL ENGINEER
DATE: 07-12-11

DESIGNED: DA
DRAWN: SGM
CHECKED: AB
DATE: 08/01/11
ROAD NUMBER:

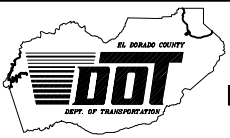

EL DORADO COUNTY DEPARTMENT OF TRANSPORTATION

EL DORADO TRAIL CULVERT REPLACEMENT

SHEET
D-1R
3 OF 10
W.O. No. **99565**

ORIGINAL SCALE IS IN INCHES
 Drawing name: C:\Civil 3D\Projects\99565 El Dorado Trail Culvert Repair\CADD Files\Sheets\DM-1.dwg Layout Tab: DM-1 Aug 02, 2011 11:03am abishop
 FOR REDUCED PLANS

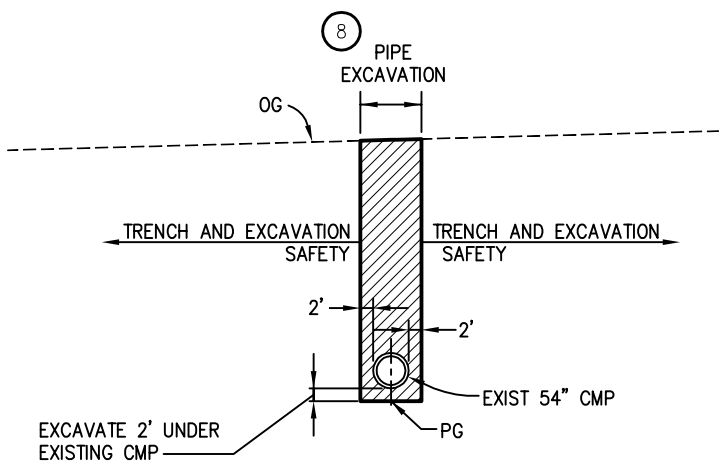
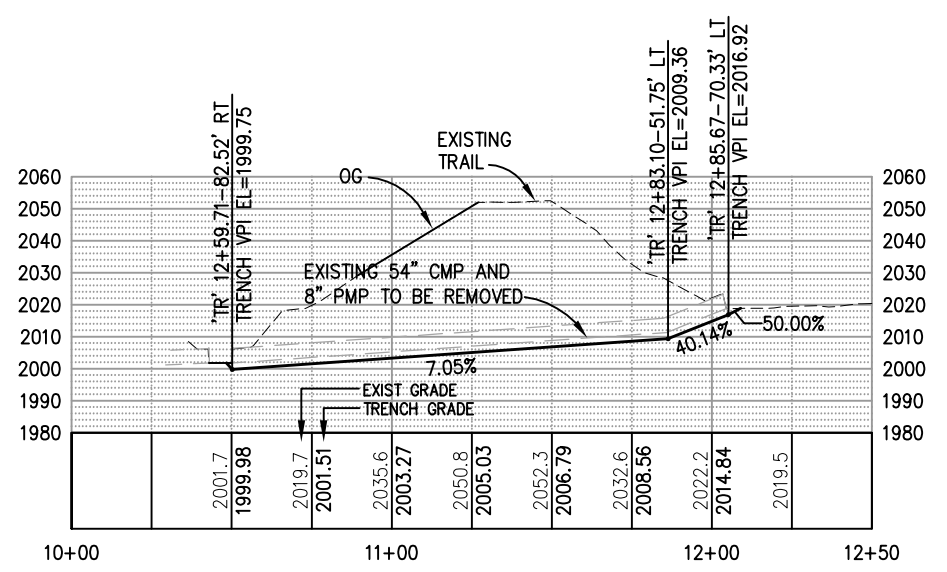
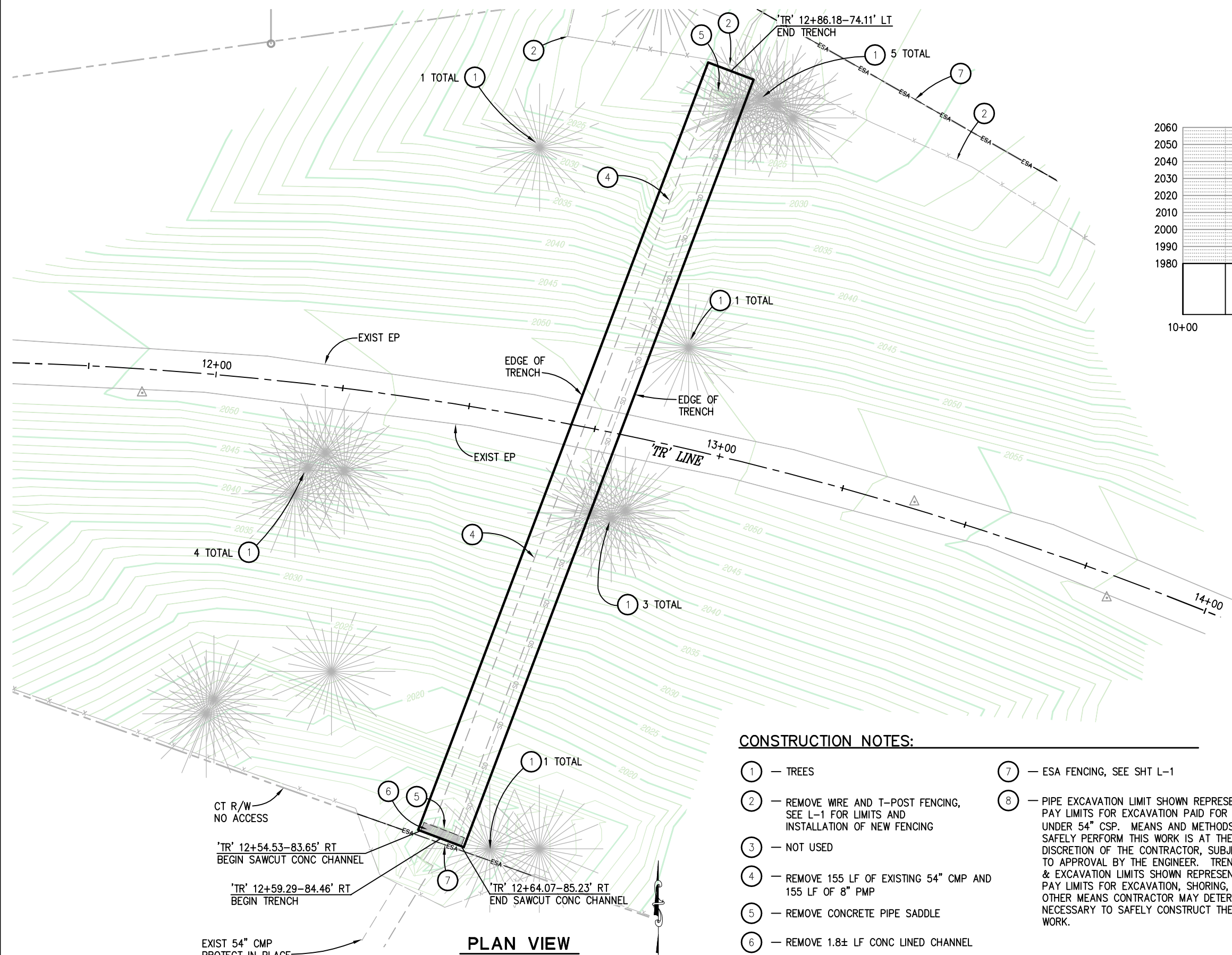

CONSTRUCTION NOTES:

- ① — TREES
- ② — REMOVE WIRE AND T-POST FENCING, SEE L-1 FOR LIMITS AND INSTALLATION OF NEW FENCING
- ③ — NOT USED
- ④ — REMOVE 155 LF OF EXISTING 54" CMP AND 155 LF OF 8" PMP
- ⑤ — REMOVE CONCRETE PIPE SADDLE
- ⑥ — REMOVE 1.8± LF CONC LINED CHANNEL
- ⑦ — ESA FENCING, SEE SHT L-1
- ⑧ — PIPE EXCAVATION LIMIT SHOWN REPRESENTS PAY LIMITS FOR EXCAVATION PAID FOR UNDER 54" CSP. MEANS AND METHODS TO SAFELY PERFORM THIS WORK IS AT THE DISCRETION OF THE CONTRACTOR, SUBJECT TO APPROVAL BY THE ENGINEER. TRENCH & EXCAVATION LIMITS SHOWN REPRESENT PAY LIMITS FOR EXCAVATION, SHORING, OR OTHER MEANS CONTRACTOR MAY DETERMINE NECESSARY TO SAFELY CONSTRUCT THE WORK.

GENERAL NOTES:

- 1. EXCAVATE 2' UNDER EXISTING PIPE
- 2. SEE L-1 FOR 'TR' LINE ALIGNMENT DATA

DEMOLITION AND EXCAVATION
 SCALE : AS SHOWN

REVISION	NUMBER	DATE	DESCRIPTION	BY
2	08/01/11		REVISIONS TO EXISTING GROUND AND DESIGN ELEVATIONS	SGM



PREPARED UNDER THE SUPERVISION OF:
Dwight G. Anderson
 REGISTERED CIVIL ENGINEER
 DATE: 07-12-11

DESIGNED: DA
 DRAWN: SGM
 CHECKED: AB
 DATE: 08/01/11
 ROAD NUMBER: -

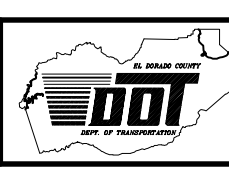

EL DORADO COUNTY
 DEPARTMENT OF TRANSPORTATION

EL DORADO TRAIL CULVERT
 REPLACEMENT

SHEET
DM-1R
 4 OF 10
 W.O. No. **99565**

ORIGINAL SCALE IS IN INCHES
 Drawing name: C:\Civil 3D\Projects\99565 El Dorado Trail Culvert Repair\CADD\Files\Sheets\CS-1.dwg Layout Tab: CS-1 Aug 01, 2011 - 1:05pm BRichards
 FOR REDUCED PLANS
 2
 1
 0

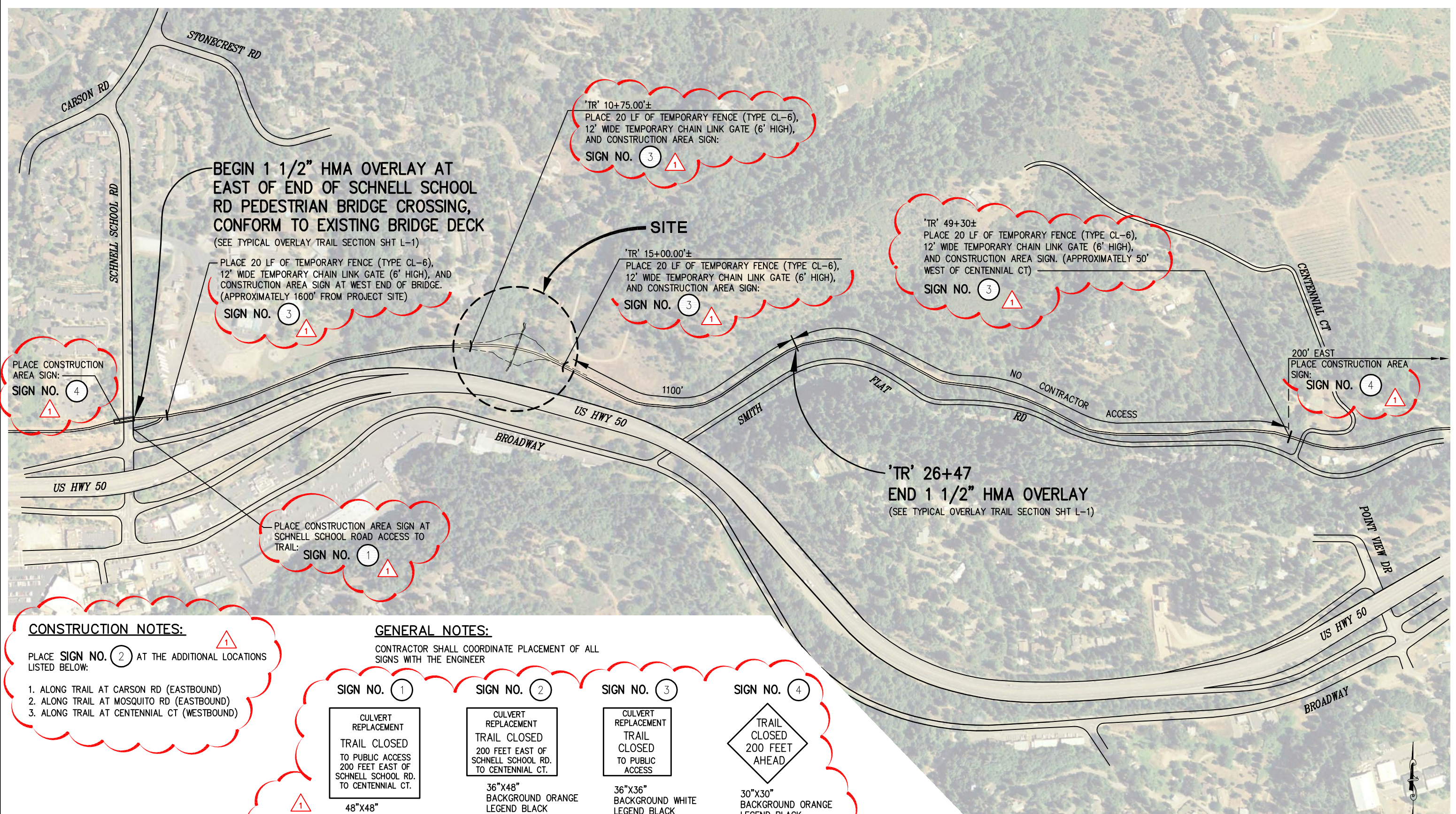

CONSTRUCTION NOTES:

PLACE SIGN NO. 2 AT THE ADDITIONAL LOCATIONS LISTED BELOW:

1. ALONG TRAIL AT CARSON RD (EASTBOUND)
2. ALONG TRAIL AT MOSQUITO RD (EASTBOUND)
3. ALONG TRAIL AT CENTENNIAL CT (WESTBOUND)

GENERAL NOTES:

CONTRACTOR SHALL COORDINATE PLACEMENT OF ALL SIGNS WITH THE ENGINEER

SIGN NO. 1	SIGN NO. 2	SIGN NO. 3	SIGN NO. 4
CULVERT REPLACEMENT TRAIL CLOSED TO PUBLIC ACCESS 200 FEET EAST OF SCHNELL SCHOOL RD. TO CENTENNIAL CT.	CULVERT REPLACEMENT TRAIL CLOSED 200 FEET EAST OF SCHNELL SCHOOL RD. TO CENTENNIAL CT.	CULVERT REPLACEMENT TRAIL CLOSED TO PUBLIC ACCESS	TRAIL CLOSED 200 FEET AHEAD
48"x48" BACKGROUND ORANGE LEGEND BLACK LETTER SIZE 3" & 4"	36"x48" BACKGROUND ORANGE LEGEND BLACK LETTER SIZE 3" & 4"	36"x36" BACKGROUND WHITE LEGEND BLACK LETTER SIZE 3" & 4"	30"x30" BACKGROUND ORANGE LEGEND BLACK LETTER SIZE 4"

CONSTRUCTION AREA SIGNS, TRAIL CLOSURE, AND OVERLAY LIMITS
 SCALE : 1" = 200'

REVISION	NUMBER	DATE	DESCRIPTION	BY
1	07/27/11		ADDED SIGN REFERENCES AND DETAILS WITH DIMENSIONS	SGM

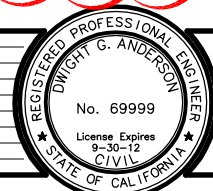

PREPARED UNDER THE SUPERVISION OF :

Dwight G. Anderson
 REGISTERED CIVIL ENGINEER
 07-12-11

DESIGNED: DA
 DRAWN: SGM
 CHECKED: DA
 DATE: 06/30/11
 ROAD NUMBER: -

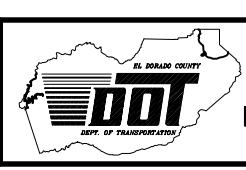

EL DORADO COUNTY
 DEPARTMENT OF TRANSPORTATION

EL DORADO TRAIL CULVERT
 REPLACEMENT

SHEET
CS-1
 5 OF 10
 W.O. No. 99565

ORIGINAL SCALE IS IN INCHES
 Drawing name: C:\Civil 3D Projects\99565 El Dorado Trail culvert Repair\CADD Files\Production drawings\Sections.dwg Layout Tab: X-1 Aug 01, 2011 - 10:22am BRichards
 FOR REDUCED PLANS
 2
 1
 0

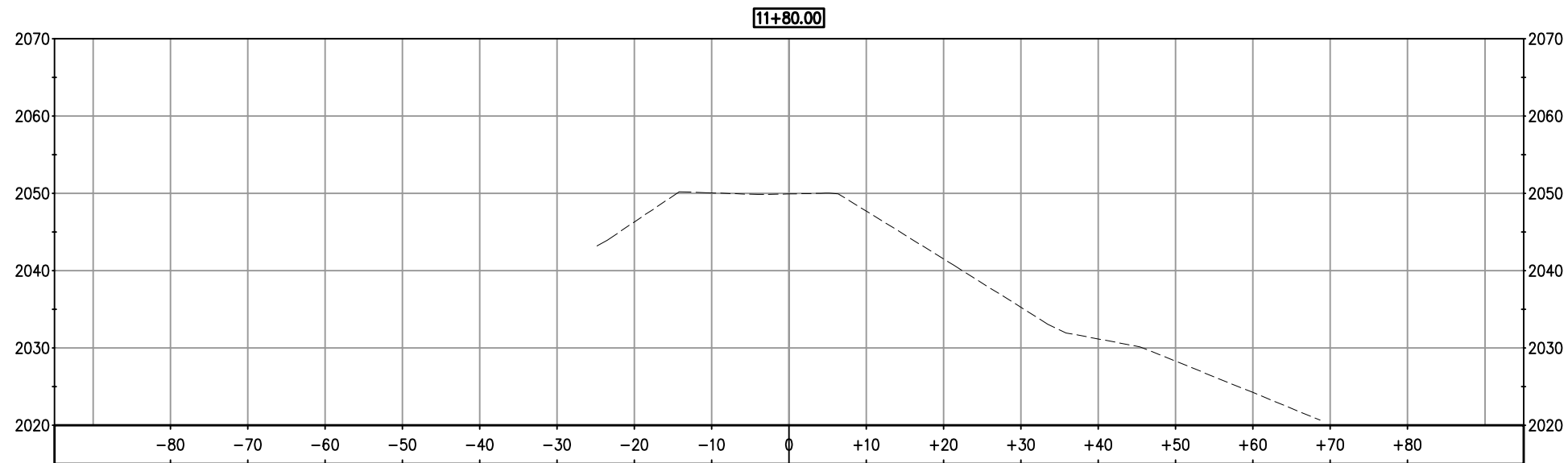
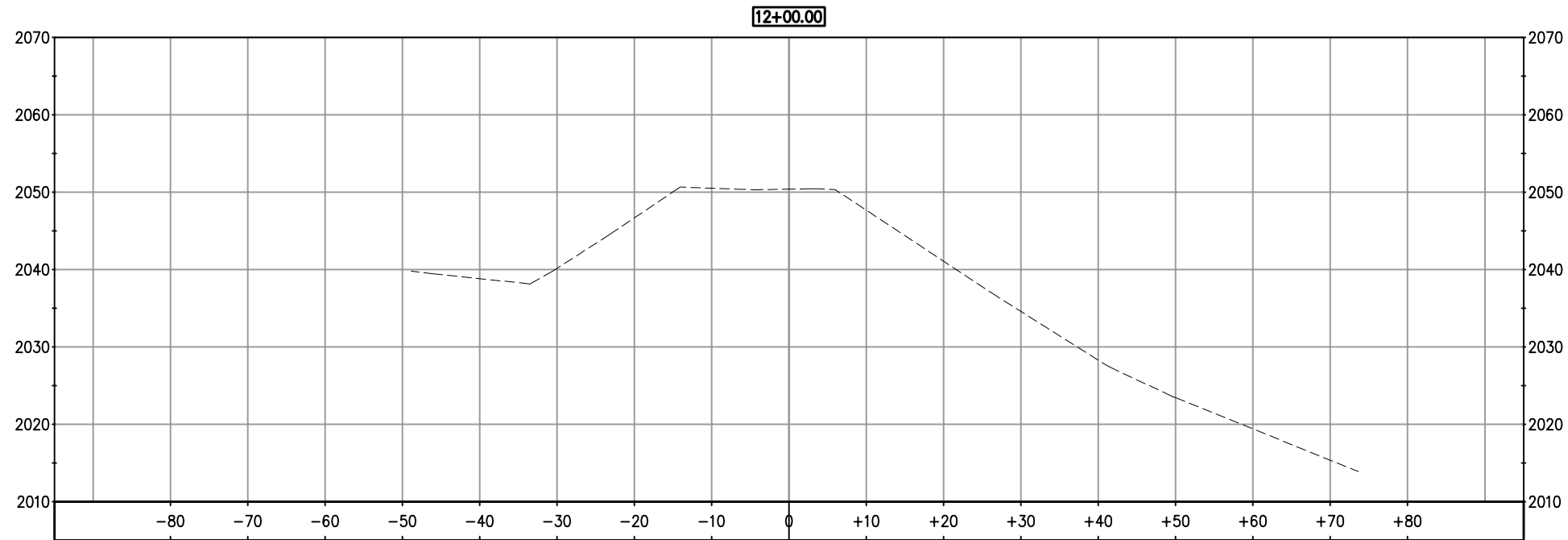

CROSS SECTIONS
SCALE : 1" = 10' H,V

REVISION	NUMBER	DATE	DESCRIPTION	BY
	2	08/01/11	REVISIONS TO EXISTING GROUND AND DESIGN ELEVATIONS	SGM



PREPARED UNDER THE SUPERVISION OF :
Dwight G. Anderson
 REGISTERED CIVIL ENGINEER
 DATE: 07-12-11

DESIGNED: DA
 CHECKED: DA
 ROAD NUMBER: -
 DRAWN: SGM
 DATE: 08/01/11

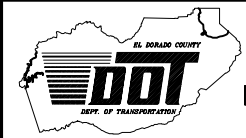

EL DORADO COUNTY
DEPARTMENT OF TRANSPORTATION

EL DORADO TRAIL CULVERT
REPLACEMENT

SHEET
X-1R
6 OF 10
W.O. No. 99565

ORIGINAL SCALE IS IN INCHES
 Drawing name: C:\Civil 3D Projects\99565 El Dorado Trail Culvert Repair\CADD Files\Production drawings\Sections.dwg Layout Tab: X-2 Aug 01, 2011 - 10:40am BRichards
 FOR REDUCED PLANS
 2
 1
 0

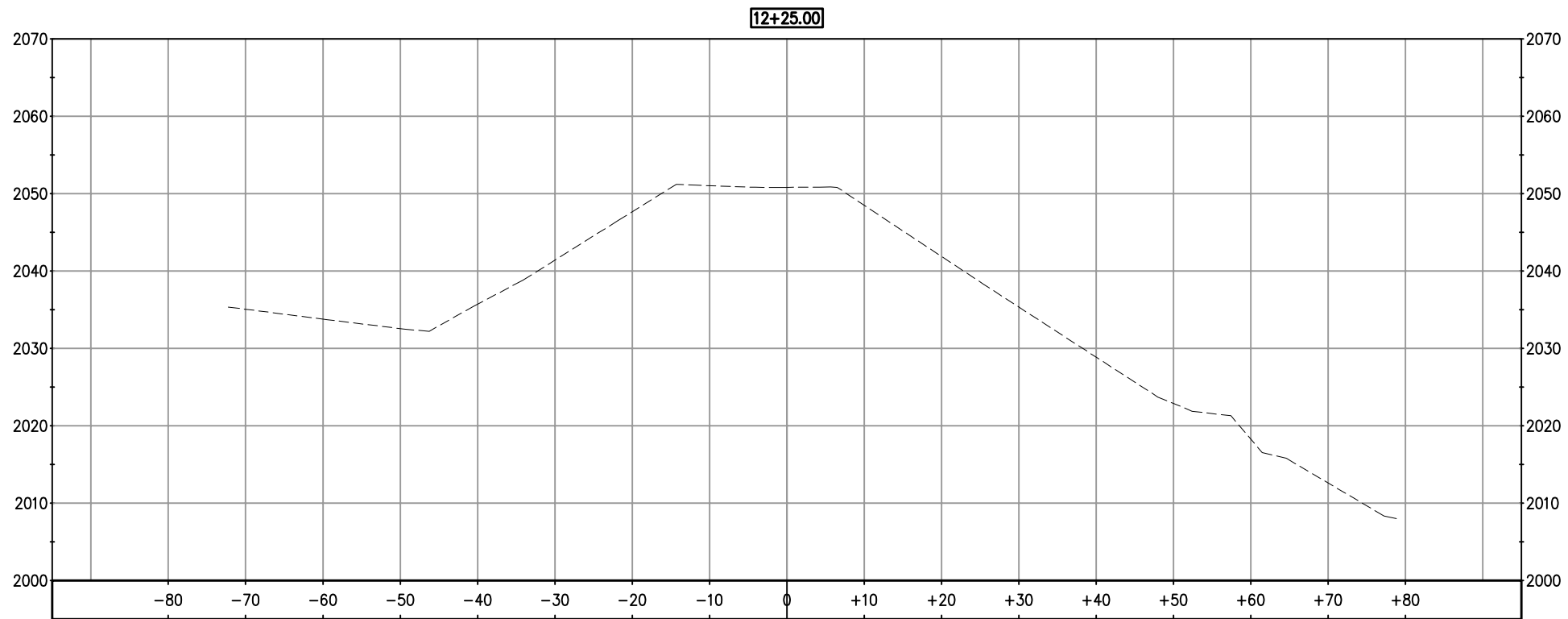
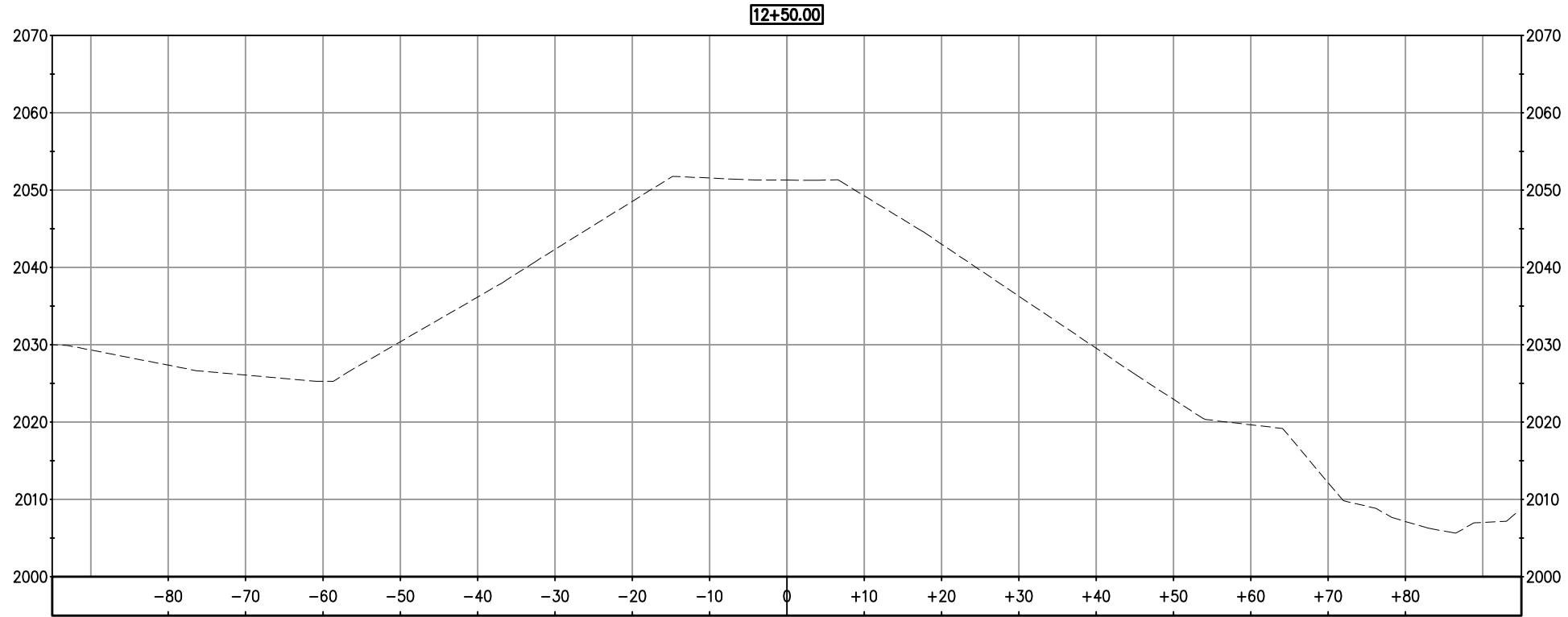

CROSS SECTIONS
 SCALE : 1" = 10' H,V

REVISION	NUMBER	DATE	DESCRIPTION	BY
	2	08/01/11	REVISIONS TO EXISTING GROUND AND DESIGN ELEVATIONS	SGM



PREPARED UNDER THE SUPERVISION OF :
Dwight D. Anderson
 REGISTERED CIVIL ENGINEER
 DATE: 07-12-11

DESIGNED: DA
 DRAWN: SGM
 CHECKED: DA
 DATE: 08/01/11
 ROAD NUMBER: -



EL DORADO COUNTY
 DEPARTMENT OF TRANSPORTATION

EL DORADO TRAIL CULVERT
 REPLACEMENT

SHEET
 X-2R
 7 OF 10
 W.O. No. 99565

ORIGINAL SCALE IS IN INCHES
Drawing name: C:\Civil 3D Projects\99565 El Dorado Trail Culvert Repair\CADD Files\Production drawings\Sections.dwg Layout Tab: X-3 Aug 01, 2011 - 10:42am BRichards

FOR REDUCED PLANS
2
1
0

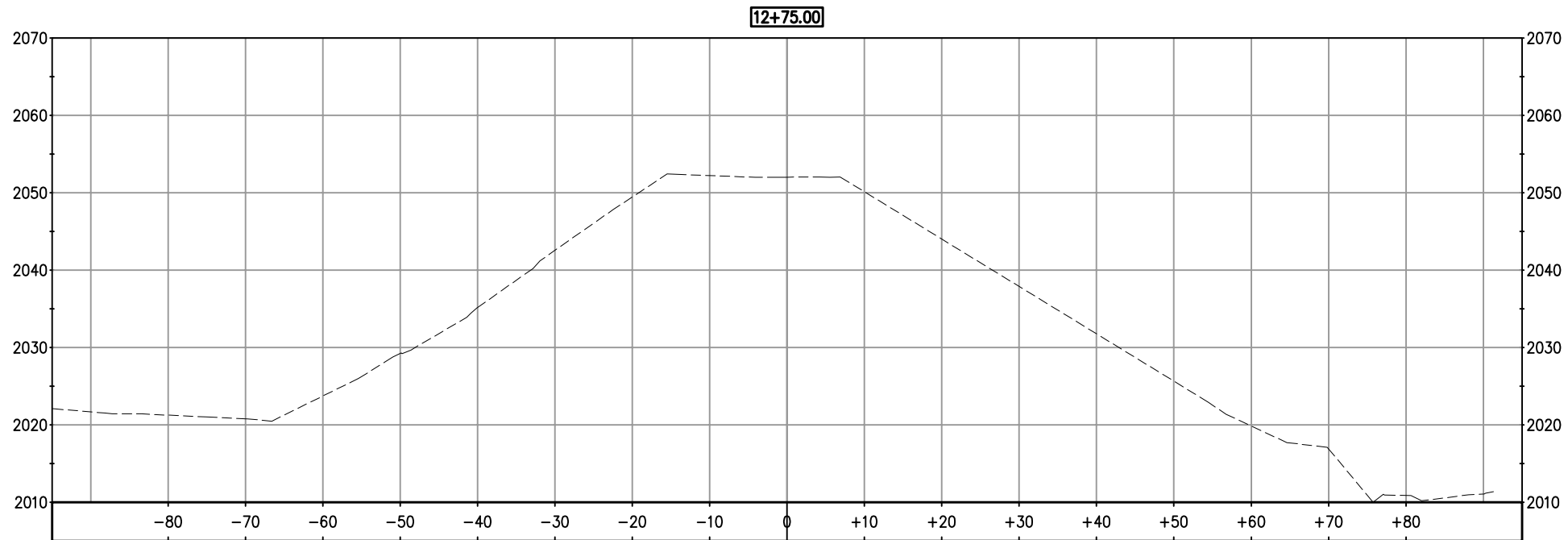
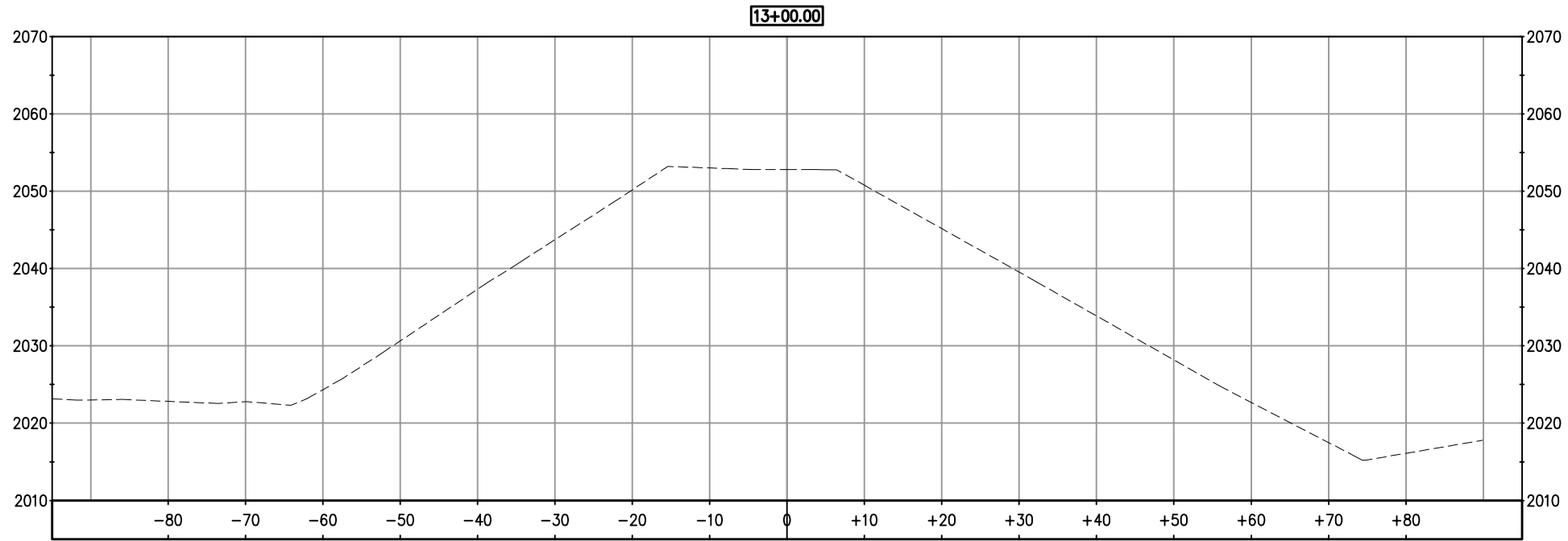

CROSS SECTIONS
SCALE : 1" = 10' H,V

REVISION	NUMBER	DATE	DESCRIPTION	BY
	2	08/01/11	REVISIONS TO EXISTING GROUND AND DESIGN ELEVATIONS	SGM



PREPARED UNDER THE SUPERVISION OF :
Dwight G. Anderson
REGISTERED CIVIL ENGINEER
DATE: 07-12-11

DESIGNED: DA
DRAWN: SGM
CHECKED: DA
DATE: 08/01/11
ROAD NUMBER: -

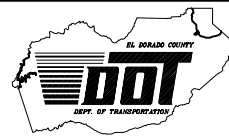

EL DORADO COUNTY
DEPARTMENT OF TRANSPORTATION

EL DORADO TRAIL CULVERT
REPLACEMENT

SHEET
X-3R
8 OF 10
W.O. No. 99565

ORIGINAL SCALE IS IN INCHES
Drawing name: C:\Civil 3D\Projects\99565 El Dorado Trail Culvert Repair\CADD Files\Production drawings\Sections.dwg Layout Tab: X-4 Aug 01, 2011 - 10:44am BRichards

FOR REDUCED PLANS
2
1
0

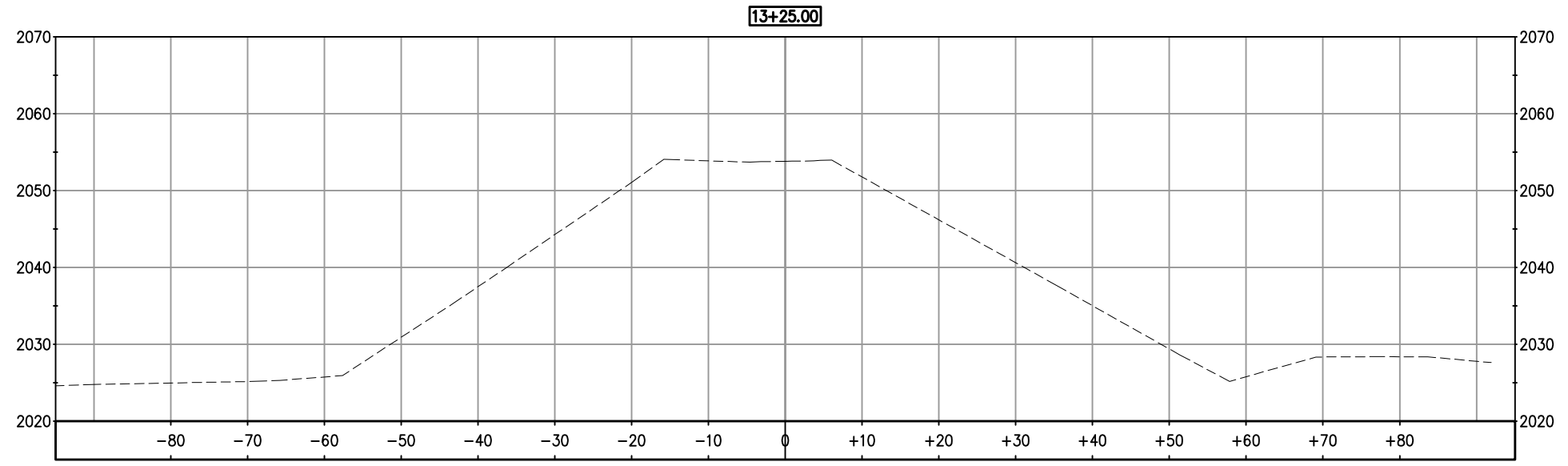
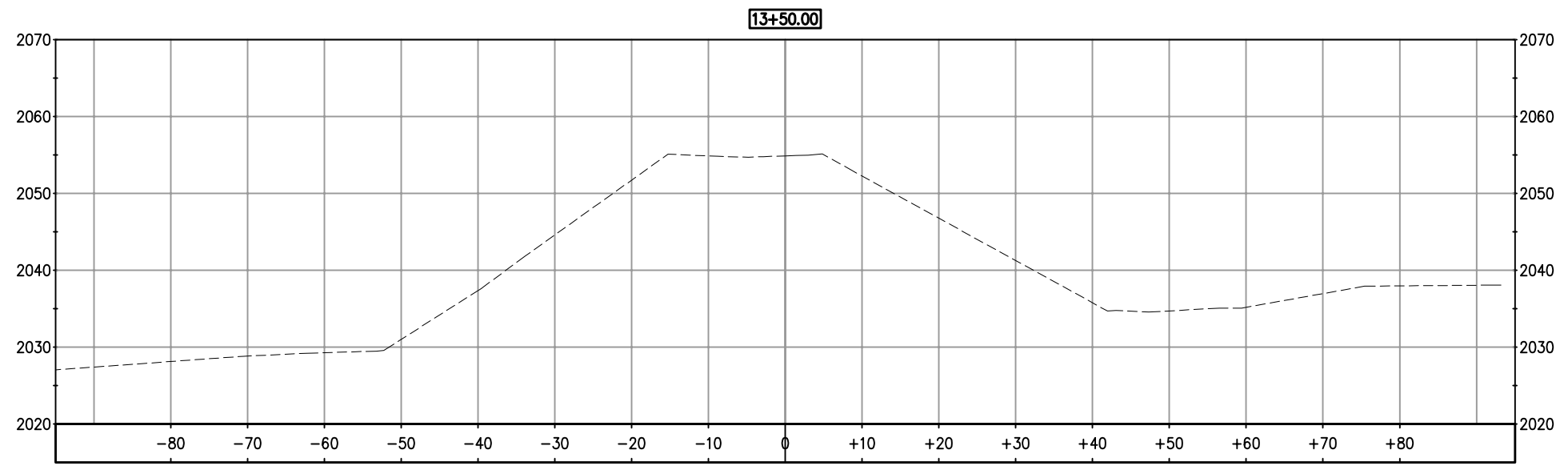

CROSS SECTIONS
SCALE : 1" = 10' H,V

REVISION	NUMBER	DATE	DESCRIPTION	BY
	2	08/01/11	REVISIONS TO EXISTING GROUND AND DESIGN ELEVATIONS	SGM



PREPARED UNDER THE SUPERVISION OF :
Dwight G. Anderson
REGISTERED CIVIL ENGINEER
DATE: 07-12-11

DESIGNED: DA
DRAWN: SGM
CHECKED: DA
DATE: 08/01/11
ROAD NUMBER: -

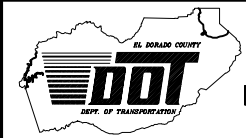

EL DORADO COUNTY
DEPARTMENT OF TRANSPORTATION

EL DORADO TRAIL CULVERT
REPLACEMENT

SHEET
X-4R
9 OF 10
W.O. No. 99565

ORIGINAL SCALE IS IN INCHES
 Drawing name: C:\Civil 3D\Projects\99565 El Dorado Trail Culvert Repair\CADD Files\Production drawings\Sections.dwg Layout Tab: X-5 Aug 01, 2011 -- 10:46am BRichards
 FOR REDUCED PLANS
 2
 1
 0

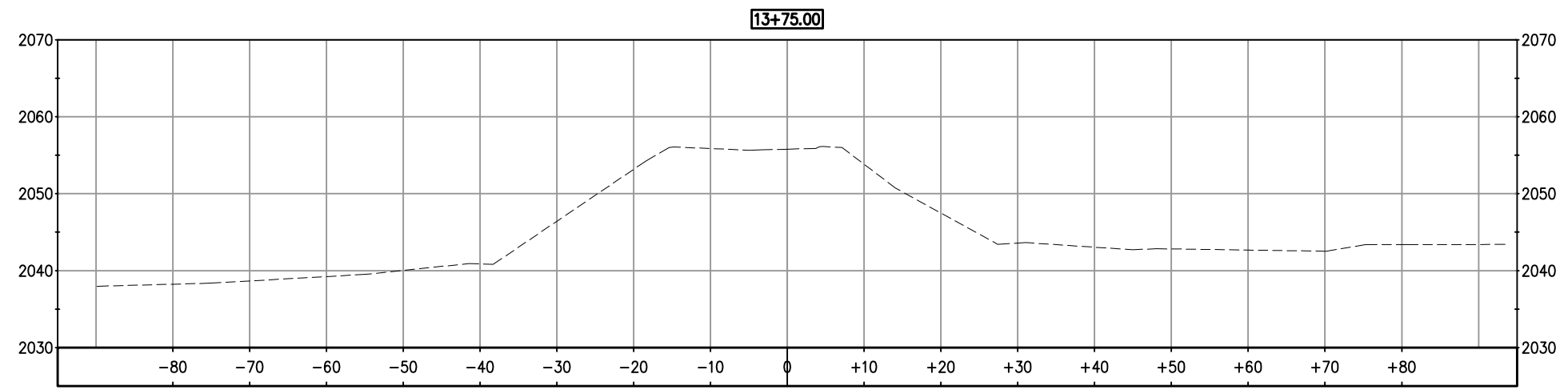
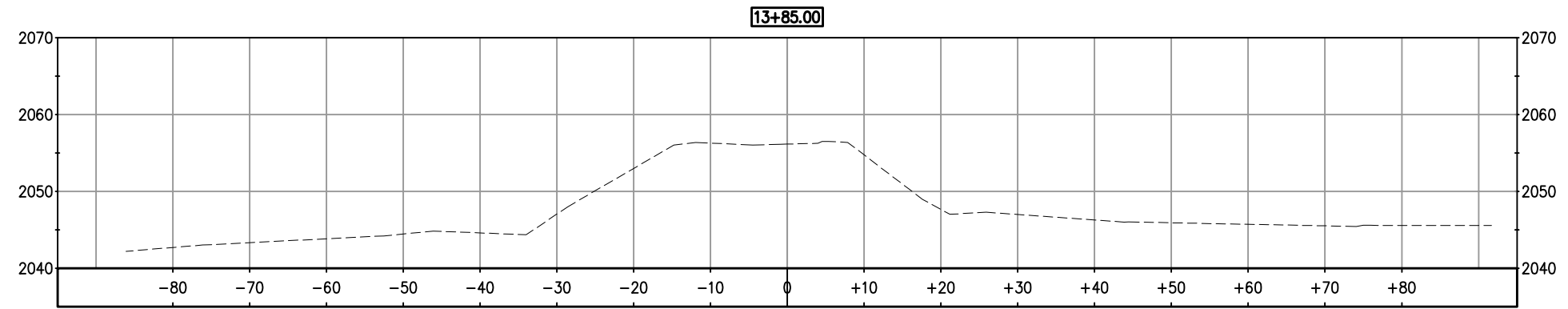

CROSS SECTIONS
 SCALE : 1" = 10' H,V

REVISION	NUMBER	DATE	DESCRIPTION	BY
	2	08/01/11	REVISIONS TO EXISTING GROUND AND DESIGN ELEVATIONS	SGM



PREPARED UNDER THE SUPERVISION OF :
Dwight G. Anderson
 REGISTERED CIVIL ENGINEER
 DATE: 07-12-11

DESIGNED: DA
 DRAWN: SGM
 CHECKED: DA
 DATE: 08/01/11
 ROAD NUMBER: -

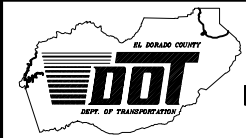

EL DORADO COUNTY
 DEPARTMENT OF TRANSPORTATION

EL DORADO TRAIL CULVERT
 REPLACEMENT

SHEET
 X-5R
 10 OF 10
 W.O. No. 99565

EXHIBIT A

**CONTRACTOR'S BID AND BID PRICE SCHEDULE
 CONTRACT NO. PW 11-30587, Project No. 99565
 EL DORADO TRAIL CULVERT REPLACEMENT**

Item No.	Item Code	Item Description	Unit of Measure	Estimated Quantity	Unit Price (In Figures)	Item Total (In Figures)
1	012973	Temporary Chain Link Gate (6' high)	LF	48		
2	071321	Temporary Fence (Type CL-6)	LF	80		
3	071325	Temporary Fence (Type ESA)	LF	400		
4	074017	Water Pollution Control	LS	1		
5	074020	Dust Control	LS	1		
6	120090	Construction Area Signs	LS	1		
7	A	Demolition of Existing Facilities	LS	1		
8	160101	Clearing & Grubbing	LS	1		
9	190185	Shoulder Backing	TON	136		
10	B	Trench and Excavation Safety	LS	1		
11	23001	Erosion Control	LS	1		
12	204022	Tree Replacement	LS	1		
13	390132	HMA (Type A) (overlay)	TON	229		
14	C	Trail Reconstruction	LS	1		
15	(F) 510053	Structural Concrete (headwalls)	CY	8		
16	(F) 520101	Bar Reinforcing Steel (headwall)	LB	380		
17	665052	54" Corrugated Steel Pipe (0.138" thick, aluminum-coated)	LF	156		
18	721009	Rock Slope Protection (Backing No.1 method B)	CY	6		
19	729010	Rock Slope Protection Fabric	SY	9		
20	731504	Minor Concrete (Channel)	CY	1		
21	800051	Fence Type WM, Metal Post	LF	200		
22	840582A	Paint Traffic Stripe (4" yellow)	LF	3150		
23	099999	Mobilization	LS	1		
Total Bid						\$

(F) Denotes Final Pay Item
 (LS) Denotes Lump Sum

**PROPOSAL PAY ITEMS AND BID PRICE SCHEDULE
CONTRACT NO. PW 11- 30587 PROJECT NO. 99565**

EL DORADO TRAIL CULVERT REPLACEMENT

Item No.	Item Code	Item Description	Unit of Measure	Estimated Quantity	Unit Price (In Figures)	Item Total (In Figures)
1	012973	Temporary Chain Link Gate (6' high)	LF	48		
2	071321	Temporary Fence (Type CL-6)	LF	80		
3	071325	Temporary Fence (Type ESA)	LF	400		
4	074017	Water Pollution Control	LS	1		
5	074020	Dust Control	LS	1		
6	120090	Construction Area Signs	LS	1		
7	A	Demolition of Existing Facilities	LS	1		
8	160101	Clearing & Grubbing	LS	1		
9	190185	Shoulder Backing	TON	136		
10	B	Trench and Excavation Safety	LS	1		
11	23001	Erosion Control	LS	1		
12	204022	Tree Replacement	LS	1		
13	390132	HMA (Type A) (overlay)	TON	229		
14	C	Trail Reconstruction	LS	1		
15	(F) 510053	Structural Concrete (headwalls)	CY	8		
16	(F) 520101	Bar Reinforcing Steel (headwall)	LB	380		
17	665052	54" Corrugated Steel Pipe (0.138" thick, aluminum-coated)	LF	156		
18	721009	Rock Slope Protection (Backing No.1 method B)	CY	6		
19	729010	Rock Slope Protection Fabric	SY	9		
20	731504	Minor Concrete (Channel)	CY	1		
21	800051	Fence Type WM, Metal Post	LF	200		
22	840582A	Paint Traffic Stripe (4" yellow)	LF	3150		
23	099999	Mobilization	LS	1		
Total Bid						\$

(F) Denotes Final Pay Item
(LS) Denotes Lump Sum

(NOTICE: Bidder's failure to execute the questionnaires and statements contained in this Proposal as required by applicable laws and regulations, or the determinations by El Dorado County based upon those questionnaires and statements, may prohibit award of the subject Contract to the Bidder.)