

GRADING AND IMPROVEMENT PLANS FOR
PROJECT #66114
GREEN VALLEY ROAD/DEER VALLEY ROAD TURN LANES
 EL DORADO COUNTY, CALIFORNIA
 TM 97-1330

SHEET INDEX

1. COVER SHEET
2. HORIZONTAL CONTROL PLAN
3. SECTIONS AND DETAILS
4. PLAN AND PROFILE-GREEN VALLEY STA. 242+00 TO 251+00
5. PLAN AND PROFILE-GREEN VALLEY STA. 251+00 TO 262+00
6. DEER VALLEY ROAD, DRAIN LATERAL GV1
7. EROSION CONTROL, STRIPING AND SIGNAGE PLAN
8. STAGE CONSTRUCTION PLAN - STAGE 1
9. STAGE CONSTRUCTION PLAN - STAGE 2
10. STAGE CONSTRUCTION PLAN - STAGE 2 (CONT.)
11. STAGE CONSTRUCTION PLAN - STAGE 3

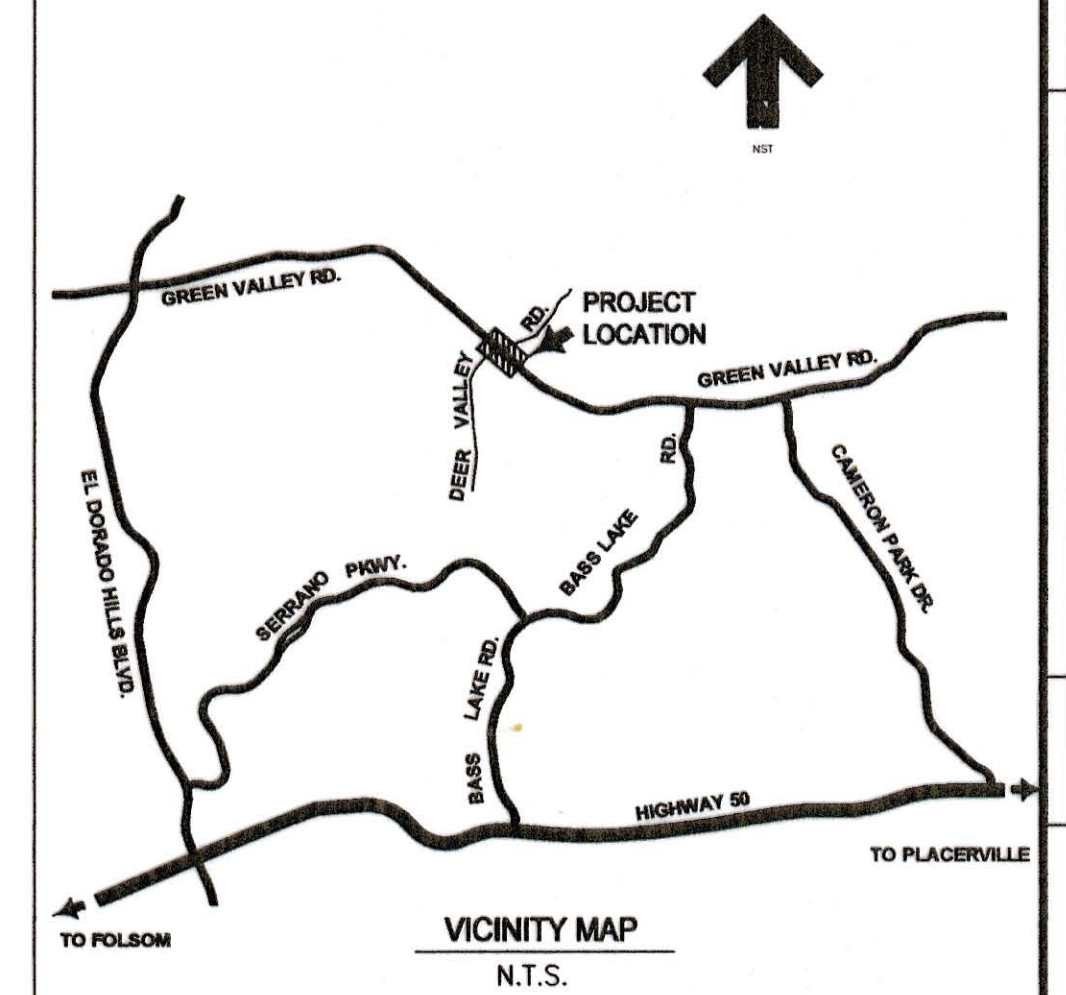
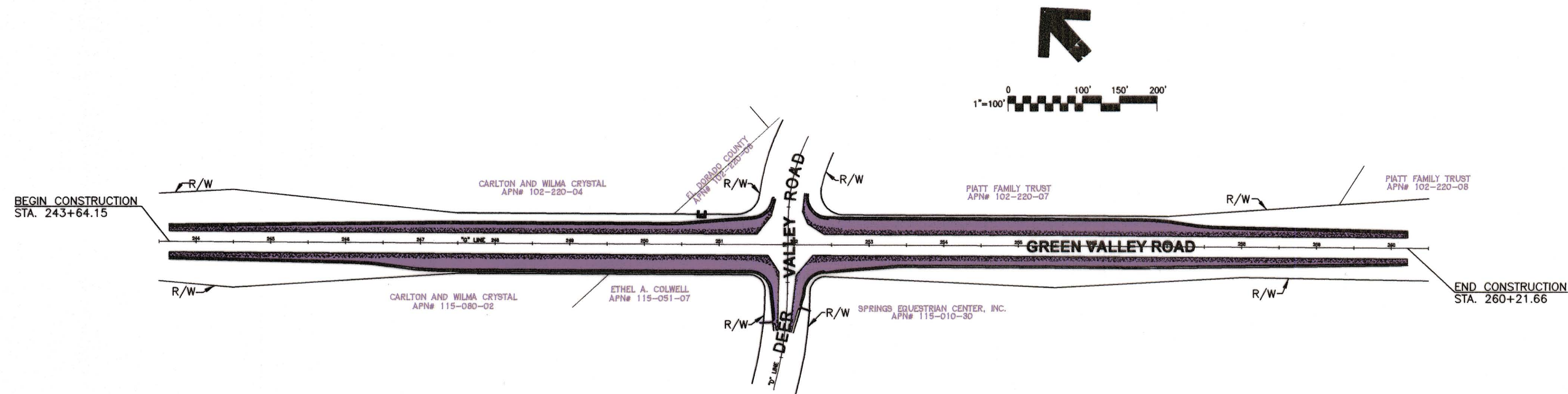

STANDARD GENERAL NOTES:

1. MATERIALS, CONSTRUCTION QUALITY AND METHODS FOR THIS PROJECT ARE SUBJECT TO THE COUNTY OF EL DORADO DESIGN AND IMPROVEMENT STANDARDS MANUAL, STANDARD PLANS, AND THE STATE OF CALIFORNIA DEPARTMENT OF TRANSPORTATION STANDARD PLANS DATED MAY 2006 AND STANDARD SPECIFICATIONS.
2. ALL REFERENCES TO THE STANDARD SPECIFICATION SHALL MEAN THAT STATE OF CALIFORNIA DEPARTMENT OF TRANSPORTATION STANDARD SPECIFICATIONS DATED MAY 2006.
3. CONTRACTOR TO VERIFY LOCATION OF ALL UTILITIES PRIOR TO CONSTRUCTION.
4. THE CONTRACTOR SHALL POSSESS THE CLASS (OR CLASSES) OF LICENSE AS SPECIFIED IN THE "NOTICE TO BIDDERS".

SITE PLAN

RECORD DRAWING CERTIFICATE

THIS SET OF PLANS, HAVING BEEN REVIEWED BY ME, REFLECT ALL APPROVED REVISIONS TO THE PROJECT KNOWN TO ME, AND ALL FIELD DEVIATIONS TO THE PLANNED IMPROVEMENTS BY THE CONSTRUCTION CONTRACTOR, AS REPORTED TO ME AS OF _____. IT DOES NOT REPRESENT FIELD VERIFICATION OF PLANNED IMPROVEMENTS BY ME. MONUMENTS HAVE BEEN FOUND OR SET AT ALL BC'S, EC'S AND ANGLE POINTS IN THE RIGHT-OF-WAY (OR ALONG CENTERLINE IN THE MONUMENT WELLS) BY A LICENSED LAND SURVEYOR, AND AN APPROPRIATE MAP FILED IN ACCORDANCE WITH THE LAND SURVEYOR'S ACT.

ENGINEER _____ RCE# _____ DATE _____

GRADING AND GEOTECHNICAL SPECIFICATIONS

ALL GRADING SHALL BE DONE UNDER OBSERVATION AND TESTING BY A QUALIFIED CIVIL ENGINEER OR GEOTECHNICAL ENGINEER, AND IF REQUIRED, BOTH A QUALIFIED CIVIL ENGINEER OR GEOTECHNICAL ENGINEER AND AN ENGINEERING GEOLOGIST. ALL GRADING MUST BE PERFORMED IN ACCORDANCE WITH APPLICABLE COUNTY ORDINANCES AND THE RECOMMENDATIONS AND SPECIFICATIONS SET FORTH IN THE SOILS REPORT OR GEOLOGICAL/GEOTECHNICAL INVESTIGATION

ENTITLED: GEOTECHNICAL REPORT SILVER SPRINGS RESIDENTIAL DEVELOPMENT AND OFFSITE IMPROVEMENTS. PROJECT NO. 7125.5.001.01; ENGED INCORPORATED; FEBRUARY 1, 2006

AT COMPLETION OF THE GRADING OPERATIONS, AN AS-GRADED SOILS, OR IF REQUIRED, AN AS-GRADED SOILS AND GEOLOGICAL REPORT WILL BE PREPARED. ONE COPY OF THE AS-GRADED REPORT WILL BE SUBMITTED TO EACH, THE DOT INSPECTOR, AND DOT EL DORADO HILLS DIVISION.

GEOTECHNICAL ENGINEER'S STATEMENT

THESE GRADING PLANS HAVE BEEN REVIEWED BY THE UNDERSIGNED AND FOUND TO BE IN GENERAL CONFORMANCE WITH THE RECOMMENDATIONS AND SPECIFICATIONS OUTLINED IN THE REFERENCE SOILS OR GEOLOGICAL/GEOTECHNICAL INVESTIGATION PREPARED FOR THIS DEVELOPMENT BY ENGED INCORPORATED; 2213 PLAZA DRIVE, ROCKLIN, CA; (916) 786-8883.

CEG# _____ DATE _____ EXPIRES _____

Mark M. Gilbert
 RCE# GE 2191 DATE 3-15-11 EXPIRES 3/31/12

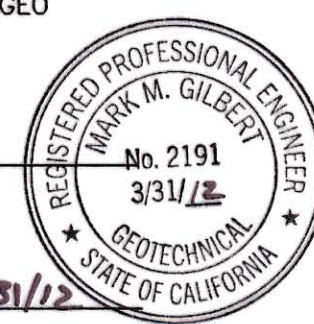

EXISTING	LEGEND	NEW
++	STREET SIGN	✖
∩	STOP SIGN	∩
∩	WOOD POLE	∩
---	CENTERLINE	---
---	FLOWLINE	---
---	TOP OF CUT SLOPE	---C---
---	TOE OF FILL SLOPE	---F---
	NEW AC SECTION	■
	PAVEMENT TO BE REMOVED AND REPLACED	■
✖	MONUMENT	✖
---	GAS	---
---	UNDERGROUND ELECTRIC	---
---	OVERHEAD ELECTRIC	---
---	FENCE	---
---	BIKE LANE SYMBOL	---
---	FIBER ROLL	---

ABBREVIATIONS:

AB	AGGREGATE BASE	EX	EXISTING	PRC	POINT OF REVERSE CURVE
AC	ASPHALT CONCRETE PAVEMENT	FOC	FACE OF CURB	PT	POINT
AE	ACCESS EASEMENT	FG	FINISH GROUND	RCP	RADIUS
BB	BEGINNING OF BRIDGE	FF	FINISH FLOOR	RT	REINFORCED CONCRETE PIPE
BC	BEGIN HORIZONTAL CURVE	FH	FIRE HYDRANT	R/W	RIGHT
BCR	BEGIN CURB RETURN	FL	FLOW LINE	R/W	RIGHT OF WAY
BEG	BEGIN	FS	FINISH SURFACE	SC	SUB GRADE
BF	BOTTOM OF FOOTING	GB	GRADE BREAK	SHLD	SHOULDER
BM	BENCHMARK	GFL	GUTTER FLOWLINE	SHT	SHEET
BFC	BOTTOM FACE OF CURB	GR	GRATE	SS	SLOPE STAKE
BVC	BEGIN VERTICAL CURVE	HP	HINGE POINT	SS	STATION
BW	TOE OF WALL FOOTING	HWY	HIGHWAY	SW	SIDEWALK
CIP	CAST IRON PIPE	INV	INVERT	T	TANGENT
CL	CENTERLINE	INTX	INTERSECTION	TBC	TOP BACK OF CURB
CMP	CORRUGATED METAL PIPE	JP	JOINT POLE	TBW	TOP BACK OF WALK
CONST	CONSTRUCT	LF	LINEAL FEET	TC	TOP OF CURB
CR	CURVE RETURN	LQ	LAYOUT LINE	TF	TOP OF FOOTING
CT	COURT	LT	LEFT	TG	TOP OF GRATE
DI	DROP INLET	MAX	MAXIMUM	TP	TOE OF SLOPE
DIP	DUCTILE IRON PIPE	MGR	METAL BEAM GUARD RAIL	TP	TELEPHONE POLE
DOM	DOMESTIC	MIN	MINIMUM	TS	TOP OF SLOPE
DWY	DRIVEWAY	MH	MANHOLE	TW	TOP OF WALL
EA	EACH	N	NORTH	TYP	TYPICAL
EASE	EASEMENT	NG	NOT GRADED	VB	VALVE BOX
EB	END OF BRIDGE OR EASTBOUND	OG	ORIGINAL GROUND	VC	VERTICAL CURVE
EC	END HORIZONTAL CURVE	OH	OVERHEAD	VERT	VERTICAL
ECR	END CURB RETURN	PB	PULL BOX	WM	WIRE MESH
EID	EL DORADO IRRIGATION DISTRICT	PC	POINT OF CURVATURE	WSP	WELDED STEEL PIPE
ELEV	ELEVATION	PCC	POINT OF COMPOUND CURVE		
EP	EDGE OF PAVEMENT	PCC	PORTLAND CEMENT CONCRETE		
ES	EDGE OF SHOULDER	PCVC	POINT OF COMPOUND VERTICAL CURVE		
ETW	EDGE OF TRAVELED WAY	PI	POINT OF INTERSECTION		
EVC	END VERTICAL CURVE	PL	PROPERTY LINE		
		PP	POWER POLE		

BENCH MARK: ELEV=1056.32
 ALL ELEVATIONS ARE IN FEET. BENCHMARK IS A 2" CAPPED IRON PIPE MARKED ED. CO. DPW., 40.00, 2+59, 1976 SET ALONG THE SOUTHERLY LINE OF DEER VALLEY ROAD.

APPROVED BY:

John R. Schmitt
 JOHN R. SCHMITT, CHAIR, BOARD OF SUPERVISORS
 DATE 5-14-13
 Board date 10-30-12

UTILITY REPRESENTATIVES

UTILITY	REPRESENTATIVE	TELEPHONE
GAS PG&E	JENNIFER DONOVAN	(530) 621-7228
ELECTRICITY PG&E	JENNIFER DONOVAN	(530) 621-7228
TELEPHONE AT&T	ASTRID WILLIAMS	(530) 668-2631
WATER E.I.D.	MARC MACKAY	(530) 642-4034
SEWER E.I.D.	MARC MACKAY	(530) 642-4034
DRAINAGE EL DORADO COUNTY	SEE COUNTY INSPECTOR	
USA	USA	(800) 642-2444
FIRE RESCUE FIRE PROTECTION DISTRICT	GUY DELANEY	(530) 677-1868
CABLE TV COMCAST	KIP MILLER	off.(916)376-7783 cell(650)444-5865

PERMITS

PERMIT	NUMBER	DATE
ENVIRONMENTAL IMPACT REPORT or NEGATIVE DECLARATION	Schng72121	JUNE 1998
AREA OF DISTURBANCE	4.82 -2-2-	ACRES
WDD NUMBER FOR RECEIPT OF SWPPP/NOI	5509C31187	SEPT 2011
	5509C333965	JULY 2008

COUNTY OF EL DORADO IMPROVEMENT PLAN APPROVAL

Matthew D. Smeltzer
 MATTHEW D. SMELTZER, PE
 COUNTY ENGINEER
 DEPARTMENT OF TRANSPORTATION
 COUNTY OF EL DORADO
 RCE #056882
 DATE 5/1/13

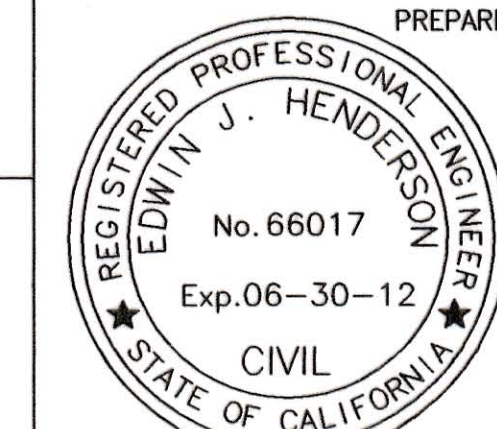

PREPARED UNDER THE SUPERVISION OF:
Edwin J. Henderson
 EDWIN J. HENDERSON
 No. 66017
 Exp. 06-30-12
 DATE 3/15/11

OWNER INFORMATION
 SILVER SPRINGS LLC
 2999 OAK ROAD, SUITE 400
 WALNUT CREEK, CA 94597
 (925) 833-1405
 ENGINEERING & PLANNING
 1000 BETHENA ROAD, SUITE 100
 ROCKLIN, CA 95686
 APPROVED BY: _____
 REVISION: _____
 PROJECT #66114
 GREEN VALLEY ROAD/DEER VALLEY ROAD TURN LANES
 COVER SHEET
 EL DORADO COUNTY TM 97-1330, COUNTY CONTRACT NO. PW 09-30470
 SHEET 1 OF 11

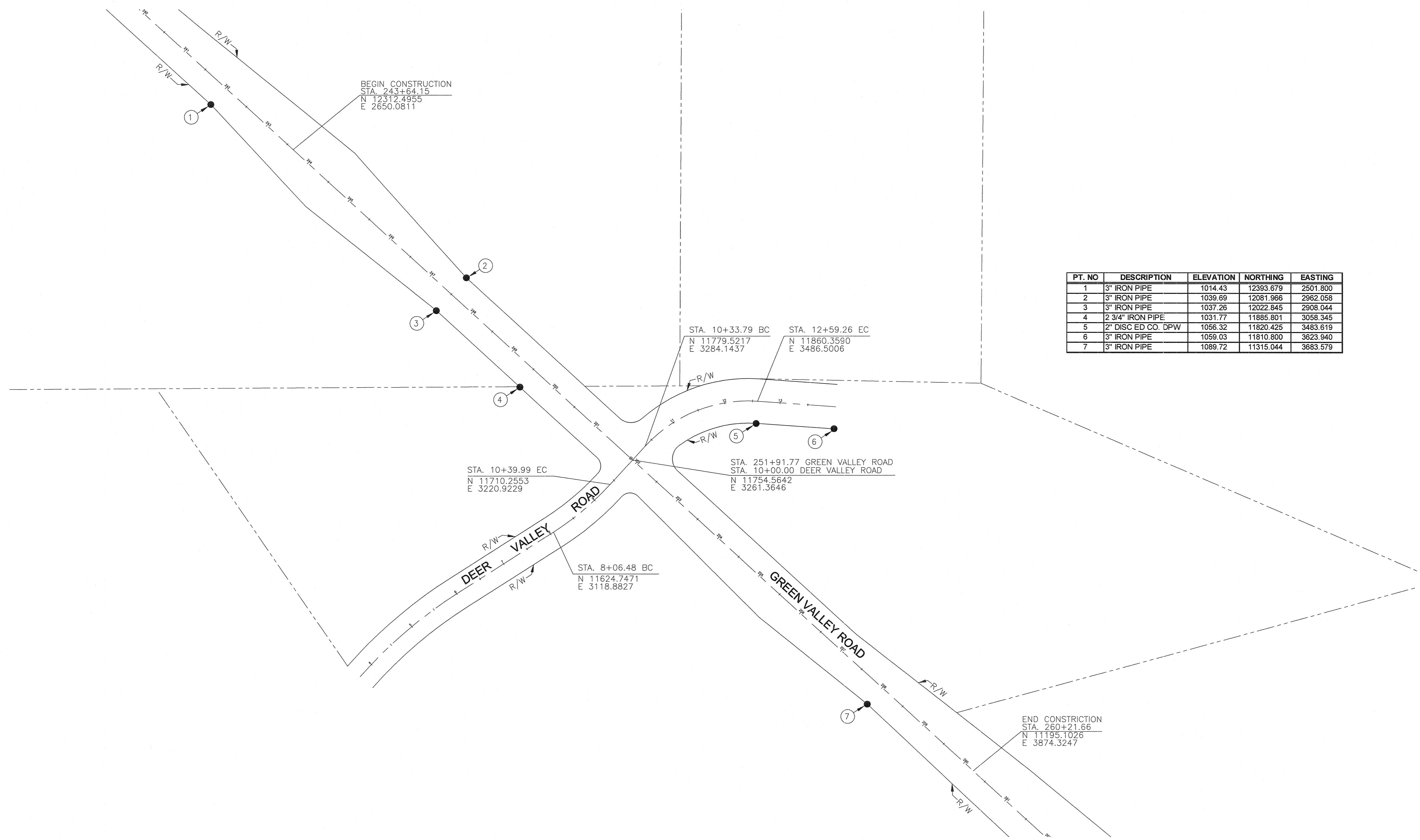
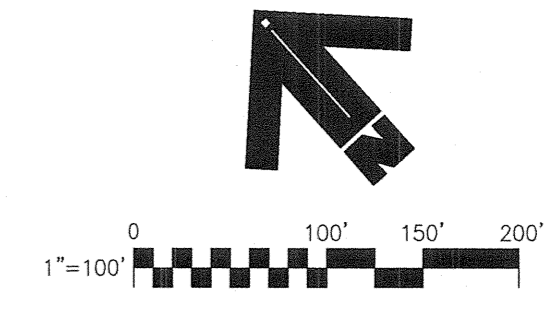

PT. NO	DESCRIPTION	ELEVATION	NORTHING	EASTING
1	3" IRON PIPE	1014.43	12393.679	2501.800
2	3" IRON PIPE	1039.69	12081.966	2962.058
3	3" IRON PIPE	1037.26	12022.845	2908.044
4	2 3/4" IRON PIPE	1031.77	11885.801	3058.345
5	2" DISC ED CO. DPW	1066.32	11820.425	3483.619
6	3" IRON PIPE	1059.03	11810.800	3623.940
7	3" IRON PIPE	1089.72	11315.044	3683.579

HORIZONTAL CONTROL DIAGRAM

SHEET 2 OF 11
 PROJECT #66114
 GREEN VALLEY ROAD/DEER VALLEY ROAD TURN LANES
 HORIZONTAL CONTROL PLAN
 COUNTY CONTRACT NO. PW 09-30470
 EL DORADO COUNTY, CALIFORNIA

OWNER INFORMATION
 SILVER SPRINGS, LLC
 2999 OAK ROAD, SUITE 400
 WALNUT CREEK, CA 94597
 (925) 933-1405

ENGINEERING & PLANNING
 TLA
 116 8th Street
 Berkeley, CA 94704

REVISION	APPROVED BY	DATE

TLA
 ENGINEERING & PLANNING

 DATE: 4.4.11

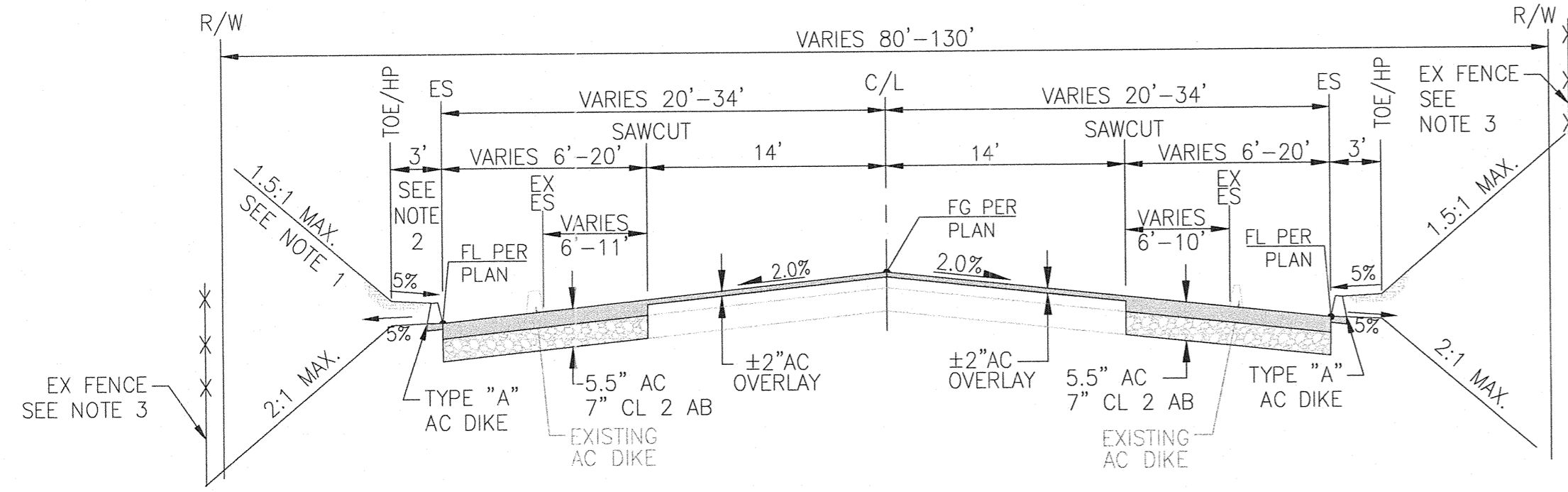

- NOTES:
1. INCREASE LEFT CUT SLOPE TO 1:1 BETWEEN STA 246+50 AND 248+00.
 2. REDUCE 3' BENCH WIDTH FROM STATION 258+75 TO 260+21.66 AS NECESSARY TO AVOID CUTTING EXISTING SLOPE (SEE SHEET 5).
 3. SEE SHEETS 4 & 5 FOR EXISTING AND PROPOSED FENCE LOCATIONS.

**GREEN VALLEY ROAD
STA. 243+64.15 TO 260+21.66**

SCALE: N.T.S.

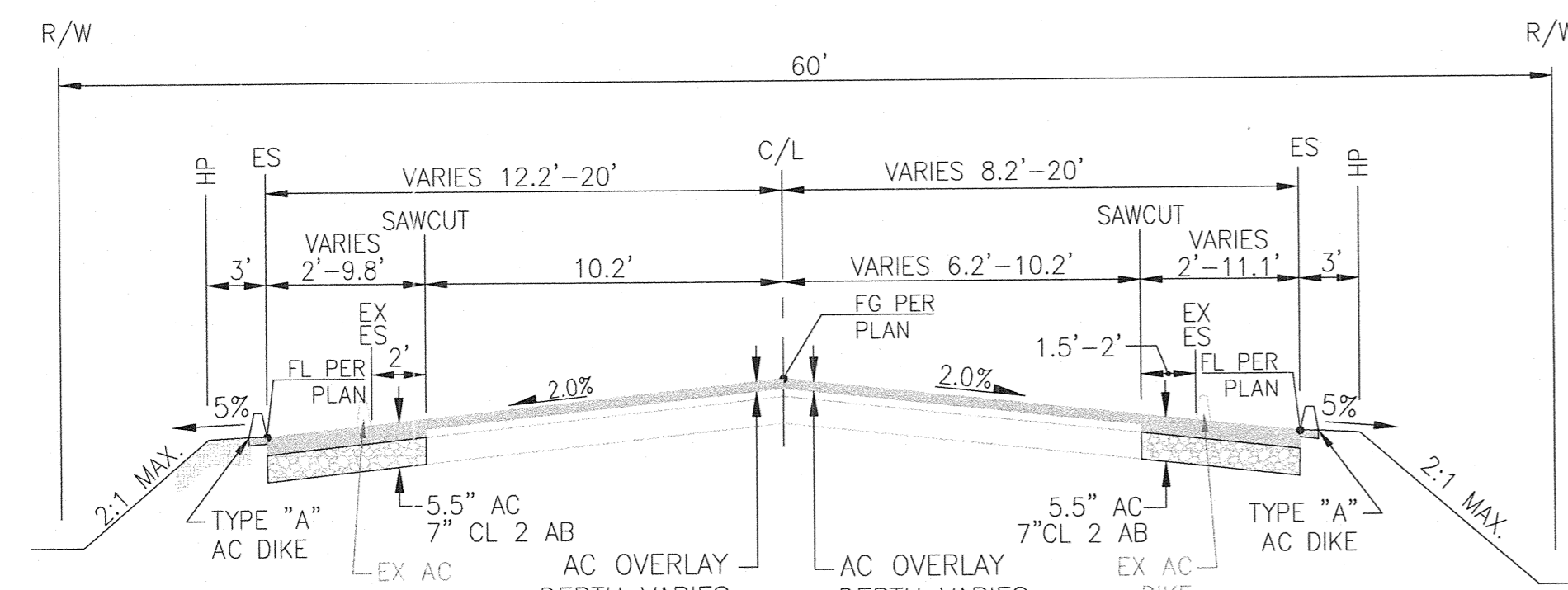

**DEER VALLEY ROAD
STA. 8+85 TO 10+00**

SCALE: N.T.S.

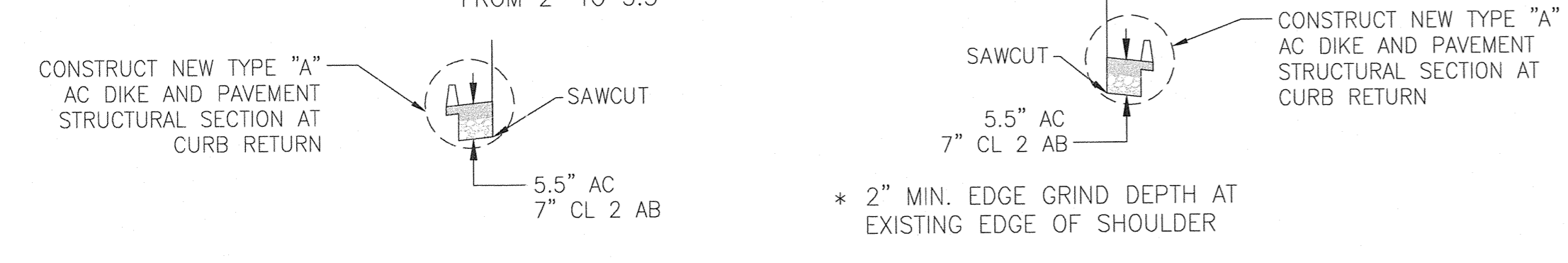
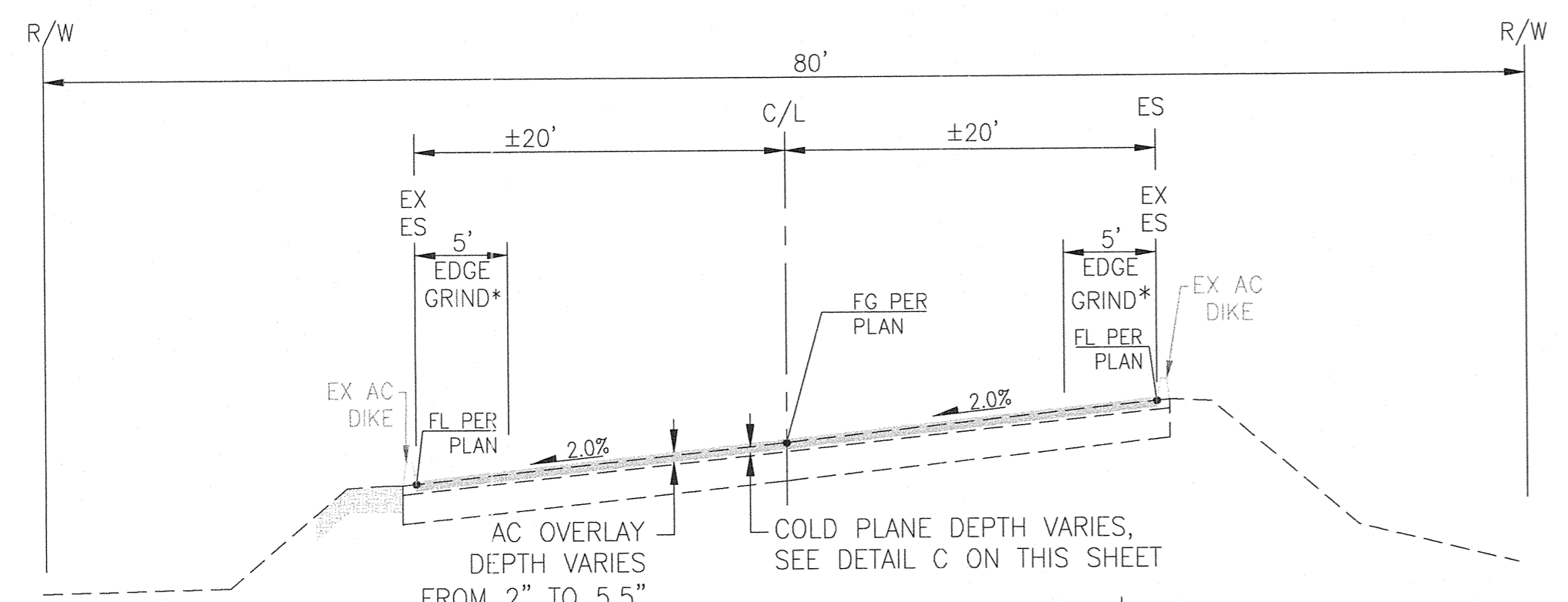

**DEER VALLEY ROAD
STA. 10+00 TO 10+90**

SCALE: N.T.S.

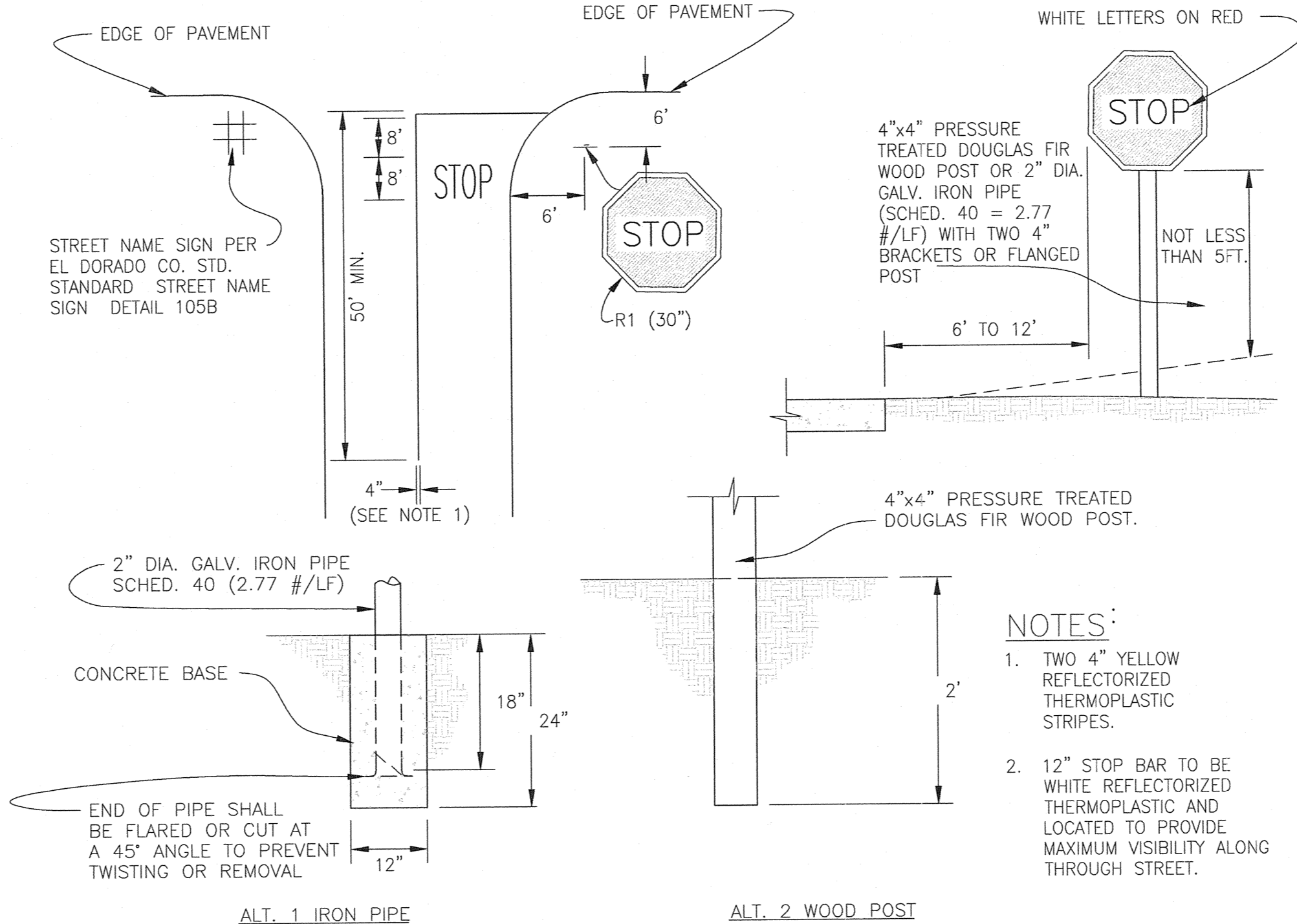

STOP SIGN ALTERNATE BASE

SCALE: N.T.S.

- NOTES:
1. TWO 4" YELLOW REFLECTORIZED THERMOPLASTIC STRIPES.
 2. 12" STOP BAR TO BE WHITE REFLECTORIZED THERMOPLASTIC AND LOCATED TO PROVIDE MAXIMUM VISIBILITY ALONG THROUGH STREET.

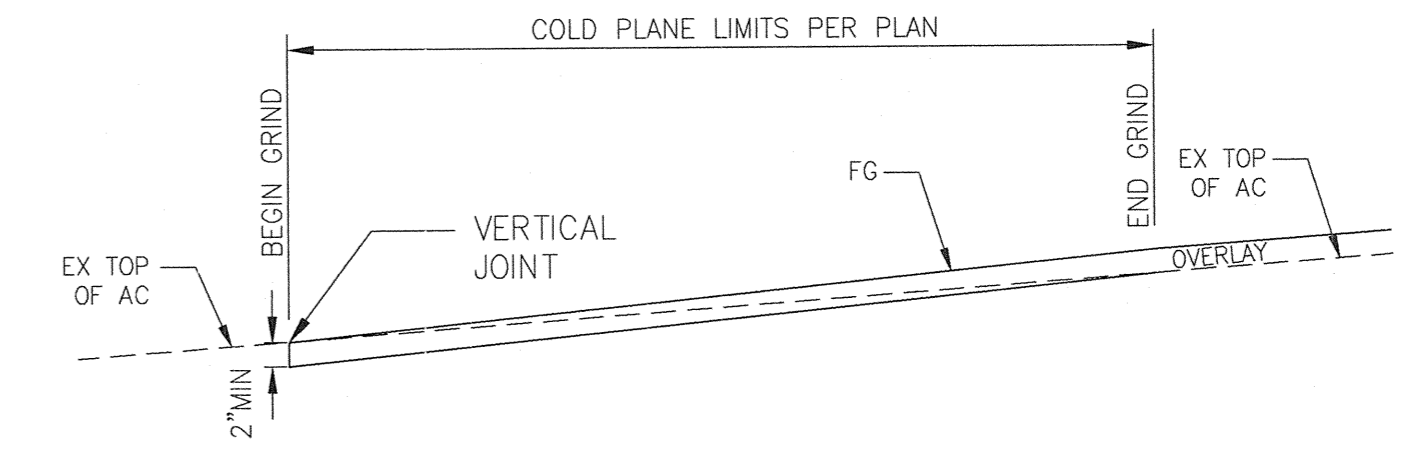

PAVEMENT COLD PLANE TAPER DETAIL

SCALE: N.T.S.

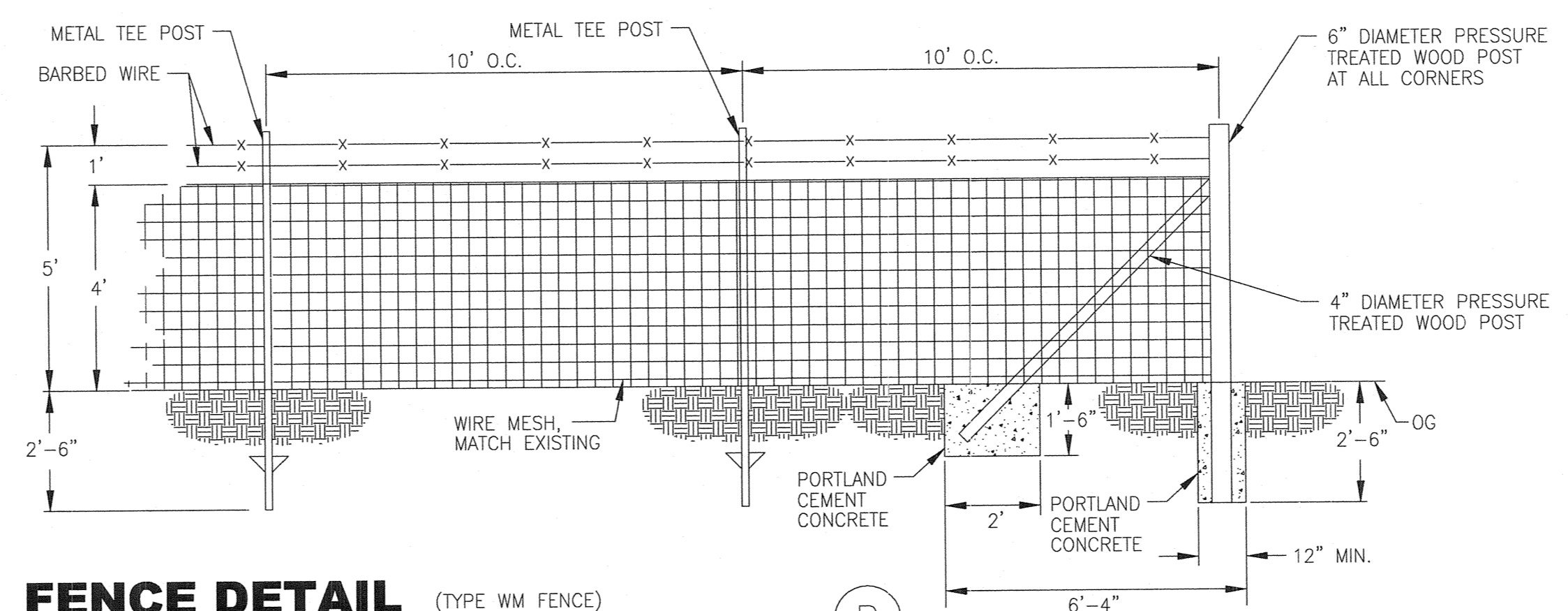

FENCE DETAIL (TYPE WM FENCE)

SCALE: N.T.S.

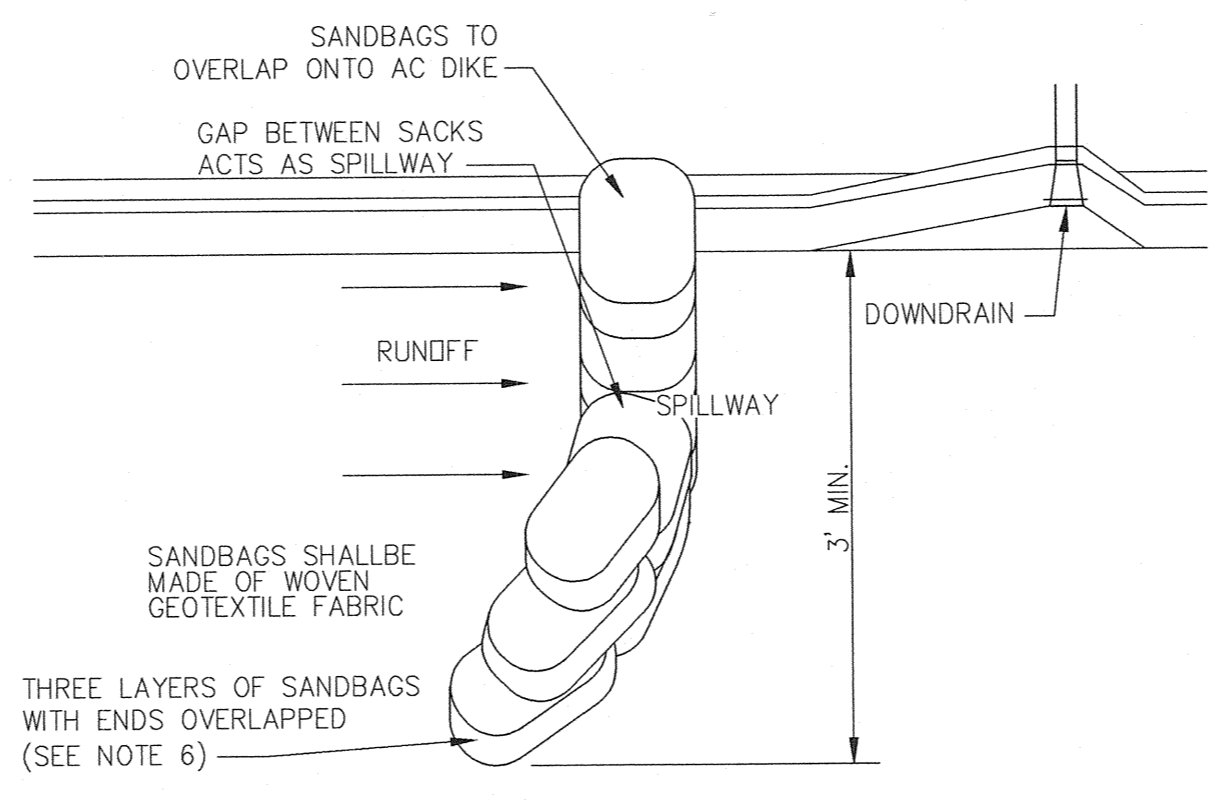

INLET SEDIMENT BARRIER (SANDBAG TYPE)

SCALE: N.T.S.

- NOTES:
1. CONSTRUCT ON GENTLY SLOPING STREETS WHERE WATER CAN POND AND ALLOW SEDIMENT TO SEPARATE OUT OF SUSPENSION AS SHOWN ON THE PLANS AND SWPPP, AS DIRECTED BY THE ENGINEER.
 2. PLACE SEVERAL LAYERS OF SANDBAGS OVER THE FIRST, OVERLAPPING BAGS AND PACK THEM TIGHTLY TOGETHER TO MINIMIZE THE SPACE BETWEEN BAGS.
 3. LEAVE A GAP OF ONE SACK IN THE MIDDLE OF THE TOP ROW OF SACKS TO SERVE AS THE SPILLWAY. SPILLWAY HEIGHT SHALL BE LOWER THAN CURB HEIGHT AND SUFFICIENT SIZE TO PASS FLOWS FROM SEVERE STORM EVENT.
 4. INSPECT AND REPAIR BARRIER AFTER EACH STORM EVENT AND AS DIRECTED BY THE ENGINEER. REMOVE SEDIMENT WHEN IT REACHES TOP OF SPILLWAY (CURB HEIGHT).
 5. SEDIMENT SHALL BE DEPOSITED IN AN AREA TRIBUTARY TO A SEDIMENT BASIN OR OTHER PROTECTIVE MEASURE AND WILL NOT ENTER STORM DRAIN.
 6. SEDIMENT AND GRAVEL SHALL BE IMMEDIATELY REMOVED FROM TRAVELED WAY OF ROAD.
 7. SANDBAGS SACKS SHALL BE FILLED WITH 3/4" DRAIN ROCK OR 1/4" PEA GRAVEL.

TLA ENGINEERING & PLANNING

REGISTERED PROFESSIONAL ENGINEER
EDWIN J. HENDERSON
No. 66017
Exp. 06-30-12
STATE OF CALIFORNIA

DATE: 4.4.11

OWNER INFORMATION	SILVER SPRINGS LLC 2999 OAK ROAD SUITE 400 WALNUT CREEK, CA 94697 (925) 933-1405
PROJECT #66114	GREEN VALLEY ROAD/DEER VALLEY ROAD TURN LANES
SECTIONS AND DETAILS	
EL DORADO COUNTY	TM 97-1330, COUNTY CONTRACT NO. PW 09-30470
SHEET	3
3 OF 11	

CARLTON AND WILMA CRYSTAL
APN# 102-220-04

CURVE TABLE							
CURVE	LENGTH	RADIUS	TANGENT	DELTA	1/4 PT	1/2 PT	3/4 PT
C3	41.71	30.00	25.02	79°39'58"	1050.51	1051.26	1051.77
C4	51.20	30.00	34.38	97°46'44"	1052.86	1053.84	1055.06
C5	47.39	30.00	30.27	90°30'36"	1050.12	1050.42	1050.48
C6	44.52	30.00	27.50	85°01'07"	1051.13	1053.05	1054.87
C7	1.51	520.00	0.75	0°09'59"			
C8	60.28	361.36	30.21	9°33'27"			
C9	60.28	361.31	30.21	9°33'32"			

TLA
ENGINEERING & PLANNING

REGISTERED PROFESSIONAL ENGINEER
EDWIN J. HENDERSON
No. 66017
Exp. 06-30-12
CIVIL
STATE OF CALIFORNIA

DATE: 11/11/11

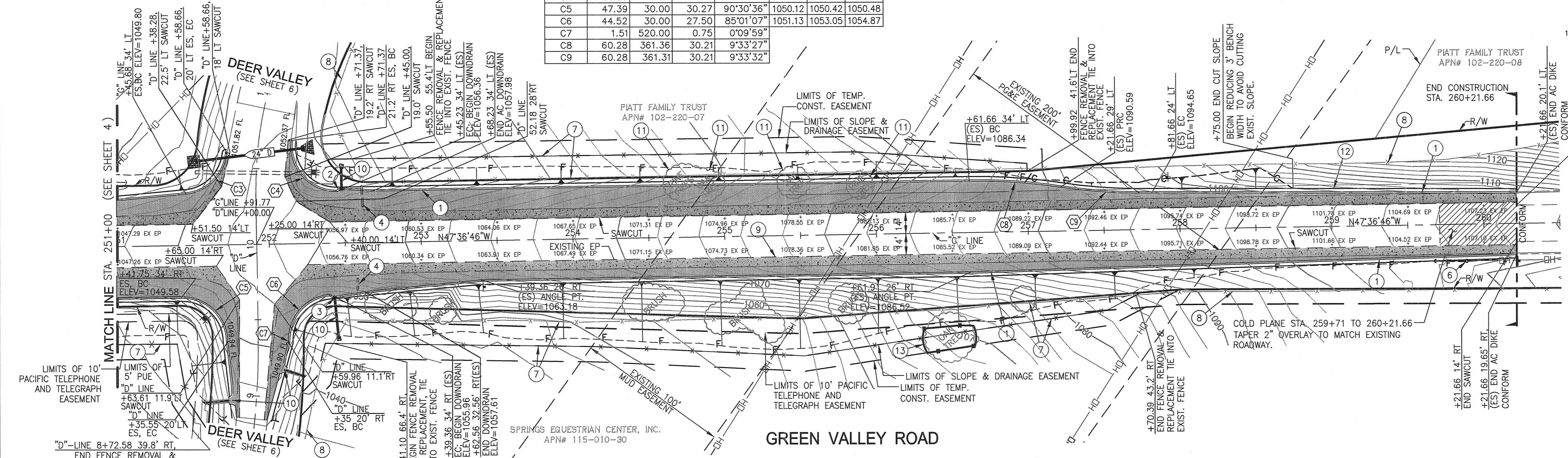
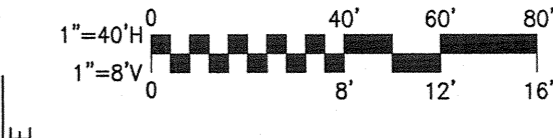

- CONSTRUCTION NOTES:**
- CONSTRUCT TYPE "A" A.C. DIKE PER CALTRANS STANDARD PLAN A87B.
 - CONSTRUCT A.C. DIKE FOR DOWNDRAIN AND PLACE 15' OF 12" CSP DOWNDRAIN PER CALTRANS STD. PLAN D87A (WITH L=20') FL(N)=1056.74 FL (OUT)=1050.40
 - CONSTRUCT A.C. DIKE FOR DOWNDRAIN AND PLACE 30' OF 12" CSP DOWNDRAIN PER CALTRANS STD. PLAN D87A (WITH L=20') FL(N)=1055.50 FL (OUT)=1043.00
 - REMOVE EXISTING DOWNDRAINS
 - BLANK INTENTIONALLY
 - EXISTING UTILITY POLE TO REMAIN.
 - REMOVE EXISTING FENCE AND CONSTRUCT FENCE PER DETAIL B ON SHEET 3 AT RIGHT-OF-WAY OR SLOPE EASEMENT AS SHOWN.
 - EXISTING FENCE TO REMAIN.
 - SAWCUT EXISTING AC AND REPLACE PER TYPICAL SECTION (SHEET 3). CUT NEAT STRAIGHT LINE.
 - SEE DRAIN LATERALS ON SHEET 7 FOR CONSTRUCTION NOTES.
 - REMOVE EXISTING TREE (5 TOTAL FOR THIS SHEET).
 - COUNTY TO REMOVE & SALVAGE EX. FLASHING BEACON & SIGN DURING CONSTRUCTION
 - EXISTING OAK TREE TO REMAIN, INSTALL TEMPORARY FENCE (TYPE ESA).

STATION	LEFT FLOWLINE	RIGHT FLOWLINE	PROP. C/L GRADES	EXIST. C/L GRADES
1047.7	1047.88	1047.20	1047.28	
1049.30	1048.62	1048.65	1048.65	
1050.28	1049.58	1049.80	1049.80	
1050.48			1050.48	
1050.6			1050.73	
1052.31			1052.31	
1053.8			1053.94	
1055.64			1055.64	
1056.64			1055.96	1056.11
1057.04			1057.04	
1057.2			1057.37	1056.69
1059.14			1058.52	1058.46
1060.91			1060.33	1060.23
1062.68			1062.14	1062.00
1064.45			1063.93	1063.77
1066.26			1065.74	1065.58
1067.9			1068.07	1067.39
1069.88			1069.36	1069.20
1071.6			1071.70	1071.18
1073.51			1072.99	1072.83
1075.2			1075.32	1074.80
1077.13			1076.61	1076.45
1078.8			1078.94	1078.42
1080.75			1080.23	1080.07
1082.4			1082.57	1082.05
1084.38			1083.86	1083.70
1086.0			1086.19	1085.67
1087.97			1087.45	1087.29
1089.5			1089.71	1089.07
1091.39			1090.89	1090.82
1092.9			1093.06	1092.57
1094.70			1094.22	1094.22
1096.2			1096.32	1095.85
1097.88			1097.41	1097.41
1099.2			1099.37	1098.91
1100.82			1100.37	1100.37
1102.1			1102.27	1101.83
1103.72			1103.29	1103.29
1105.0			1105.16	1104.74
1106.25			1105.83	1105.83
1106.44			1106.02	1106.02
1107.6			1107.65	1107.24
1108.7			1108.3	1108.3
1109.3			1109.3	1109.4
1110.1			1110.1	1110.1

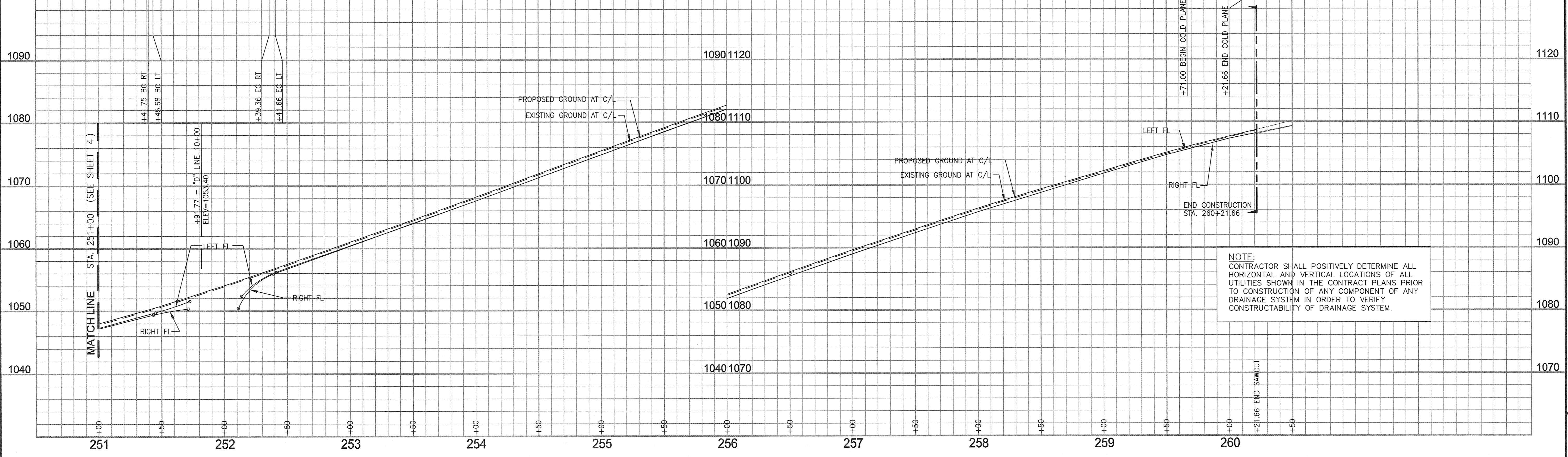

NOTE:
CONTRACTOR SHALL POSITIVELY DETERMINE ALL HORIZONTAL AND VERTICAL LOCATIONS OF ALL UTILITIES SHOWN IN THE CONTRACT PLANS PRIOR TO CONSTRUCTION OF ANY COMPONENT OF ANY DRAINAGE SYSTEM IN ORDER TO VERIFY CONSTRUCTABILITY OF DRAINAGE SYSTEM.

OWNER INFORMATION
SILVER SPRINGS LLC
2898 OAK ROAD, SUITE 400
WALNUT CREEK, CA 94587
(925) 933-1405

PROJECT #66114
GREEN VALLEY ROAD/DEER VALLEY ROAD TURN LANES
PLAN AND PROFILE FROM STA. 251+00 TO 260+00
TM 97-1330, COUNTY CONTRACT NO. PW 09-30470

5 OF 11

MARKER - CULVERT			
LOCATION	DETAIL	STD. PLAN	MILE POST
"G"-LINE STA 249+90 RT	DETAIL A, THIS SHEET	A73B	4.76
"G"-LINE STA 250+35 LT	DETAIL A, THIS SHEET	A73B	4.76
"D"-LINE STA 10+65 RT	DETAIL A, THIS SHEET	A73B	0.01
"D"-LINE STA 10+55 LT	DETAIL A, THIS SHEET	A73B	0.01

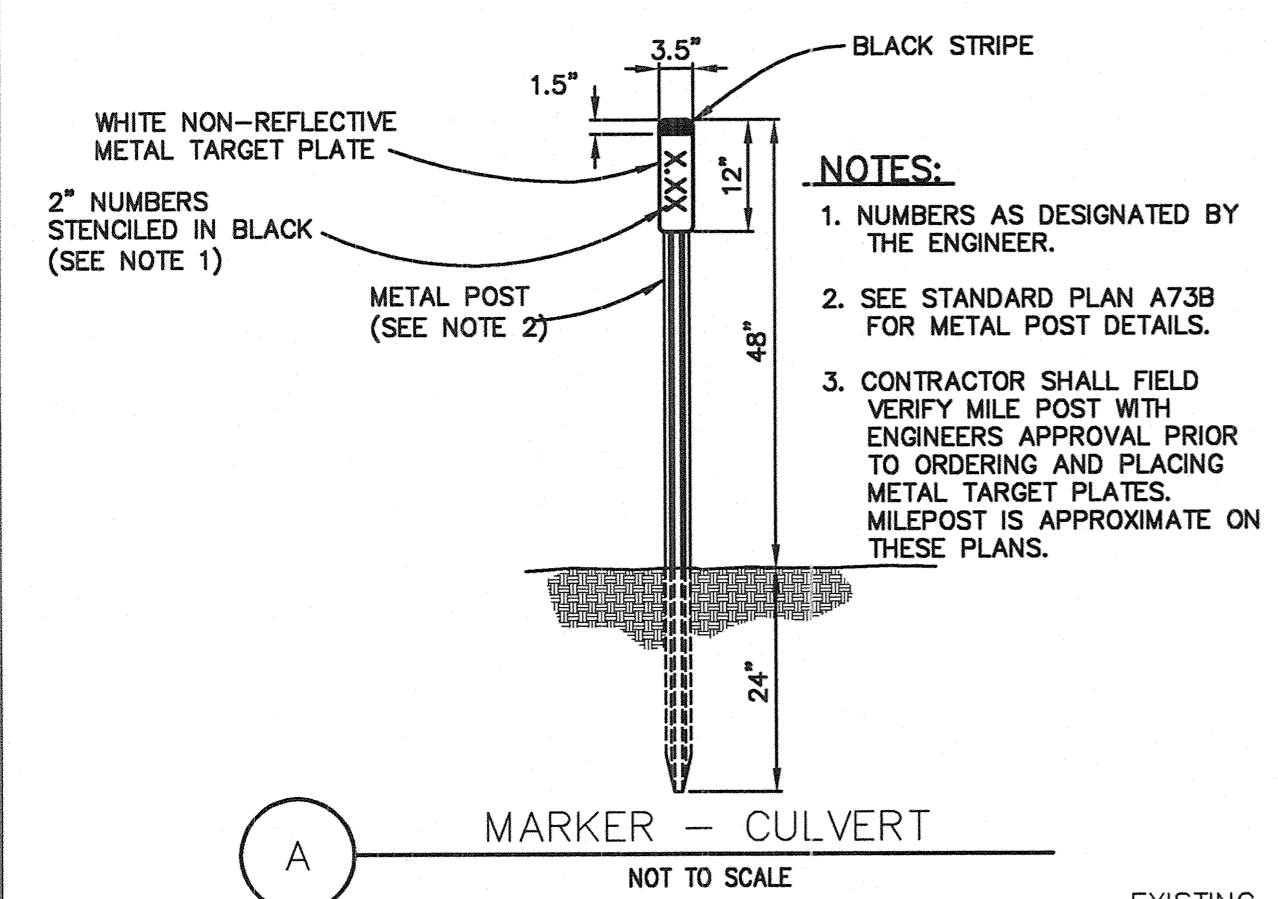
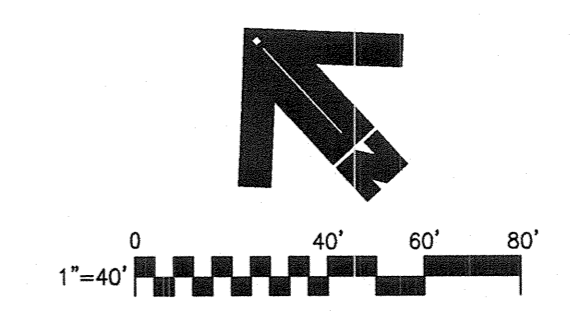

- NOTES:**
- NUMBERS AS DESIGNATED BY THE ENGINEER.
 - SEE STANDARD PLAN A73B FOR METAL POST DETAILS.
 - CONTRACTOR SHALL FIELD VERIFY MILE POST WITH ENGINEERS APPROVAL PRIOR TO ORDERING AND PLACING METAL TARGET PLATES. MILEPOST IS APPROXIMATE ON THESE PLANS.

(A) MARKER - CULVERT
NOT TO SCALE

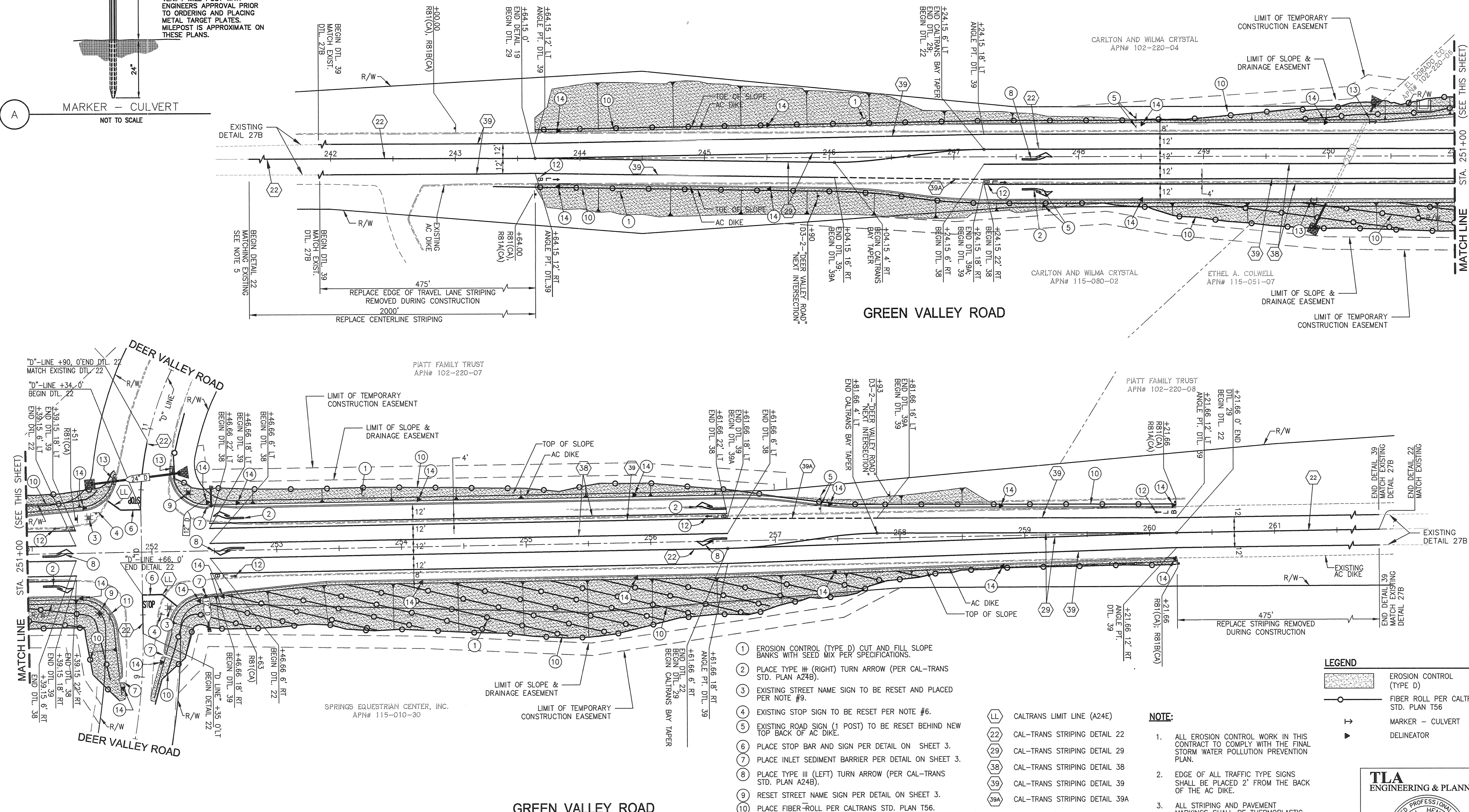

- EROSION CONTROL (TYPE D) CUT AND FILL SLOPE BANKS WITH SEED MIX PER SPECIFICATIONS.
- PLACE TYPE III (RIGHT) TURN ARROW (PER CAL-TRANS STD. PLAN A24B).
- EXISTING STREET NAME SIGN TO BE RESET AND PLACED PER NOTE #9.
- EXISTING STOP SIGN TO BE RESET PER NOTE #6.
- EXISTING ROAD SIGN (1 POST) TO BE RESET BEHIND NEW TOP BACK OF AC DIKE.
- PLACE STOP BAR AND SIGN PER DETAIL ON SHEET 3.
- PLACE INLET SEDIMENT BARRIER PER DETAIL ON SHEET 3.
- PLACE TYPE III (LEFT) TURN ARROW (PER CAL-TRANS STD. PLAN A24B).
- RESET STREET NAME SIGN PER DETAIL ON SHEET 3.
- PLACE FIBER-ROLL PER CALTRANS STD. PLAN T56.
- EXISTING ROAD SIGN (2 POSTS) TO BE RESET BEHIND NEW TOP BACK OF AC DIKE.
- PLACE BIKE LANE SYMBOL AND BIKE LANE ARROW (PER CAL-TRANS STD. PLAN A24A & A24C).
- PLACE MARKER-CULVERT PER TABLE ON THIS SHEET.
- PLACE CLASS 2 METAL POST DELINEATOR PER CALTRANS STD. PLAN A73C.

- (LL) CALTRANS LIMIT LINE (A24E)
- (22) CAL-TRANS STRIPING DETAIL 22
- (29) CAL-TRANS STRIPING DETAIL 29
- (38) CAL-TRANS STRIPING DETAIL 38
- (39) CAL-TRANS STRIPING DETAIL 39
- (39A) CAL-TRANS STRIPING DETAIL 39A
- (A24C & A24A) BIKE LANE SYMBOL AND ARROW

- LEGEND**
- EROSION CONTROL (TYPE D)
 - FIBER ROLL PER CALTRANS STD. PLAN T56
 - MARKER - CULVERT
 - DELINEATOR

- NOTE:**
- ALL EROSION CONTROL WORK IN THIS CONTRACT TO COMPLY WITH THE FINAL STORM WATER POLLUTION PREVENTION PLAN.
 - EDGE OF ALL TRAFFIC TYPE SIGNS SHALL BE PLACED 2' FROM THE BACK OF THE AC DIKE.
 - ALL STRIPING AND PAVEMENT MARKINGS SHALL BE THERMOPLASTIC.
 - ALL TURN ARROWS AT INTERSECTION SHALL BE INSTALLED AT 8 FEET FROM LIMIT LINE.
 - REMOVE EXISTING ROADSIDE MARKERS INDICATING CHANGE IN THE CENTER LINE STRIPING (8 TOTAL).

NOTE:
CONTRACTOR SHALL POSITIVELY DETERMINE ALL HORIZONTAL AND VERTICAL LOCATIONS OF ALL UTILITIES SHOWN IN THE CONTRACT PLANS PRIOR TO CONSTRUCTION OF ANY COMPONENT OF ANY DRAINAGE SYSTEM IN ORDER TO VERIFY CONSTRUCTABILITY OF DRAINAGE SYSTEM.

TLA ENGINEERING & PLANNING
REGISTERED PROFESSIONAL ENGINEER
LOWIN J. HENDERSON
No. 66017
Exp. 06-30-12
CIVIL
STATE OF CALIFORNIA

DATE: 4.4.11

TRAFFIC CONTROL QUANTITIES – STAGE 2 PHASE 1

	UNIT	QUANTITY
TEMPORARY TRAFFIC STRIPE (PAINT)	LF	4995
TEMPORARY PAVEMENT MARKING (PAINT)	SF	84
SURFACE MOUNTED TUBULAR MARKER	EA	12
TEMPORARY RAILING (TYPE K)	LF	1660
TEMPORARY CRASH CUSHION MODULE (ABSORB 350)	LF	36
TEMPORARY CRASH CUSHION MODULE (ARRAY TS14)	EA	28
TEMPORARY PAVEMENT MARKERS	EA	1430

NOTE: QUANTITIES ARE ESTIMATE ONLY.

CONSTRUCTION AREA SIGNS

(A) THRU (E), PER STAGE 1, SEE SHEET 8.

STAGE 2

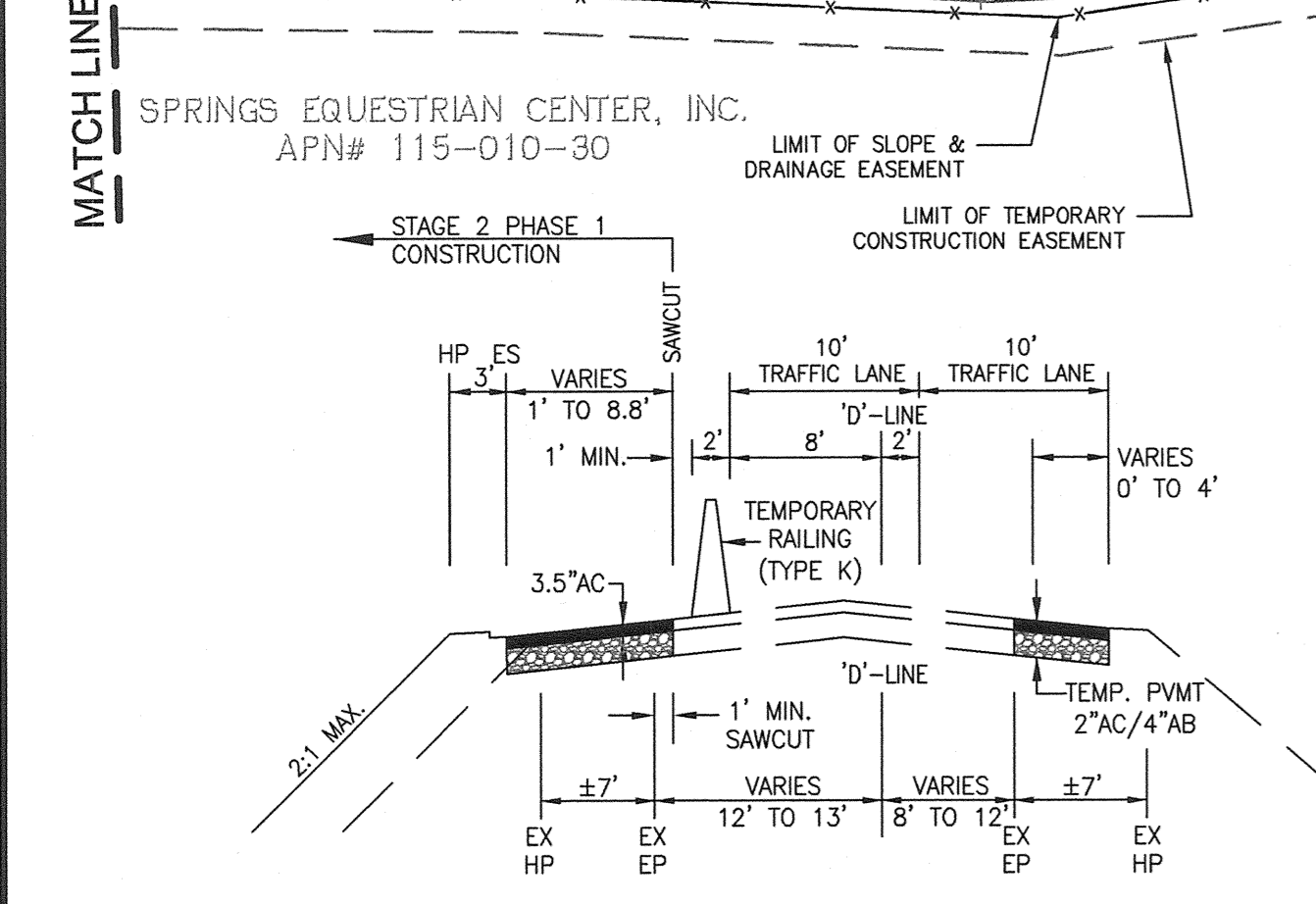
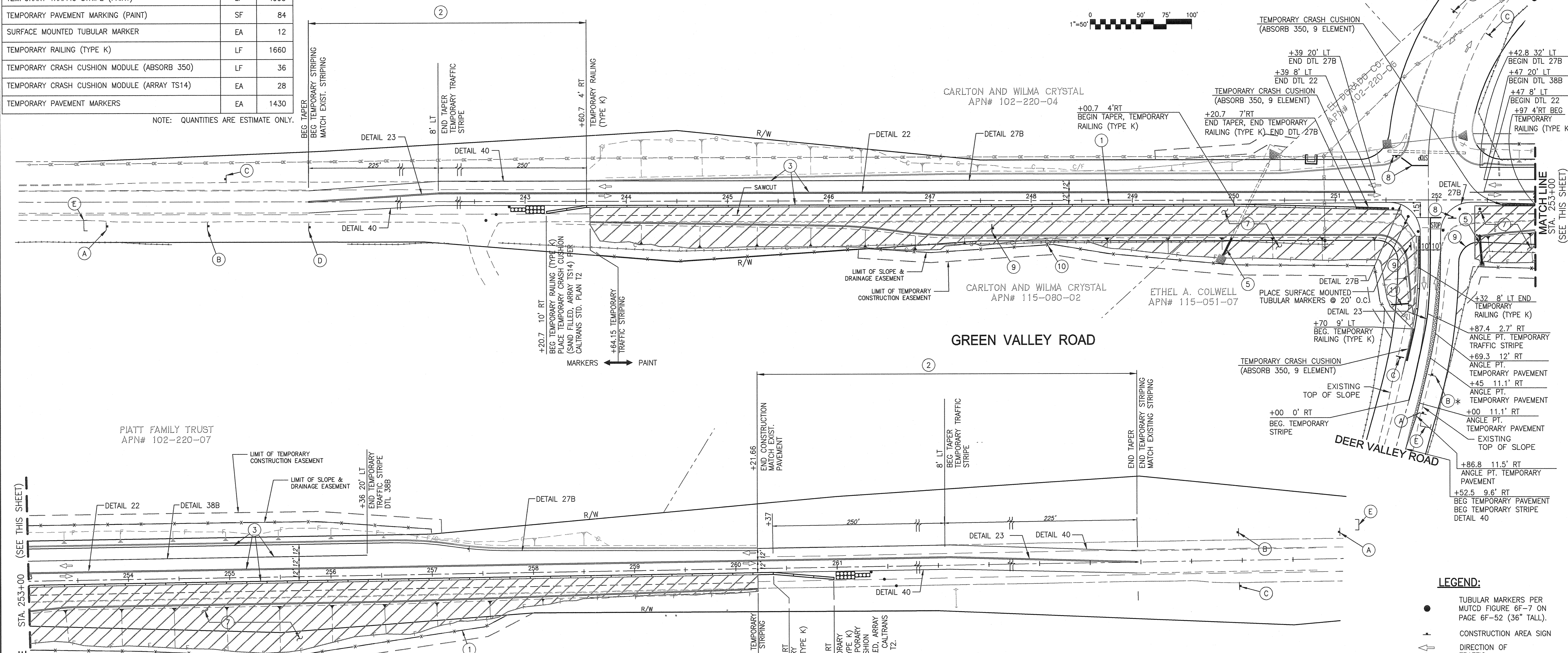
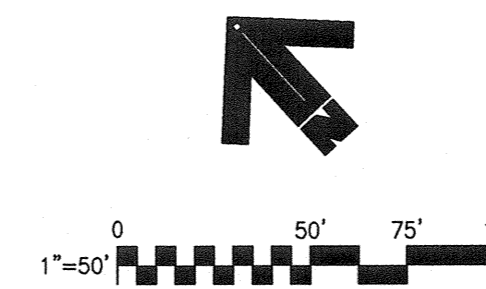

DEER VALLEY ROAD STAGE 2 PHASE 1 TYPICAL SECTION

SCALE: N.T.S.

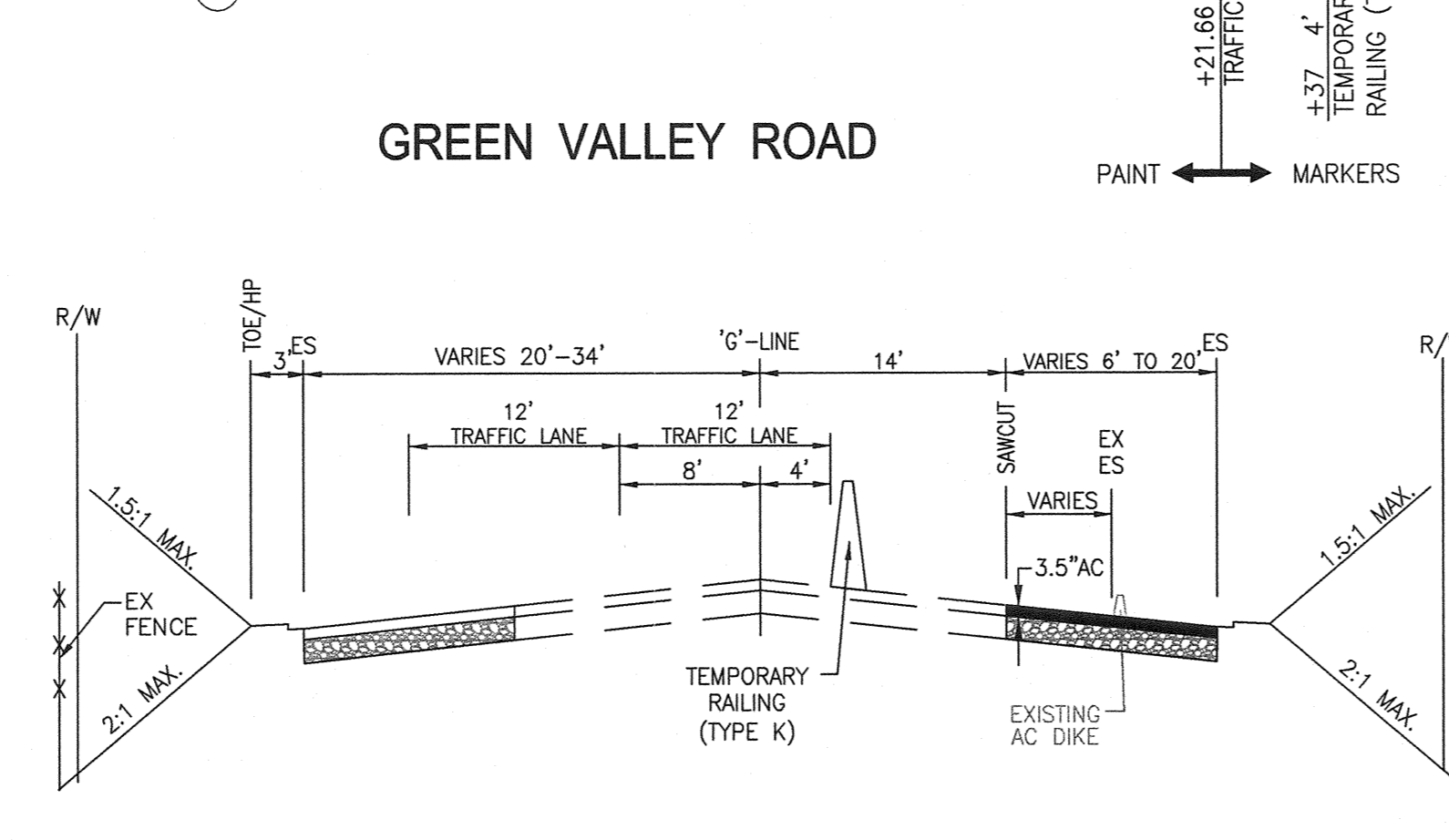

GREEN VALLEY ROAD STAGE 2 TYPICAL SECTION

SCALE: N.T.S.

TRAFFIC:

SHIFT TRAFFIC ON GREEN VALLEY ROAD TO THE LEFT OF "G"-LINE. SEE SPECIAL PROVISION TO HANDLE TEMPORARY ROAD CLOSURE. CONTRACTOR MAY CLOSE ONE LANE ON DEER VALLEY FOR STAGING. FLAGGING MAY BE REQUIRED AS DIRECTED BY ENGINEER. LANE SHALL REOPEN DURING NON CONSTRUCTION.

NOTES:

- CONSTRUCTION OF DEER VALLEY ROAD IN STAGE 2 SHALL BE DONE IN PHASES. CONSTRUCT ONE SIDE OF ROADWAY AT A TIME. SEE DEER VALLEY ROAD STAGE 2 PHASE 1 (THIS SHEET) AND PHASE 2 (SHEET 10) TYPICAL SECTIONS. FLAGGING MAY BE REQUIRED AS DIRECTED BY THE ENGINEER.

STAGE 2 CONSTRUCTION GREEN VALLEY ROAD:

- SHIFT TEMPORARY RAILING (TYPE K) FROM STAGE 1 TO RIGHT SIDE. SEE TYPICAL SECTION.
- REMOVE TEMPORARY TRAFFIC MARKERS PLACED IN STAGE 1.
- PLACE TEMPORARY TRAFFIC STRIPE FOR STAGE 2.
- CONSTRUCT RIGHT SIDE DRAINAGE THIS STAGE.
- REMOVE BASE AND SURFACE ALONG RIGHT SIDE.
- COMPLETE EARTHWORK ALONG RIGHT SIDE. CONSTRUCT NEW STRUCTURAL SECTION TO WITHIN 0.15' OF FINISH GRADE.
- RESET EXISTING STOP SIGN. REMOVE AND REPLACE STOP BAR AND LEGEND.
- RESET EXISTING SIGN.
- REMOVE AND REPLACE EXISTING FENCE.
- DO NOT CONSTRUCT AC OVERSIDE DRAIN UNIT AFTER STAGE 2 PHASE 2 IS COMPLETE DUE TO TEMPORARY PAVEMENT.

STAGE 2 CONSTRUCTION DEER VALLEY ROAD PHASE 1:

- PLACE TEMPORARY PAVEMENT RIGHT SIDE OF DEER VALLEY ROAD.
- PLACE TEMPORARY RAILING (TYPE K) FOR STAGE 2 PHASE 1.
- COMPLETE EARTHWORK ON SOUTHWEST CORNER. CONSTRUCT NEW STRUCTURAL SECTION TO WITHIN 0.15' OF FINISH GRADE.

STAGE 2 CONSTRUCTION DEER VALLEY ROAD PHASE 2:

- PLACE TEMPORARY PAVEMENT LEFT SIDE OF DEER VALLEY ROAD.
- SHIFT TEMPORARY RAILING (TYPE K) FOR STAGE 2 PHASE 2.
- COMPLETE EARTHWORK ON SOUTHEAST CORNER. CONSTRUCT NEW STRUCTURAL SECTION TO WITHIN 0.15' OF FINISH GRADE.

THIS PLAN IS ACCURATE FOR STAGE CONSTRUCTION WORK ONLY

LEGEND:

- TUBULAR MARKERS PER MUTCD FIGURE 6F-7 ON PAGE 6F-52 (36" TALL).
- CONSTRUCTION AREA SIGN
- DIRECTION OF TRAFFIC
- TEMPORARY PAVEMENT AND FILL TO BE PLACED IN STAGE 2
- CONSTRUCT THIS STAGE IN STAGE 2
- PORTABLE CHANGEABLE MESSAGE SIGN
- TEMPORARY RAILING (TYPE K)
- TEMPORARY CRASH CUSHION (ABSORB 350, 9 ELEMENT)
- TEMPORARY CRASH CUSHION (SAND FILLED, ARRAY TS14)

TLA ENGINEERING & PLANNING

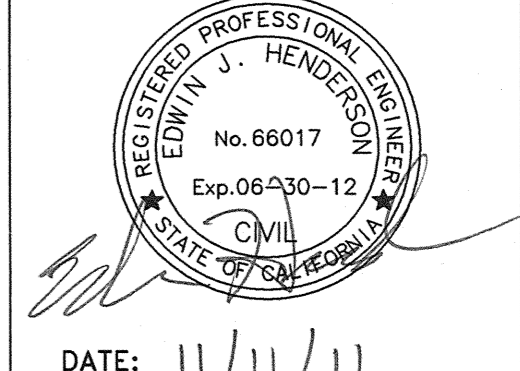

DATE: 11/11/11

OWNER INFORMATION
SILVER SPRINGS LLC
2989 OAK ROAD, SUITE 400
WALNUT CREEK, CA 94597
(925) 933-1405

ENGINEERING & PLANNING
1225 RIVERDALE ROAD, SUITE 100
FOLSOM, CA 95630

PROJECT #66114
GREEN VALLEY ROAD/DEER VALLEY ROAD TURN LANES
STAGE CONSTRUCTION PLAN - STAGE 2
TM 97-1350, COUNTY CONTRACT NO. PW 09-30470

SHEET 9 OF 11

STAGE 2 (CONTINUED)

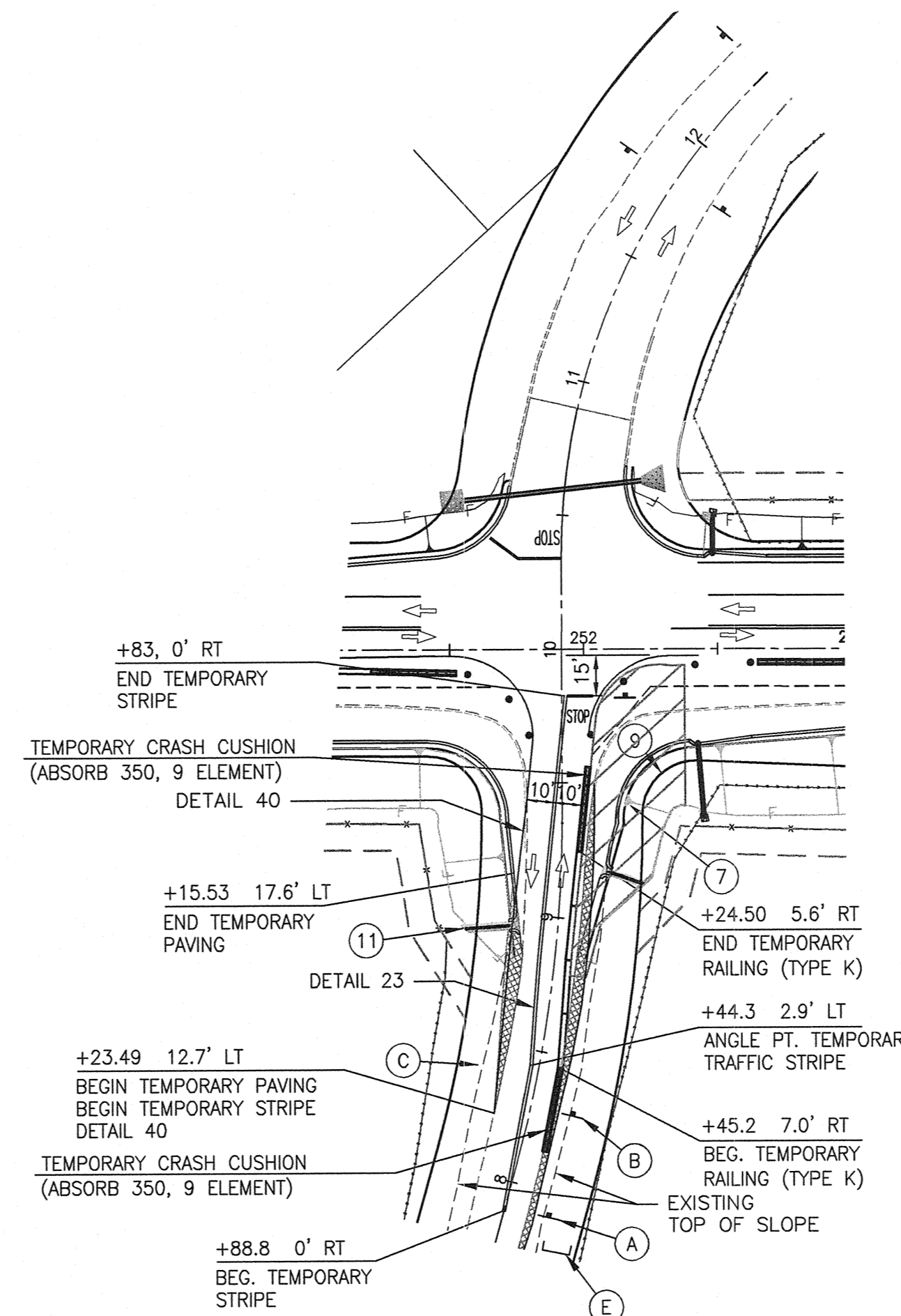
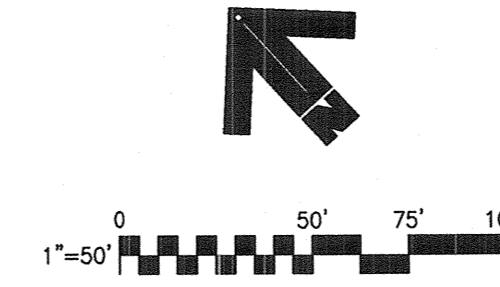

TRAFFIC CONTROL QUANTITIES - STAGE 2 PHASE 2

	UNIT	QUANTITY
TEMPORARY TRAFFIC MARKERS	EA	136
TEMPORARY PAVEMENT MARKING (PAINT)	SF	32
TEMPORARY RAILING (TYPE K)	LF	80
TEMPORARY CRASH CUSHION MODULE (ABSORB 350)	EA	2
SURFACE MOUNTED TUBULAR MARKER	EA	7

NOTE: QUANTITIES ARE ESTIMATE ONLY.

CONSTRUCTION AREA SIGNS

(A) THRU (E), PER STAGE 1, SEE SHEET 8.

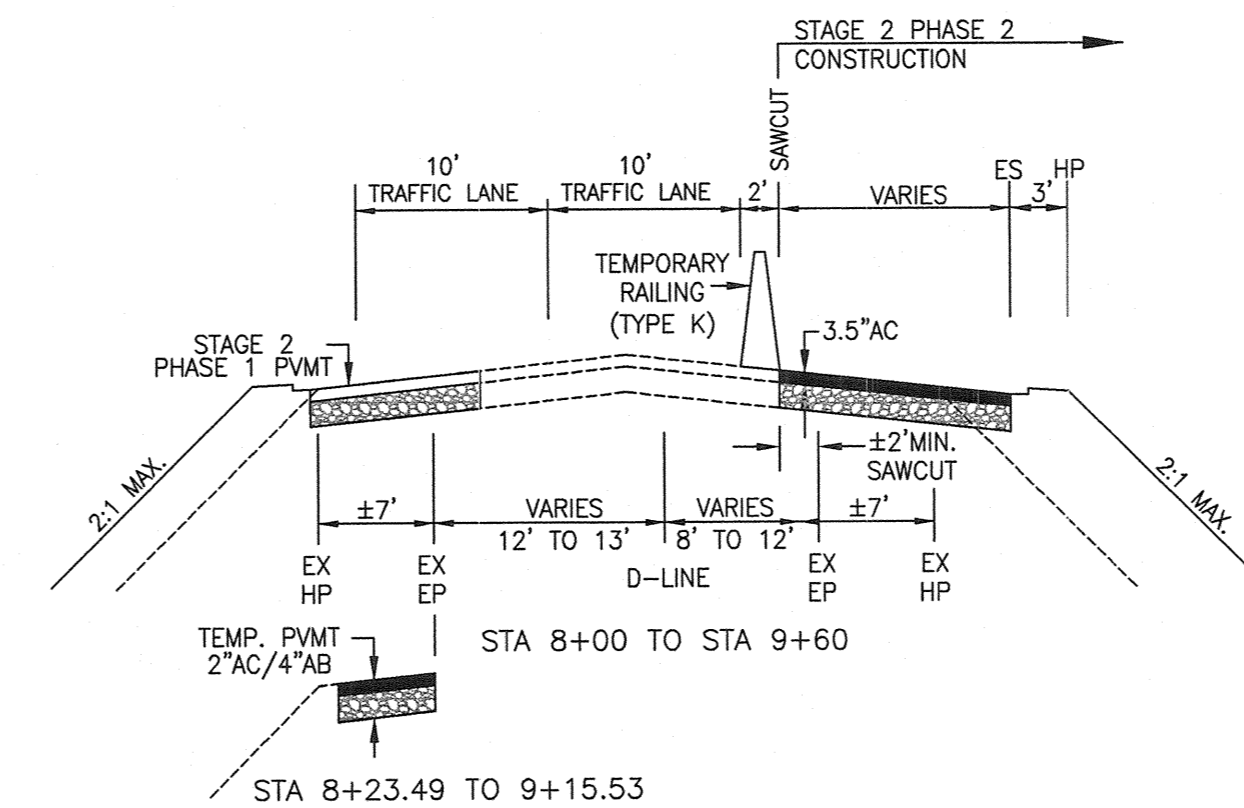

DEER VALLEY ROAD STAGE 2 PHASE 2 TYPICAL SECTION

SCALE: N.T.S.

LEGEND:

- TUBULAR MARKERS PER MUTCD FIGURE 6F-7 ON PAGE 6F-52 (36" TALL).
- ↑ CONSTRUCTION AREA SIGN
- ⇄ DIRECTION OF TRAFFIC
- ▨ TEMPORARY PAVEMENT TO BE PLACED IN STAGE 2
- ▧ CONSTRUCT THIS STAGE IN STAGE 2
- [PORTABLE CHANGEABLE MESSAGE SIGN
- TEMPORARY RAILING (TYPE K)
- TEMPORARY CRASH CUSHION (ABSORB 350, 9 ELEMENT)

STAGE 2 CONSTRUCTION:

- (7) COMPLETE EARTHWORK ALONG EAST SIDE. CONSTRUCT NEW STRUCTURAL SECTION TO WITHIN 0.15' OF FINISH GRADE.
- (9) RESET EXISTING SIGN.
- (11) DO NOT CONSTRUCT AC OVERSIDE DRAIN UNTIL AFTER STAGE 2 PHASE 2 IS COMPLETE DUE TO TEMPORARY PAVEMENT.

TLA
ENGINEERING & PLANNING

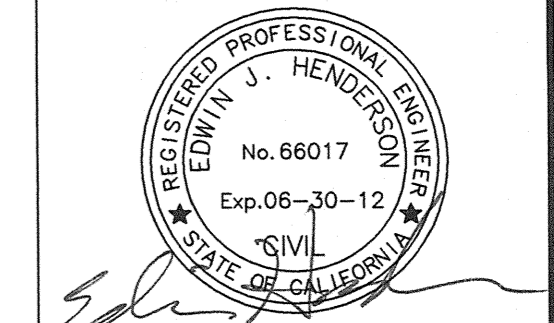

DATE: 4.4.11

THIS PLAN IS ACCURATE FOR STAGE CONSTRUCTION WORK ONLY

OWNER INFORMATION
SILVER SPRINGS LLC
2899 OAK ROAD, SUITE 400
WALNUT CREEK, CA 94697
(925) 933-1405

ENGINEERING & PLANNING
11111
ROSELIE, CA 94668

GREEN VALLEY ROAD/DEER VALLEY ROAD TURN LANES
STAGE CONSTRUCTION PLAN - STAGE 2 (CONT)
EL DORADO COUNTY TM 97-1330, COUNTY CONTRACT NO. PW 09-30470

PROJECT #66114

GRADING AND IMPROVEMENT PLANS FOR

SHEET 10 OF 11

APPROVED BY: DATE: _____
REVISION: _____

STAGE 3

CONSTRUCTION AREA SIGNS
 (A) THRU (E) PER STAGE 1, SEE SHEET 8.

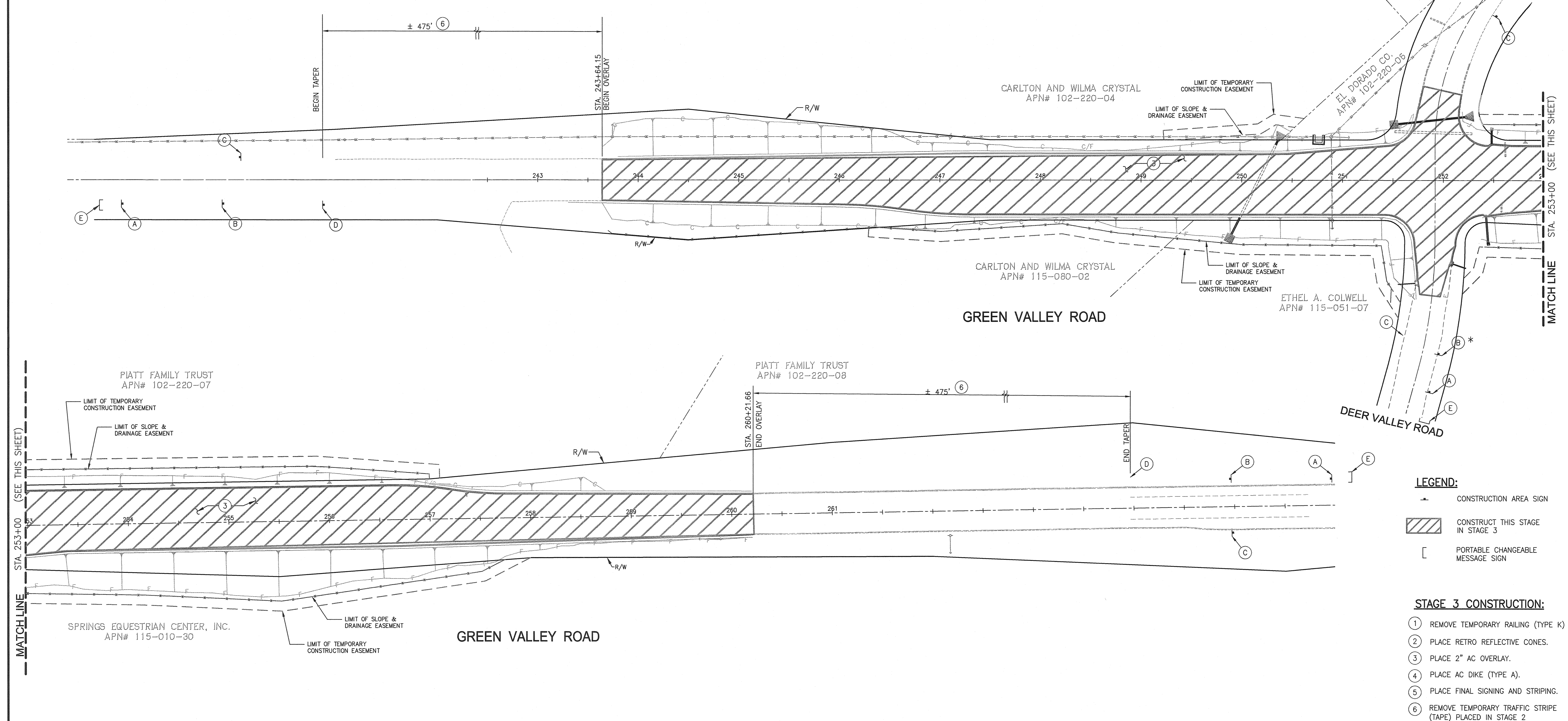
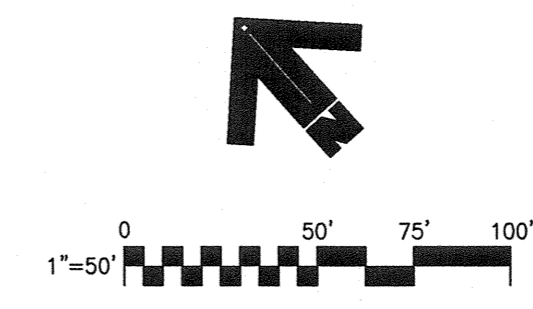

- LEGEND:**
- CONSTRUCTION AREA SIGN
 - CONSTRUCT THIS STAGE IN STAGE 3
 - PORTABLE CHANGEABLE MESSAGE SIGN

- STAGE 3 CONSTRUCTION:**
- 1 REMOVE TEMPORARY RAILING (TYPE K)
 - 2 PLACE RETRO REFLECTIVE CONES.
 - 3 PLACE 2" AC OVERLAY.
 - 4 PLACE AC DIKE (TYPE A).
 - 5 PLACE FINAL SIGNING AND STRIPING.
 - 6 REMOVE TEMPORARY TRAFFIC STRIPE (TAPE) PLACED IN STAGE 2
- TRAFFIC:**
 SHIFT TRAFFIC ON GREEN VALLEY ROAD TO COMPLETE OVERLAY PER CALTRANS STANDARD PLAN.

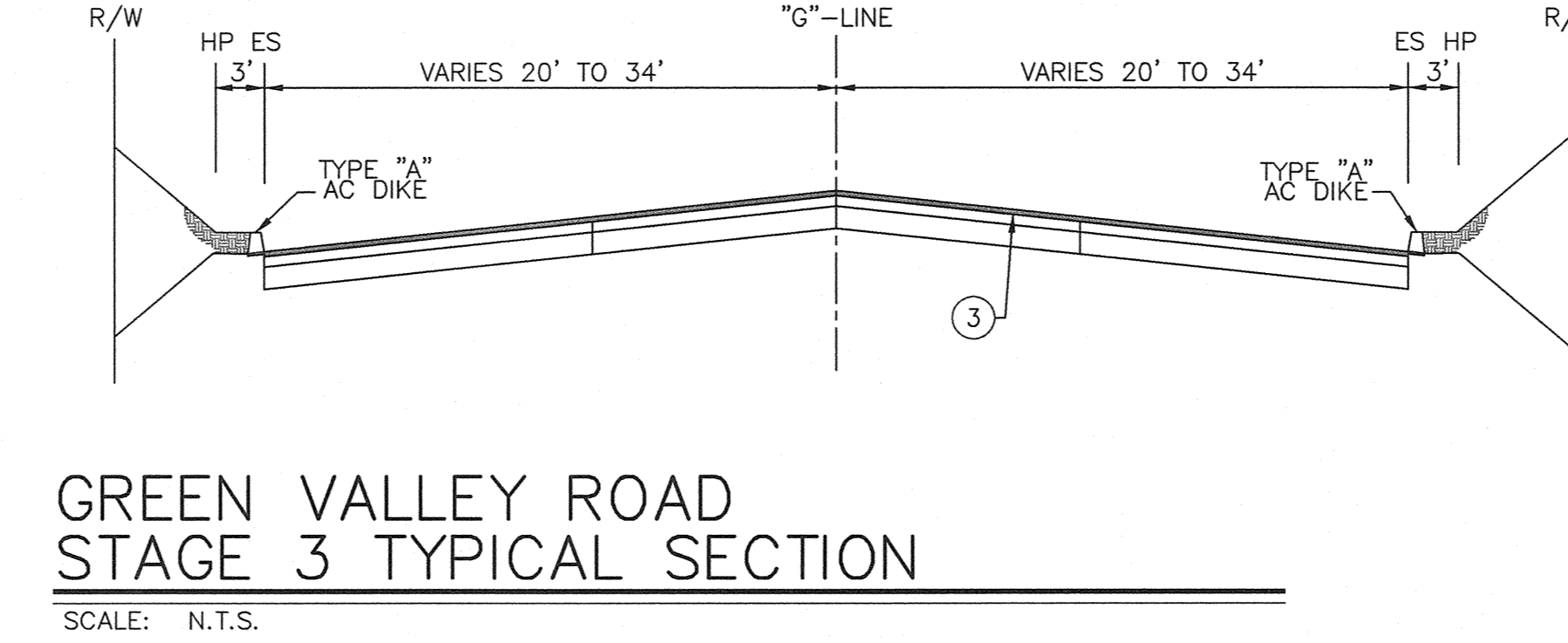
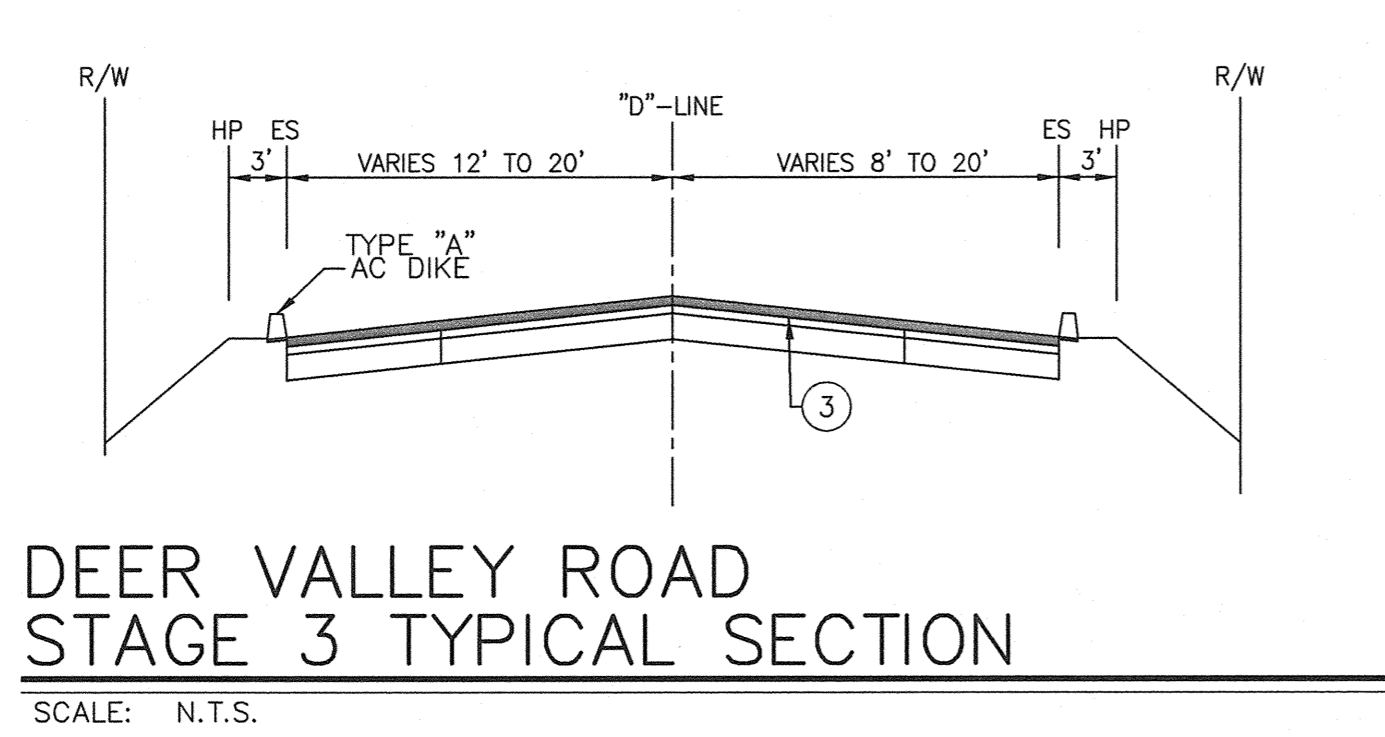

NOTES:
 1. FLAGGING MAY BE REQUIRED AS DIRECTED BY THE ENGINEER.

TLA ENGINEERING & PLANNING

REGISTERED PROFESSIONAL ENGINEER
 J. HENDERSON
 No. 66017
 Exp. 06-30-12
 CIVIL
 STATE OF CALIFORNIA

DATE: 11/11/11

THIS PLAN IS ACCURATE FOR STAGE CONSTRUCTION WORK ONLY

OWNER INFORMATION
 SILVER SPRINGS LLC
 2999 OAK ROAD, SUITE 400
 WALNUT CREEK, CA 94597
 (925) 933-1405

ENGINEERING & PLANNING
 TLA ENGINEERING & PLANNING
 1105 VILLETTA CA 95611 TEL: 925-933-1405

CALIFORNIA

PROJECT #66114
 GREEN VALLEY ROAD/DEER VALLEY ROAD TURN LANES
 STAGE CONSTRUCTION PLAN - STAGE 3
 TM 97-1330, COUNTY CONTRACT NO. PW 09-30470

11 OF 11