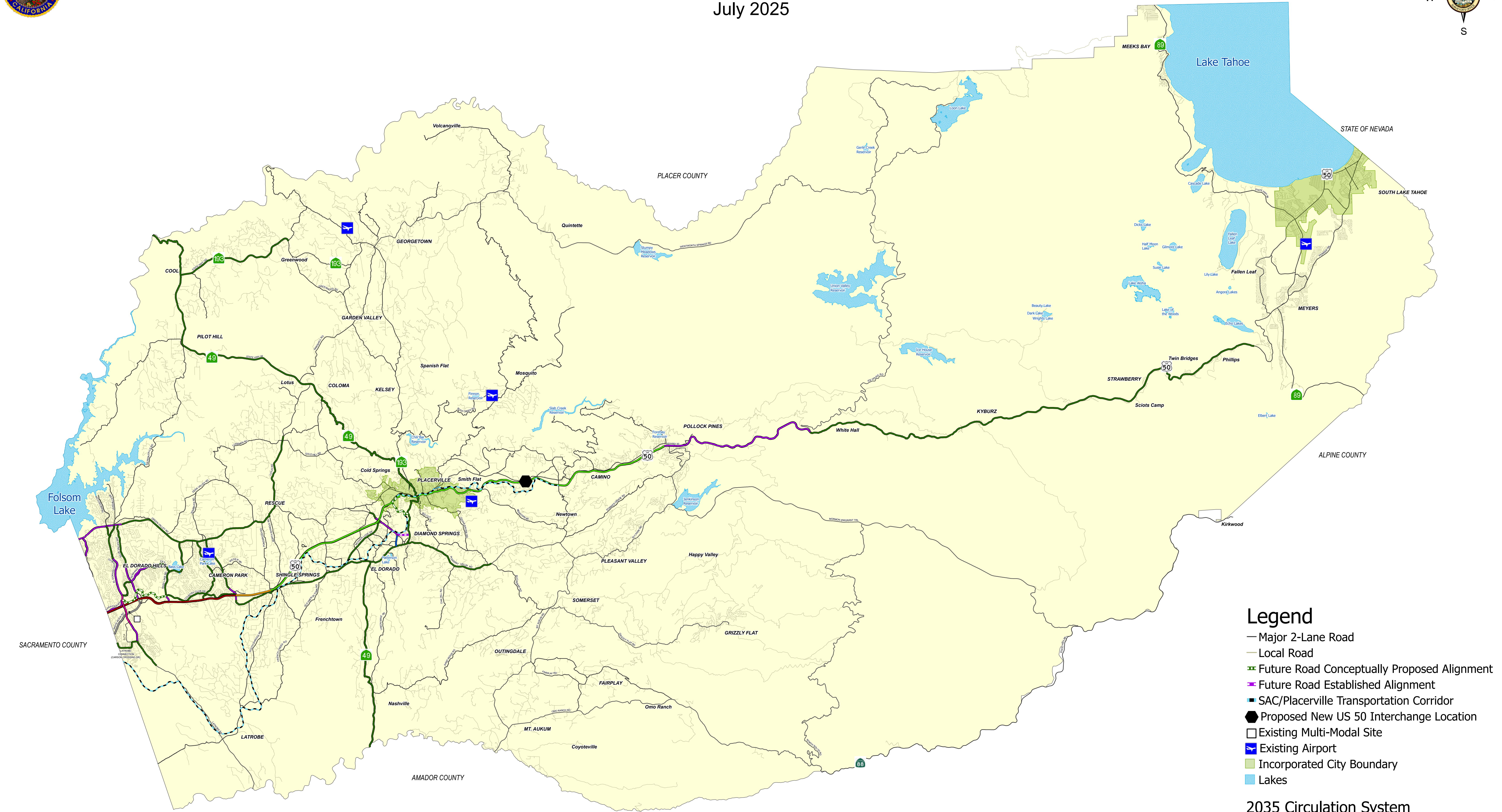
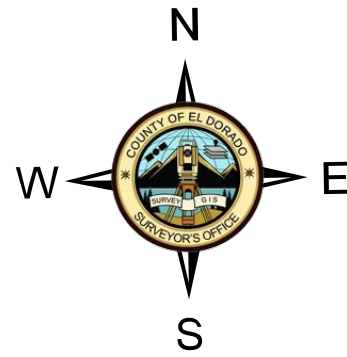



FIGURE TC-1
CIRCULATION MAP FOR THE EL DORADO COUNTY GENERAL PLAN
July 2025



- Legend
- Major 2-Lane Road
 - Local Road
 - Future Road Conceptually Proposed Alignment
 - Future Road Established Alignment
 - SAC/Placerville Transportation Corridor
 - Proposed New US 50 Interchange Location
 - Existing Multi-Modal Site
 - Existing Airport
 - Incorporated City Boundary
 - Lakes

- 2035 Circulation System
- Major 2 Lane Road
 - 4 Lane Undivided Road
 - 4 Lane Divided Road
 - 6 Lane Divided Road
 - 4 Lane Freeway
 - 6 Lane Freeway
 - 8 Lane Freeway
 - Capital Southeast Connector Corridor

DISCLAIMER:
THIS DEPICTION WAS COMPILED FROM UNVERIFIED PUBLIC AND PRIVATE SOURCES AND IS ILLUSTRATIVE ONLY. NO REPRESENTATION IS MADE AS TO THE ACCURACY OF THIS INFORMATION. PARCEL BOUNDARIES ARE PARTICULARLY UNRELIABLE. USERS MAKE USE OF THIS DEPICTION AT THEIR OWN RISK.

NOTES:
LAYER INFORMATION MAY COVER ADDITIONAL AREAS OUTSIDE OF THE DISPLAYED AREA.
PREPARED AT THE REQUEST OF: Planning Division DATE: 6/30/2025
MAP PREPARED BY: EDC GIS DATE: 7/10/2025
G.I.S. PROJECT ID: Q6VF381824. RELATED REPORT: N/A
EL DORADO COUNTY SURVEYOR/G.I.S. DIVISION
EMAIL: gis@edcgov.us PHONE: (530) 621-5440
MAP DISPLAYED IN STATE PLANE COORDINATE SYSTEM
(NAD 1983 CALIFORNIA ZONE 2, FEET)

County of El Dorado
State of California

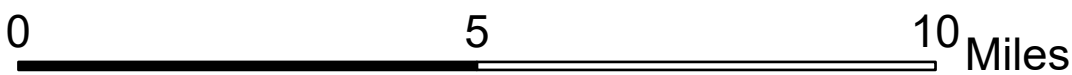

2035 and Potential Future Roadway Facilities

Roadway	Segment	2035 Facility	Future Facility
Bass Lake Road	US 50 to Silver Springs Parkway	Major 2-Lane	4-Lane Divided
Cameron Park Drive	Hacienda Drive to Meder Road	Major 2-Lane	4-Lane Divided
El Dorado Hills Boulevard	Governor Drive/St Andrews Drive to Francisco Drive	Major 2-Lane	4-Lane Divided
Francisco Drive	El Dorado Hills Boulevard to Green Valley Road	Major 2-Lane	4-Lane Divided
Green Valley Road	Silva Valley Parkway to Deer Valley Road (West)	Major 2-Lane	4-Lane Divided
Latrobe Connection (Carson Crossing Drive)	Golden Foothills Parkway to El Dorado County Line	Major 2-Lane	4-Lane Divided
Latrobe Road	White Rock Road to Suncaist Lane	4-Lane Divided	6-Lane Divided
Silva Valley Parkway	Harvard Way to Green Valley Road	Major 2-Lane	4-Lane Divided
White Rock Road1	Latrobe Road to US 50	4-Lane Divided	6-Lane Divided
1 White Rock Road is the eastern end of the Capital Southeast Connector Corridor.			



FIGURE TC-1
CIRCULATION MAP FOR THE EL DORADO COUNTY GENERAL PLAN
July 2025

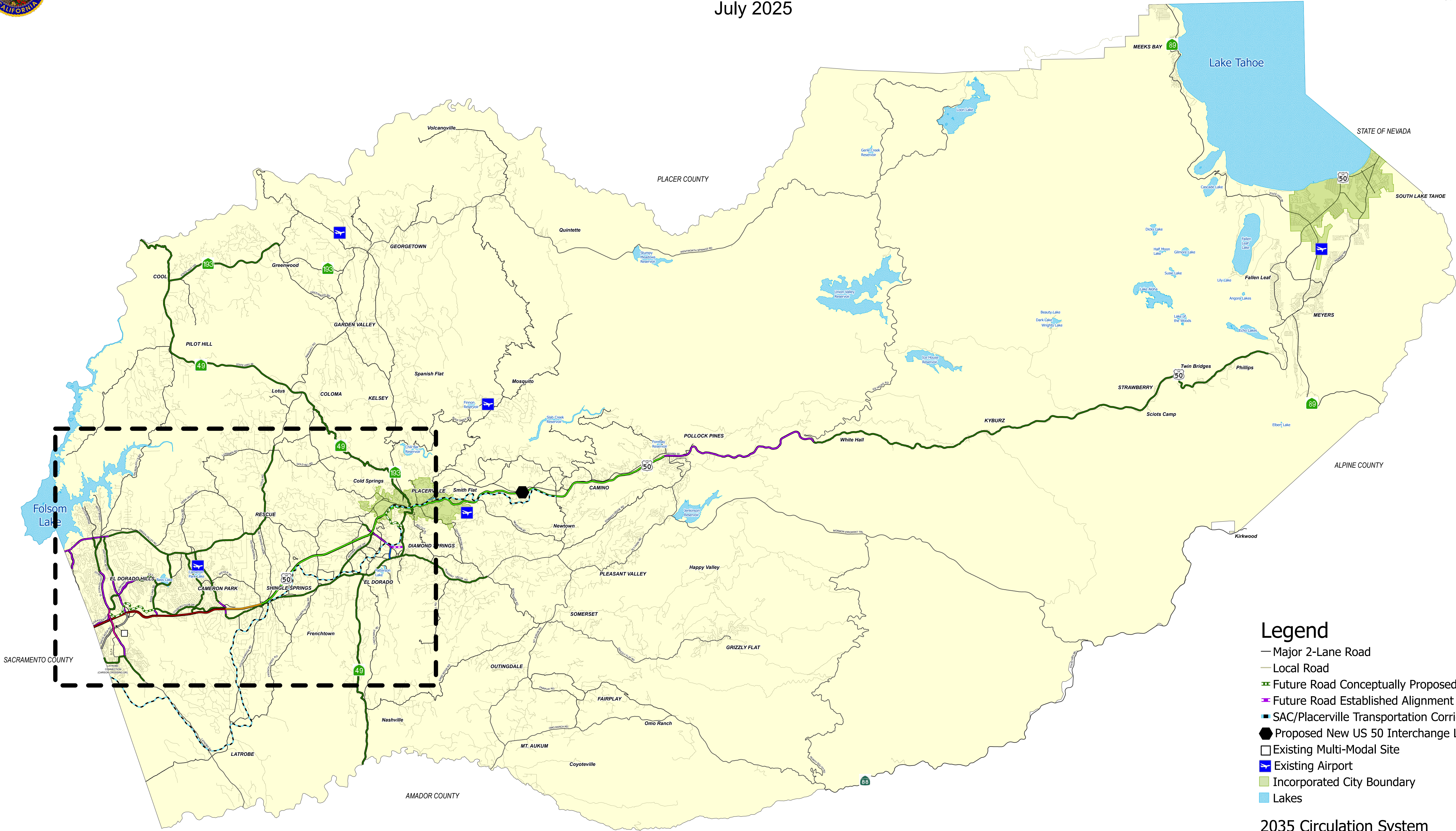
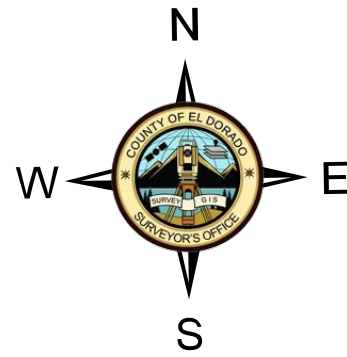

- Legend**
- Major 2-Lane Road
 - Local Road
 - Future Road Conceptually Proposed Alignment
 - Future Road Established Alignment
 - SAC/Placerville Transportation Corridor
 - Proposed New US 50 Interchange Location
 - Existing Multi-Modal Site
 - Existing Airport
 - Incorporated City Boundary
 - Lakes

- 2035 Circulation System**
- Major 2 Lane Road
 - 4 Lane Undivided Road
 - 4 Lane Divided Road
 - 6 Lane Divided Road
 - 4 Lane Freeway
 - 6 Lane Freeway
 - 8 Lane Freeway
 - Capital Southeast Connector Corridor

2035 and Potential Future Roadway Facilities

Roadway	Segment	2035 Facility	Future Facility
Bass Lake Road	US 50 to Silver Springs Parkway	Major 2-Lane	4-Lane Divided
Cameron Park Drive	Hacienda Drive to Meder Road	Major 2-Lane	4-Lane Divided
El Dorado Hills Boulevard	Governor Drive/St Andrews Drive to Francisco Drive	Major 2-Lane	4-Lane Divided
Francisco Drive	El Dorado Hills Boulevard to Green Valley Road	Major 2-Lane	4-Lane Divided
Green Valley Road	Silva Valley Parkway to Deer Valley Road (West)	Major 2-Lane	4-Lane Divided
Latrobe Connection (Carson Crossing Drive)	Golden Foothills Parkway to El Dorado County Line	Major 2-Lane	4-Lane Divided
Latrobe Road	White Rock Road to Suncaist Lane	4-Lane Divided	6-Lane Divided
Silva Valley Parkway	Harvard Way to Green Valley Road	Major 2-Lane	4-Lane Divided
White Rock Road1	Latrobe Road to US 50	4-Lane Divided	6-Lane Divided
1 White Rock Road is the eastern end of the Capital Southeast Connector Corridor.			

DISCLAIMER:
THIS DEPICTION WAS COMPILED FROM UNVERIFIED PUBLIC AND PRIVATE SOURCES AND IS ILLUSTRATIVE ONLY. NO REPRESENTATION IS MADE AS TO THE ACCURACY OF THIS INFORMATION. PARCEL BOUNDARIES ARE PARTICULARLY UNRELIABLE. USERS MAKE USE OF THIS DEPICTION AT THEIR OWN RISK.

NOTES:
LAYER INFORMATION MAY COVER ADDITIONAL AREAS OUTSIDE OF THE DISPLAYED AREA.
PREPARED AT THE REQUEST OF: Planning Division DATE: 6/30/2025
MAP PREPARED BY: EDC GIS DATE: 7/10/2025
G.I.S. PROJECT ID: Q6VF381824. RELATED REPORT: N/A
EL DORADO COUNTY SURVEYOR/G.I.S. DIVISION
EMAIL: gis@edcgov.us PHONE: (530) 621-5440
MAP DISPLAYED IN STATE PLANE COORDINATE SYSTEM
(NAD 1983 CALIFORNIA ZONE 2, FEET)

County of El Dorado
State of California

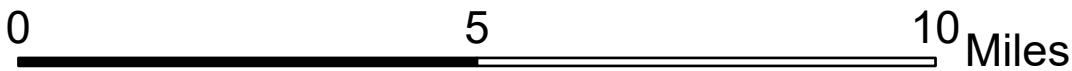



County of El Dorado
State of California

FIGURE TC-1
CIRCULATION MAP FOR THE EL DORADO COUNTY GENERAL PLAN
July 2025

DISCLAIMER:
THIS DEPICTION WAS COMPILED FROM UNVERIFIED PUBLIC AND PRIVATE SOURCES
AND IS ILLUSTRATIVE ONLY. NO REPRESENTATION IS MADE AS TO THE ACCURACY OF THIS INFORMATION.
PARCEL BOUNDARIES ARE PARTICULARLY UNRELIABLE.
USERS MAKE USE OF THIS DEPICTION AT THEIR OWN RISK.

NOTES:
LAYER INFORMATION MAY COVER ADDITIONAL AREAS OUTSIDE OF THE DISPLAYED AREA.
PREPARED AT THE REQUEST OF: Planning Division DATE: 6/30/2025
MAP PREPARED BY: EDC GIS DATE: 7/10/2025
G.I.S. PROJECT ID: G0VF381824, RELATED REPORT: N/A
EL DORADO COUNTY SURVEYOR G.I.S. DIVISION
EMAIL: gis@edcgov.us PHONE: (530) 621-5440
MAP DISPLAYED IN STATE PLANE COORDINATE SYSTEM
(NAD 1983 CALIFORNIA ZONE 2, FEET)

- Legend**
- Major 2-Lane Road
 - Local Road
 - Future Road Conceptually Proposed Alignment
 - Future Road Established Alignment
 - SAC/Placerville Transportation Corridor
 - Proposed New US 50 Interchange Location
 - Existing Multi-Modal Site
 - Existing Airport
 - Incorporated City Boundary
 - Lakes

2035 Circulation System

- Major 2 Lane Road
- 4 Lane Undivided Road
- 4 Lane Divided Road
- 6 Lane Divided Road
- 4 Lane Freeway
- 6 Lane Freeway
- 8 Lane Freeway
- Capital Southeast Connector Corridor

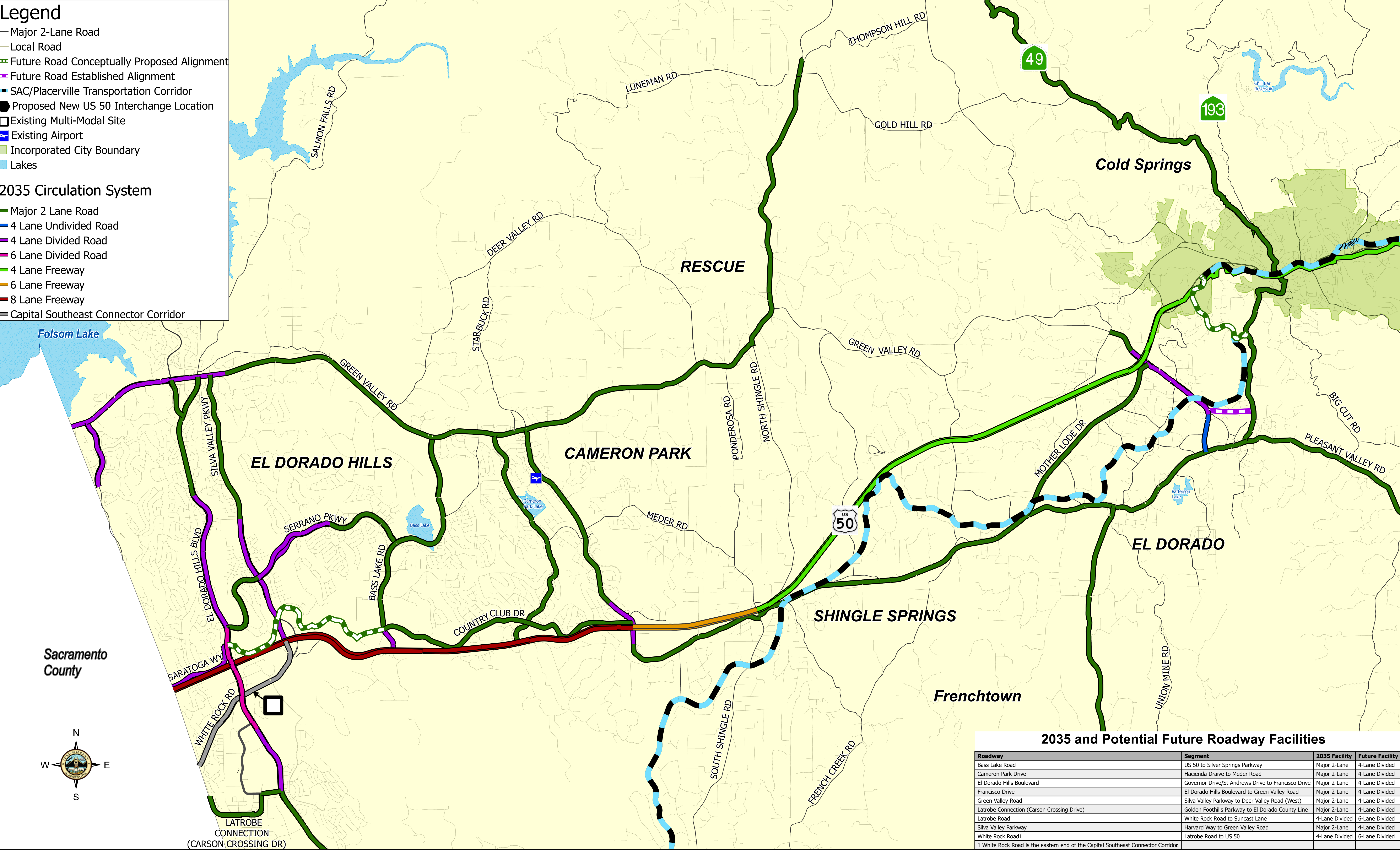

2035 and Potential Future Roadway Facilities

Roadway	Segment	2035 Facility	Future Facility
Bass Lake Road	US 50 to Silver Springs Parkway	Major 2-Lane	4-Lane Divided
Cameron Park Drive	Hacienda Drive to Meder Road	Major 2-Lane	4-Lane Divided
El Dorado Hills Boulevard	Governor Drive/St Andrews Drive to Francisco Drive	Major 2-Lane	4-Lane Divided
Francisco Drive	El Dorado Hills Boulevard to Green Valley Road	Major 2-Lane	4-Lane Divided
Green Valley Road	Silva Valley Parkway to Deer Valley Road (West)	Major 2-Lane	4-Lane Divided
Latrobe Connection (Carson Crossing Drive)	Golden Foothills Parkway to El Dorado County Line	Major 2-Lane	4-Lane Divided
Latrobe Road	White Rock Road to Suncastr Lane	4-Lane Divided	6-Lane Divided
Silva Valley Parkway	Harvard Way to Green Valley Road	Major 2-Lane	4-Lane Divided
White Rock Road ¹	Latrobe Road to US 50	4-Lane Divided	6-Lane Divided
¹ White Rock Road is the eastern end of the Capital Southeast Connector Corridor.			