

LEGEND		
	EXISTING	NEW
BOUNDARY	---	---
CONCRETE		[Pattern]
ASPHALT		[Pattern]
STORM DRAIN (SD)	[Symbol]	[Symbol]
WATER LINE (W)	W	W
SANITARY SEWER (SS)	[Symbol]	[Symbol]
WATER METER		[Symbol]
REDUCED PRESSURE BACKFLOW PREVENTER		[Symbol]
SANITARY CLEANOUT		[Symbol]
STORM CLEANOUT		[Symbol]
CATCH BASIN		[Symbol]
POINT OF CONNECTION		[Symbol]
RETAINING WALL		[Symbol]
LANDSCAPE		[Pattern]
BIORETENTION		[Pattern]

ABBREVIATIONS			
⊙	AT	N/A	NOT APPLICABLE
A.B.	AGGREGATE BASE	NTS	NOT TO SCALE
A.C.	ASPHALT CONCRETE	OC	ON CENTER
A.P.N.	ASSESSOR'S PARCEL NUMBER	OG	ORIGINAL GROUND
ARV	AIR RELEASE VALVE	P	PAVEMENT GRADE
BW	BOTTOM OF WALL	P.L.	PROPERTY LINE
BC	BEGINNING OF CURVE	PP	POWER POLE
BOC	BACK OF CURB	P.U.E.	PUBLIC UTILITY EASEMENT
BOW	BOTTOM OF WALL	PRC	POINT OF RETURN CURVATURE
BDRY	BOUNDARY	PT	POINT
BSBL	BUILDING SETBACK LINE	R	RADIUS
C & G	CURB AND GUTTER	RC	RELATIVE COMPACTION
CIP	CAST IRON PIPE	RTN	RETURN
CL	CENTERLINE	RIM	MANHOLE RIM ELEVATION
CO	CLEAN OUT	RV	RESISTANCE VALVE
CB	CATCH BASIN	R.C.P.	REINFORCED CONCRETE PIPE
CONST.	CONSTRUCTION	RoW	RIGHT OF WAY
CONC.	CONCRETE	SBL	SET BACK LINE
CONT.	CONTINUE	SHT	SHEET
C.P.	CONCRETE PIPE	SNS	STREET NAME SIGN
CT.	COURT	STA	STATION
D.I.	DRAIN INLET	STD	STANDARD
DIA.	DIAMETER	SS	SANITARY SEWER
DEMO.	DEMOLITION	S.D.	STORM DRAIN
DRWY.	DRIVE WAY	MH(D)	STORM DRAIN MANHOLE
DIP	DUCTILE IRON PIPE	MH(S)	SANITARY SEWER MANHOLE
E	EAST	S.S.	SEWER SERVICE
EA	EACH	STD.	STANDARD
E.P.	EDGE OF PAVEMENT	SW	SIDEWALK
E.P.B.	ELECTRIC POLE BOX	TPW	TOP OF WATER
EC	END OF CURVE	T.C.	TOP OF CURB
ES	EDGE OF SHOULDER	THRU	THROUGH
ESMT.	EASEMENT	TOP	TOP OF PIPE
ELECT.	ELECTROLIER	T.G.	TOP OF GRATE
ELEV.	ELEVATION	TOW	TOP OF WALL
EX.	EXISTING	TPE	TREE PLANTING EASEMENT
FL	FLOWLINE	T.W.	TOP OF WALL ELEVATION
FG	FINISHED GRADE	TYP.	TYPICAL
FOC	FACE OF CURB	V.C.P.	VITRIFIED CLAY PIPE
GB	GRADE BREAK	VERT	VERTICAL
GR.	GRATE ELEVATION	VG	VALLEY GUTTER
HORIZ	HORIZONTAL	W	WATER LINE
INV.	PIPE INVERT ELEVATION	W.S.	WATER SERVICE
LP	LOW POINT	+ -	PLUS OR MINUS (NOT EXACT)
LOG	LIP OF GUTTER	W/	WITH
MH	MANHOLE		
(N)	NEW		

CIVIL IMPROVEMENTS PLANS FOR

NE CNR OF HWY-49 & GEORGETOWN RD

COOL, CA 95614

APN: 071-080-007

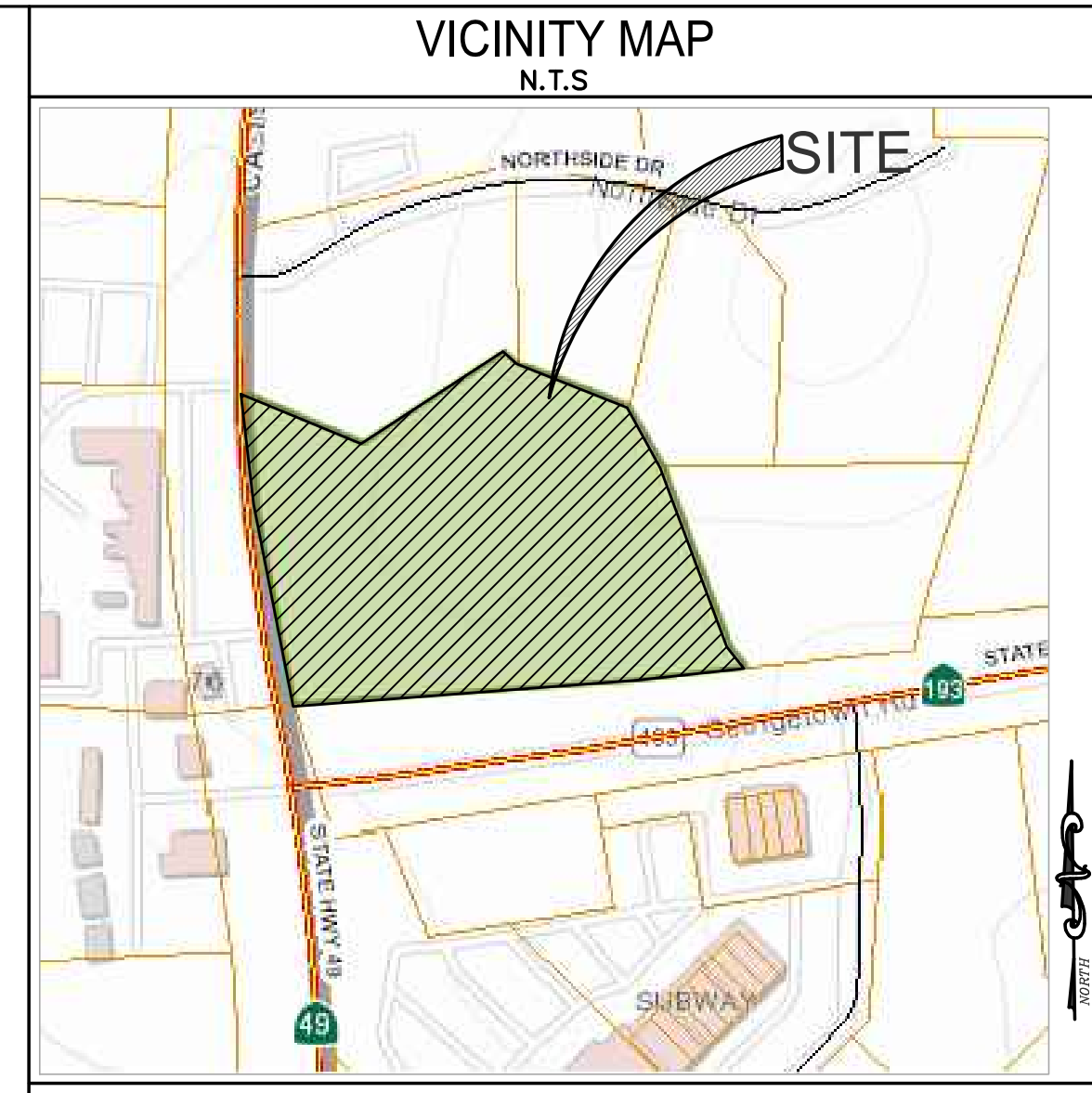
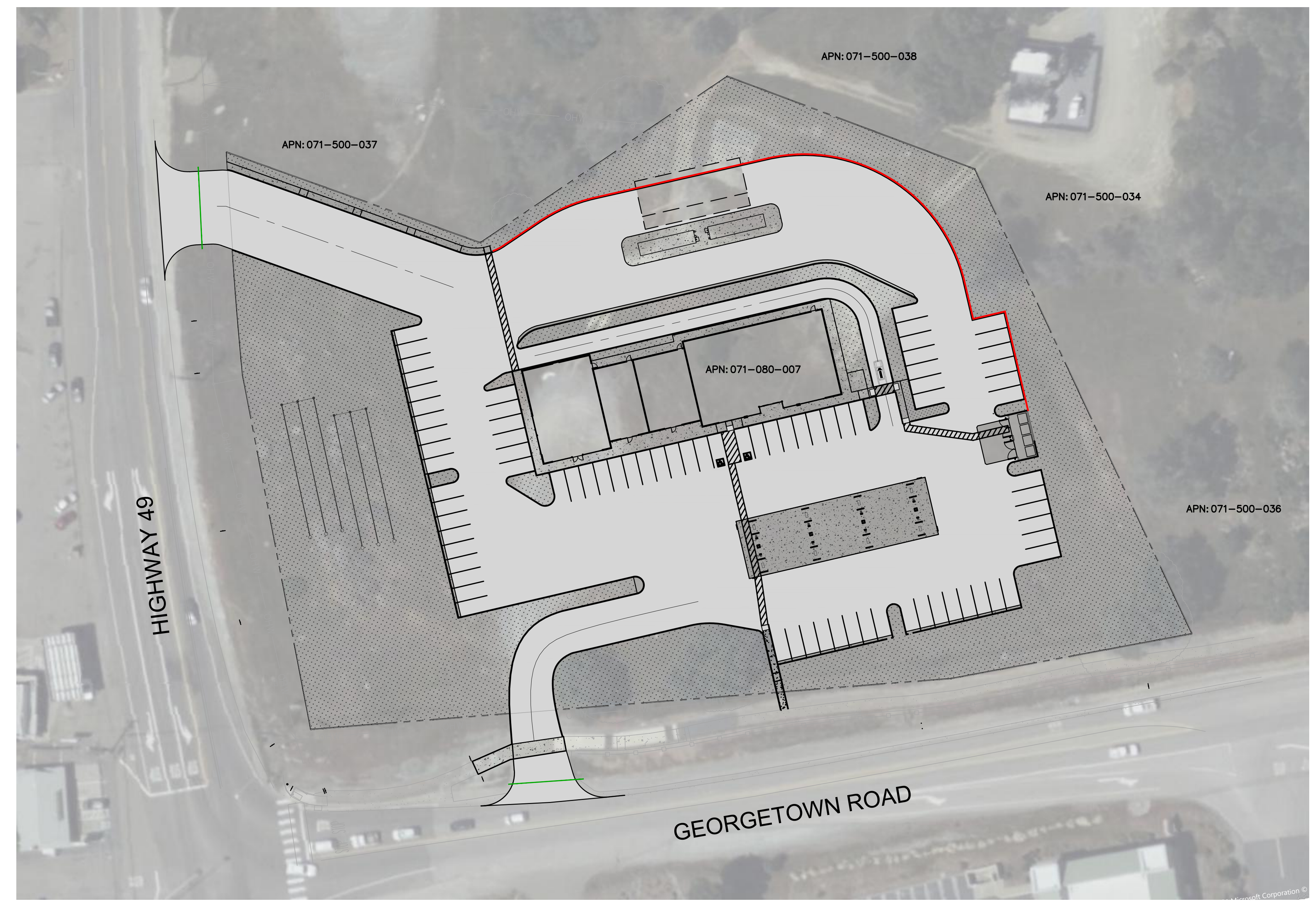

SHEET INDEX (CIVIL)	
G-1.0	COVER SHEET
T-1.0	TOPOGRAPHIC SURVEY
C-1.0	DEMOLITION PLAN
C-2.0	DIMENSION CONTROL PLAN
C-3.0	SITE IMPROVEMENT PLAN
C-4.0	GRADING AND DRAINAGE PLAN
C-4.1	SITE SECTIONS-1
C-4.2	SITE SECTIONS-2
C-4.3	SITE SECTIONS-3
C-5.0	STORMWATER MANAGEMENT PLAN
C-6.0	UTILITY PLAN
C-7.0	EROSION AND SEDIMENT CONTROL PLAN

PROPERTY DETAILS	
APN	071-080-007
AREA	3.83 AC
ZONING	CG
ADDRESS	NE CNR OF HWY- 49 & GEORGETOWN RD, COOL, CA 95614

PROJECT SCOPE OF WORK	
FUTURE CAR WASHING & EQUIPMENT ROOM	1892 SQ.FT
BUILDING (DRIVE THRU) & C-STORE SPACE	9787 SQ.FT
CONCRETE PAVEMENT	9049 SQ.FT
ASPHALT PAVEMENT	77687 SQ.FT
BUILDING CONSTRUCTION	
ONSITE REGULAR CAR PARKING	
ONSITE REGULAR CAR LOADING PARKING	
ONSITE ADA CAR PARKING	
SITE ENTRANCE	2
STORMWATER MANAGEMENT	

NOTE: REFER ARCHITECTURAL PLANS FOR EXACT SQUARE FOOTING OF BUILDINGS.

PROJECT DIRECTORY	
CIVIL ENGINEER OF RECORD: MANJIT SAINI, PE 597 ROUGH AND READY RD SAN JOSE, CA 95133 Phone: (408) 313-5400 Email: msaini@engco.com	ARCHITECTURE MHA DESIGN SERVICES 11584 FRANCIS DRIVE GRASS VALLEY, CA 95949 M.HIGGINBOTHAM Phone: (530) 263-5899 Email: melh.architecture@gmail.com
OWNER CONTACT: Phone: - - - - - Email: - - - - -	

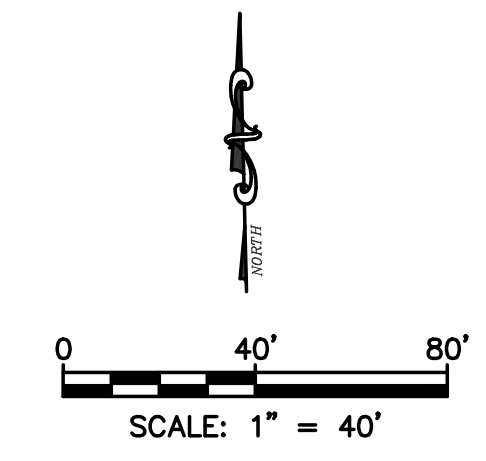

ENGINEERS NOTE TO CONTRACTOR:
THE EXISTENCE AND LOCATION OF ANY UNDERGROUND UTILITIES, PIPES, AND/OR STRUCTURES SHOWN ON THESE PLANS WERE OBTAINED BY A SEARCH OF AVAILABLE RECORDS. TO THE BEST OF OUR KNOWLEDGE, THERE ARE NO EXISTING UTILITIES EXCEPT AS SHOWN ON THESE PLANS. THE CONTRACTOR SHALL ASCERTAIN THE TRUE VERTICAL AND HORIZONTAL LOCATION OF THOSE UNDERGROUND UTILITIES TO BE USED AND SHALL BE RESPONSIBLE FOR ANY DAMAGE TO ANY PUBLIC OR PRIVATE UTILITIES, SHOWN OR NOT SHOWN HEREON. IF THE CONTRACTOR ENCOUNTERS ANY DISCREPANCIES, CONFLICTS OR AREAS WHICH HE FEELS UNWORKABLE, HE SHALL NOTIFY THE GRADING ENGINEER IMMEDIATELY PRIOR TO CONTINUING OR DEVIATING FROM THIS PLAN.

UNAUTHORIZED CHANGES & USES:
THE ENGINEER PREPARING THESE PLANS WILL NOT BE RESPONSIBLE FOR, OR LIABLE FOR, UNAUTHORIZED CHANGES TO OR USES OF THESE PLANS. ALL CHANGES TO THE PLANS MUST BE IN WRITING AND MUST BE APPROVED BY THE PREPARER OF THESE PLANS. CONSTRUCTION CONTRACTOR AGREES THAT IN ACCORDANCE WITH GENERALLY ACCEPTED CONSTRUCTION PRACTICES, CONSTRUCTION CONTRACTOR WILL BE REQUIRED TO ASSUME SOLE AND COMPLETE RESPONSIBILITY FOR JOB SITE CONDITIONS DURING THE COURSE OF CONSTRUCTION OF THE PROJECT, INCLUDING SAFETY OF ALL PERSONS AND PROPERTY, THAT THIS REQUIREMENT SHALL BE MADE TO APPLY CONTINUOUSLY AND NOT BE LIMITED TO NORMAL WORKING HOURS, AND CONSTRUCTION CONTRACTOR FURTHER AGREES TO DEFEND, INDEMNIFY AND HOLD DESIGN PROFESSIONAL HARMLESS FROM ANY AND ALL LIABILITY, REAL OR ALLEGED, IN CONNECTION WITH THE PERFORMANCE OF WORK ON THIS PROJECT, EXCEPTING LIABILITY ARISING FROM THE SOLE NEGLIGENCE OF DESIGN PROFESSIONAL.

UNDERGROUND SERVICE ALERT			
NO.	BY	DATE	REVISION

PREPARED BY:

Manjit Saini

PREPARED FOR:

**NE CNR OF HWY- 49
& GEORGETOWN RD
COOL, CA 95614
APN: 071-080-007**

TITLE:

COVER SHEET

DATE:	12/30/2022	SHEET NO.	
DESIGNED BY:	N.GORAYA		G-1.0
DRAWN BY:	P. SINGH		1 OF 12
CHECKED BY:	M. SAINI	REV.	0
APPROVED BY:	M. SAINI		

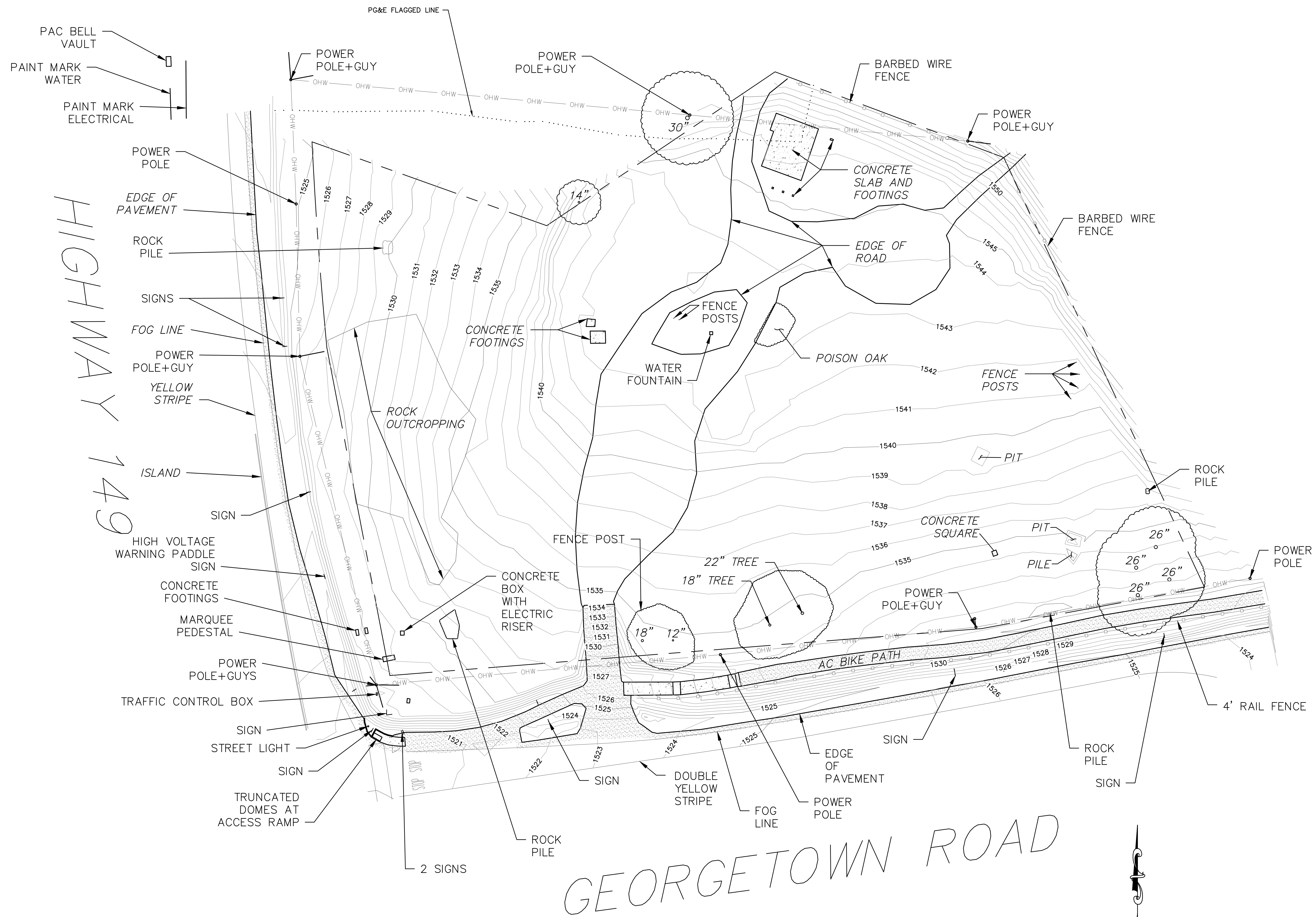

HIGHWAY 149

GEORGETOWN ROAD

AC BIKE PATH

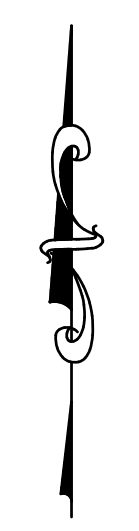
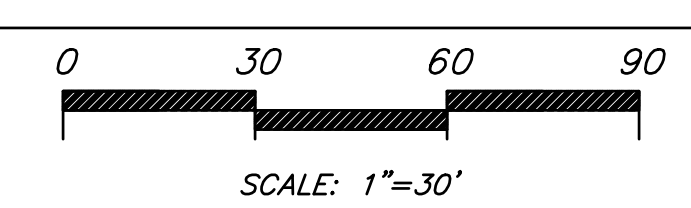

APN 071-080-007
COOL, CA

Drawn By:	RO
Date:	10/17/2021
Scale:	1"=30'
Job No.:	21-136
Checked:	

R. Olsen
ROY OLSEN LS9089
10/17/2021

T-1.0
SHEET
2
OF 8

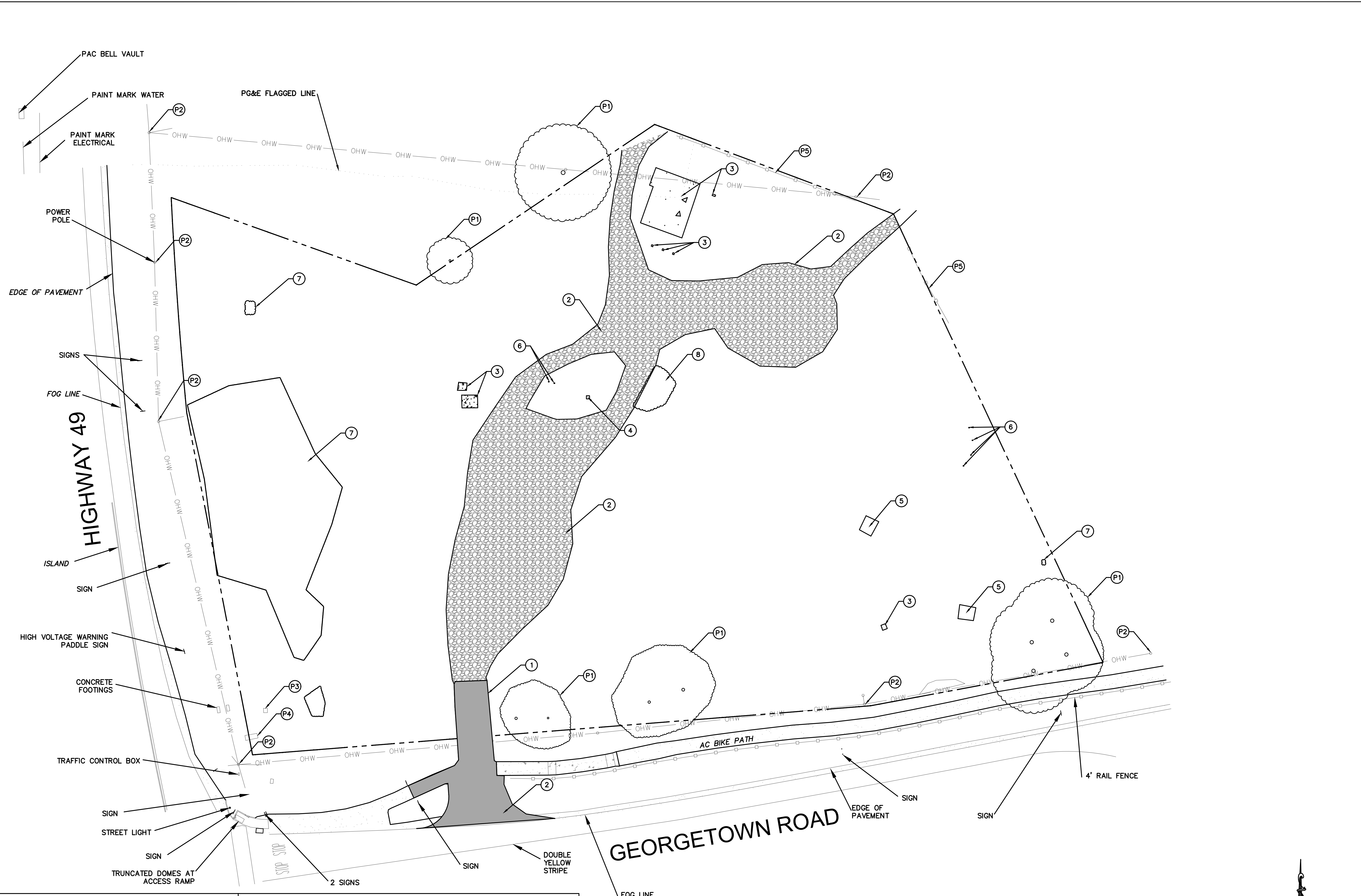

LEGEND

	BOUNDARY
	EX GRAVEL ROAD (22055 SQ.FT)
	EX ASPHALT ROAD (775 SQ.FT)
	EX CONCRETE
	EX AC BIKE PATH
	OHV
	OHWO
	MHO
	GUY WIRE
	SIGN
	TREE
	BARBED FENCE

- DEMOLITION KEY PLAN NOTES**
- ① DEMOLISH EX. ASPHALT ROAD.
 - ② DEMOLISH EX. GRAVEL ROAD.
 - ③ DEMOLISH EX. CONCRETE SLAB & FOOTING.
 - ④ DEMOLISH EX. WATER FOUNTAIN.
 - ⑤ DEMOLISH EX. PIT.
 - ⑥ REMOVE EX. FENCE POST.
 - ⑦ REMOVE EX. ROCK.
 - ⑧ REMOVE EX. POISON OAK TREE.

- PROTECT SITE FACILITIES**
- P1 EX. TREE TO REMAIN.
 - P2 EX. POWER POLE & GUY WIRE TO REMAIN.
 - P3 EX. CONCRETE BOX WITH ELECTRIC RISER TO REMAIN.
 - P4 EX. MARQUEE PEDESTAL TO REMAIN.
 - P5 EX. BARBED WIRE FENCE TO REMAIN.

ENGINEERS NOTE TO CONTRACTOR:
 THE EXISTENCE AND LOCATION OF ANY UNDERGROUND UTILITIES, PIPES, AND/OR STRUCTURES SHOWN ON THESE PLANS WERE OBTAINED BY A SEARCH OF AVAILABLE RECORDS. TO THE BEST OF OUR KNOWLEDGE, THERE ARE NO EXISTING UTILITIES EXCEPT AS SHOWN ON THESE PLANS. THE CONTRACTOR SHALL ASCERTAIN THE TRUE VERTICAL AND HORIZONTAL LOCATION OF THOSE UNDERGROUND UTILITIES TO BE USED AND SHALL BE RESPONSIBLE FOR ANY DAMAGE TO ANY PUBLIC OR PRIVATE UTILITIES, SHOWN OR NOT SHOWN HEREON. IF THE CONTRACTOR ENCOUNTERS ANY DISCREPANCIES, CONFLICTS OR AREAS WHICH HE FEELS UNWORKABLE, HE SHALL NOTIFY THE GRADING ENGINEER IMMEDIATELY PRIOR TO CONTINUING OR DEVIATING FROM THIS PLAN.

UNAUTHORIZED CHANGES & USES:
 THE ENGINEER PREPARING THESE PLANS WILL NOT BE RESPONSIBLE FOR, OR LIABLE FOR, UNAUTHORIZED CHANGES TO OR USES OF THESE PLANS. ALL CHANGES TO THE PLANS MUST BE IN WRITING AND MUST BE APPROVED BY THE PREPARER OF THESE PLANS. CONSTRUCTION CONTRACTOR AGREES THAT IN ACCORDANCE WITH GENERALLY ACCEPTED CONSTRUCTION PRACTICES, CONSTRUCTION CONTRACTOR WILL BE REQUIRED TO ASSUME SOLE AND COMPLETE RESPONSIBILITY FOR JOB SITE CONDITIONS DURING THE COURSE OF CONSTRUCTION OF THE PROJECT, INCLUDING SAFETY OF ALL PERSONS AND PROPERTY, THAT THIS REQUIREMENT SHALL BE MADE TO APPLY CONTINUOUSLY AND NOT BE LIMITED TO NORMAL WORKING HOURS, AND CONSTRUCTION CONTRACTOR FURTHER AGREES TO DEFEND, INDEMNIFY AND HOLD DESIGN PROFESSIONAL HARMLESS FROM ANY AND ALL LIABILITY, REAL OR ALLEGED, IN CONNECTION WITH THE PERFORMANCE OF WORK ON THIS PROJECT, EXCEPTING LIABILITY ARISING FROM THE SOLE NEGLIGENCE OF DESIGN PROFESSIONAL.

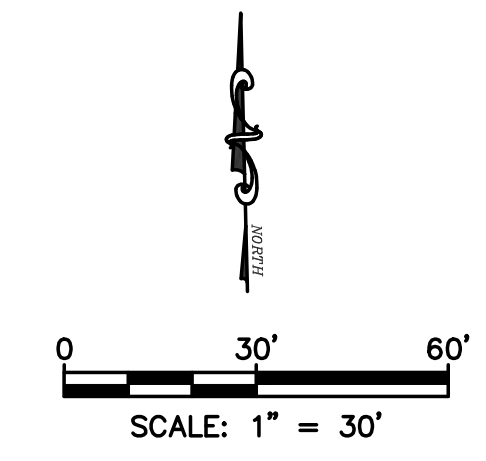

UNDERGROUND SERVICE ALERT

Call: TOLL FREE
1-800-227-2600

KNOW WHAT'S BELOW.
CALL BEFORE YOU DIG

TWO WORKING DAYS BEFORE YOU DIG

NO.	BY	DATE	REVISION

PREPARED BY:

Manjit Saini

PREPARED FOR:

**NE CNR OF HWY- 49
 & GEORGETOWN RD
 COOL, CA 95614
 APN: 071-080-007**

TITLE:

DEMOLITION PLAN

DATE:	12/30/2022	SHEET NO.	C-1.0
DESIGNED BY:	N.GORAYA	REV.	3 OF 12
DRAWN BY:	P. SINGH		0
CHECKED BY:	M. SAINI		
APPROVED BY:	M. SAINI		

LEGEND

SEE COVER SHEET.

CURVE TABLE				
CURVE #	RADIUS	LENGTH	CHORD DIRECTION	CHORD LENGTH
C1	20.00'	27.720'	N56° 10' 32"W	25.55'
C2	173.75'	16.945'	N13° 52' 29"W	16.94'
C3	104.19'	13.084'	N08° 17' 03"W	13.08'
C4	47.38'	5.001'	N00° 59' 09"W	5.00'
C5	16.78'	16.221'	N25° 15' 44"E	15.60'
C6	24.01'	6.439'	N61° 22' 09"E	6.42'
C7	50.00'	20.231'	N88° 26' 05"E	20.09'
C8	5.00'	5.818'	S46° 38' 12"E	5.50'
C9	4.50'	7.069'	N31° 50' 35"E	6.36'
C10	4.50'	7.069'	S58° 09' 25"E	6.36'
C11	5.00'	7.854'	N31° 50' 35"E	7.07'
C12	4.50'	7.069'	N58° 09' 25"W	6.36'
C13	4.50'	7.069'	N31° 50' 35"E	6.36'
C14	3.82'	11.649'	N13° 09' 25"W	7.63'
C15	100.00'	156.451'	N57° 58' 37"W	140.98'
C16	100.00'	36.955'	S66° 36' 59"W	36.74'
C17	30.00'	28.081'	S82° 50' 43"W	27.07'
C18	20.00'	7.883'	N81° 37' 51"W	7.83'
C19	20.00'	31.274'	N48° 07' 32"W	28.18'
C20	20.00'	32.073'	N41° 08' 08"E	28.75'
C21	15.00'	5.912'	S81° 37' 51"E	5.87'

CURVE TABLE				
CURVE #	RADIUS	LENGTH	CHORD DIRECTION	CHORD LENGTH
C22	3.00'	7.533'	S01° 35' 36"W	5.70'
C23	4.50'	7.142'	S59° 42' 34"E	6.42'
C24	4.50'	7.156'	S31° 17' 16"W	6.43'
C25	5.50'	17.459'	S14° 05' 16"E	11.00'
C26	20.01'	31.778'	S39° 59' 41"W	28.54'
C27	20.00'	31.416'	S58° 09' 25"E	28.28'
C28	10.00'	12.893'	S23° 46' 46"W	12.02'
C29	1.00'	1.852'	N66° 13' 14"W	1.60'
C30	6.00'	14.137'	S54° 20' 35"W	11.09'
C31	3.00'	7.069'	N09° 20' 35"E	5.54'
C32	2.00'	5.580'	N23° 13' 30"W	3.94'
C33	10.00'	3.514'	N66° 46' 30"E	3.50'
C35	3.00'	4.712'	N31° 50' 35"E	4.24'
C36	3.00'	4.712'	N58° 09' 25"W	4.24'
C37	2.00'	4.939'	N06° 05' 45"E	3.78'
C38	40.00'	26.882'	N83° 54' 15"W	26.38'
C39	20.00'	13.603'	S57° 21' 32"W	13.34'
C40	2.00'	4.923'	S32° 38' 28"E	3.77'
C41	32.00'	50.265'	S58° 09' 25"E	45.25'

LINE TABLE		
LINE #	LENGTH	DIRECTION
L1	10.48'	S84° 07' 07.07"W
L2	14.70'	N16° 28' 11.04"W
L3	74.70'	N76° 50' 08.11"E
L4	20.89'	S79° 58' 25.36"E
L5	46.43'	S13° 09' 26.81"E
L7	72.47'	N76° 50' 35.47"E
L8	15.50'	N13° 09' 24.53"W
L9	15.50'	S13° 09' 24.53"E
L10	72.00'	N76° 50' 35.47"E
L11	20.00'	N13° 09' 24.53"W
L12	25.84'	N76° 50' 35.47"E
L13	54.00'	N13° 09' 24.53"W
L14	15.50'	S76° 50' 35.47"W
L15	15.50'	N76° 50' 35.47"E
L16	28.37'	N13° 30' 28.65"W
L17	15.70'	S76° 50' 42.16"W
L18	15.88'	N76° 50' 28.57"E
L19	54.00'	N13° 09' 24.53"W
L20	20.00'	S76° 50' 35.47"W
L21	24.52'	N13° 09' 24.53"W
L22	109.03'	S77° 12' 11.47"W
L23	26.72'	S56° 01' 47.15"W
L24	146.99'	N70° 20' 20.45"W
L25	19.57'	S87° 04' 38.93"W
L26	9.86'	N87° 04' 38.93"E

LINE TABLE		
LINE #	LENGTH	DIRECTION
L52	45.50'	S13° 09' 24.53"E
L53	10.50'	S13° 09' 24.53"E
L54	18.65'	N76° 50' 08.11"E
L55	159.50'	S76° 50' 35.47"W
L56	37.50'	S76° 50' 35.47"W
L57	13.51'	S13° 09' 24.53"E
L58	22.82'	N58° 09' 24.53"W
L59	15.76'	N76° 50' 35.47"E
L60	54.00'	N13° 09' 24.53"W
L61	16.92'	S76° 50' 35.47"W
L62	11.65'	N56° 42' 24.78"E
L63	3.22'	N76° 50' 35.47"E
L64	6.00'	N76° 50' 35.47"E
L65	21.00'	S13° 09' 24.53"E
L66	22.00'	N76° 50' 35.47"E
L67	1.00'	N13° 09' 24.53"W
L68	17.00'	S76° 50' 35.47"W
L69	63.00'	N13° 09' 24.53"W
L70	14.27'	N76° 50' 35.47"E
L71	41.34'	N64° 39' 06.15"W
L72	171.88'	S76° 50' 35.47"W
L73	3.17'	S37° 52' 28.94"W
L74	185.40'	N76° 50' 35.47"E
L75	40.00'	S13° 09' 24.53"E

LINE TABLE		
LINE #	LENGTH	DIRECTION
L27	128.28'	S70° 20' 20.45"E
L28	16.70'	S76° 49' 33.38"W
L29	90.00'	S13° 09' 24.53"E
L30	15.34'	N76° 50' 35.47"E
L31	15.50'	S76° 50' 35.47"W
L32	81.00'	S13° 09' 24.53"E
L33	109.82'	N76° 50' 35.47"E
L34	47.33'	S76° 50' 35.47"W
L35	3.13'	S72° 50' 26.00"W
L36	3.93'	S69° 21' 10.74"W
L37	4.08'	S64° 55' 09.14"W
L38	4.05'	S59° 38' 39.20"W
L39	4.31'	S53° 15' 57.41"W
L40	4.56'	S46° 00' 35.76"W
L41	4.77'	S38° 21' 54.74"W
L42	5.16'	S30° 33' 07.07"W
L43	5.73'	S22° 54' 55.22"W
L44	6.43'	S15° 55' 04.87"W
L45	7.42'	S09° 46' 32.46"W
L46	8.45'	S04° 35' 15.17"W
L47	9.81'	S00° 17' 11.04"W
L48	11.11'	S03° 18' 05.08"E
L49	29.19'	S04° 16' 06.34"E
L50	2.03'	S86° 52' 38.11"W
L51	188.00'	N76° 50' 35.47"E

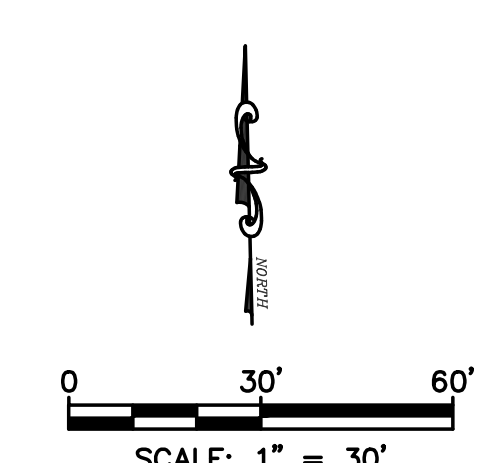
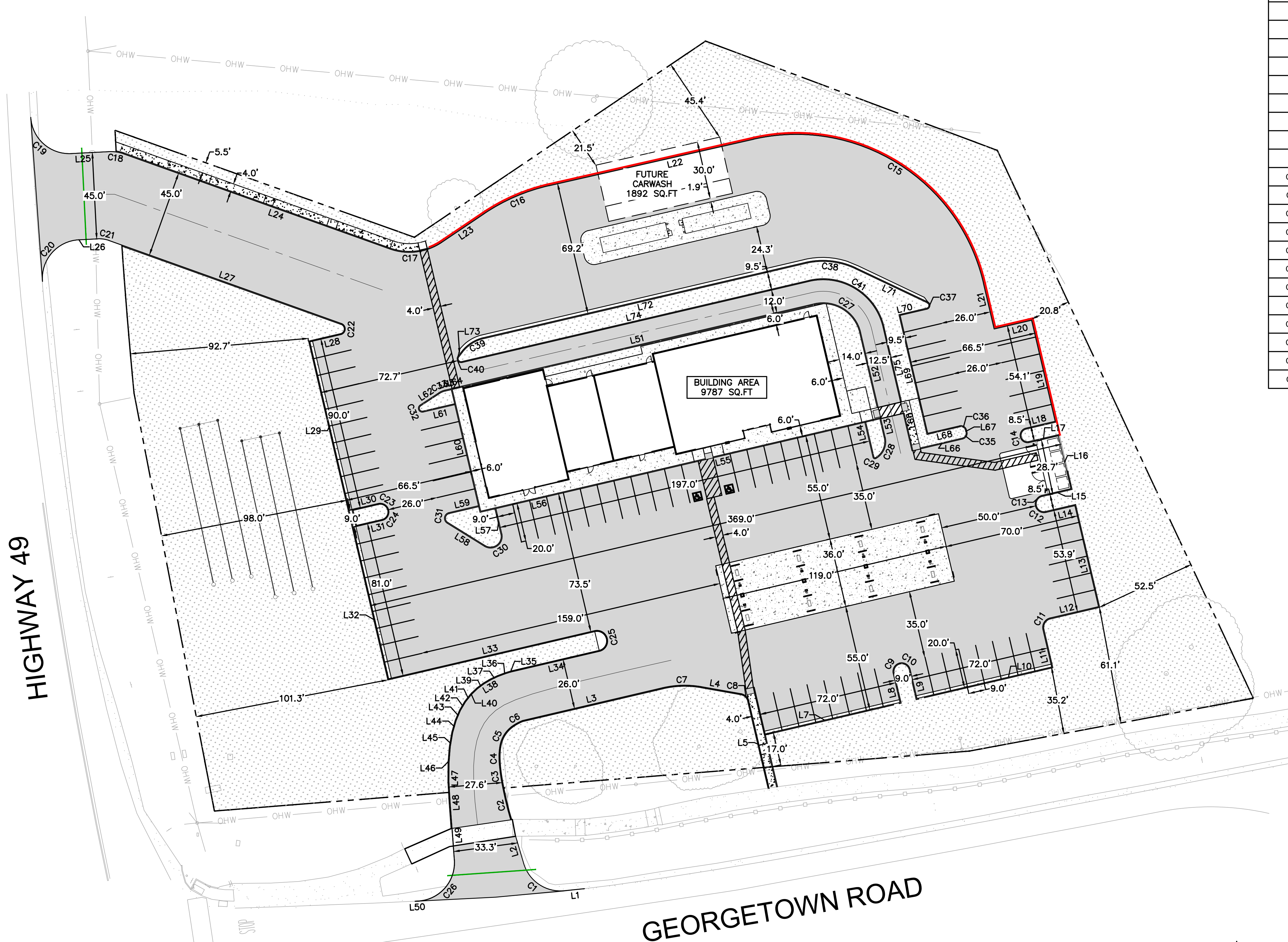

ENGINEERS NOTE TO CONTRACTOR:
 THE EXISTENCE AND LOCATION OF ANY UNDERGROUND UTILITIES, PIPES, AND/OR STRUCTURES SHOWN ON THESE PLANS WERE OBTAINED BY A SEARCH OF AVAILABLE RECORDS. TO THE BEST OF OUR KNOWLEDGE, THERE ARE NO EXISTING UTILITIES EXCEPT AS SHOWN ON THESE PLANS. THE CONTRACTOR SHALL ASCERTAIN THE TRUE VERTICAL AND HORIZONTAL LOCATION OF THOSE UNDERGROUND UTILITIES TO BE USED AND SHALL BE RESPONSIBLE FOR ANY DAMAGE TO ANY PUBLIC OR PRIVATE UTILITIES, SHOWN OR NOT SHOWN HEREON. IF THE CONTRACTOR ENCOUNTERS ANY DISCREPANCIES, CONFLICTS OR AREAS WHICH HE FEELS UNWORKABLE, HE SHALL NOTIFY THE GRADING ENGINEER IMMEDIATELY PRIOR TO CONTINUING OR DEVIATING FROM THIS PLAN.

UNAUTHORIZED CHANGES & USES:
 THE ENGINEER PREPARING THESE PLANS WILL NOT BE RESPONSIBLE FOR, OR LIABLE FOR, UNAUTHORIZED CHANGES TO OR USES OF THESE PLANS. ALL CHANGES TO THE PLANS MUST BE IN WRITING AND MUST BE APPROVED BY THE PREPARER OF THESE PLANS. CONSTRUCTION CONTRACTOR AGREES THAT IN ACCORDANCE WITH GENERALLY ACCEPTED CONSTRUCTION PRACTICES, CONSTRUCTION CONTRACTOR WILL BE REQUIRED TO ASSUME SOLE AND COMPLETE RESPONSIBILITY FOR JOB SITE CONDITIONS DURING THE COURSE OF CONSTRUCTION OF THE PROJECT, INCLUDING SAFETY OF ALL PERSONS AND PROPERTY, THAT THIS REQUIREMENT SHALL BE MADE TO APPLY CONTINUOUSLY AND NOT BE LIMITED TO NORMAL WORKING HOURS, AND CONSTRUCTION CONTRACTOR FURTHER AGREES TO DEFEND, INDEMNIFY AND HOLD DESIGN PROFESSIONAL HARMLESS FROM ANY AND ALL LIABILITY, REAL OR ALLEGED, IN CONNECTION WITH THE PERFORMANCE OF WORK ON THIS PROJECT, EXCEPTING LIABILITY ARISING FROM THE SOLE NEGLIGENCE OF DESIGN PROFESSIONAL.

UNDERGROUND SERVICE ALERT			
NO.	BY	DATE	REVISION

PREPARED BY:

Manjit Saini

PREPARED FOR:







**NE CNR OF HWY- 49
 & GEORGETOWN RD
 COOL, CA 95614
 APN: 071-080-007**

TITLE:

DIMENSION CONTROL PLAN

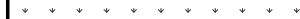
DATE:	12/30/2022	SHEET NO.	C-2.0
DESIGNED BY:	N.GORAYA		4 OF 12
DRAWN BY:	P. SINGH	REV.	0
CHECKED BY:	M. SAINI		
APPROVED BY:	M. SAINI		

LEGEND

-  BOUNDARY
-  LANDSCAPE
-  ASPHALT
-  CONCRETE
-  LEACH LINES
-  CULVERT

KEY PLAN NOTES

- 1 ASPHALT PAVEMENT.
- 2 TYPE-4 BARRIER CURB PER COUNTY OF EL DORADO STANDARD PLAN 104.
- 3 CONCRETE SIDEWALK WITH 2.0% MAX. CROSS SLOPE AND 5.0% MAX. LONGITUDINAL SLOPE.
- 4 ACCESSIBLE PATH OF TRAVEL WITH 5.0% MAX. LONGITUDINAL SLOPE AND 2.0% MAX. TRANSVERSE SLOPE.
- 5 DEPRESSED CURB & TRUNCATED DOMES/ DETECTABLE WARNINGS MIN. 3" DEEP PER CBC CODE.
- 6 ACCESSIBLE PARKING STALL, ACCESSIBLE AISLE, WHEELSTOP & SIGN R-99.
- 7 ACCESSIBLE CURB RAMP PER CBC CODE.
- 8 WHEEL STOP.
- 9 4" WHITE PARKING STALL STRIPE.
- 10 3' CURB CUT.
- 11 LANDSCAPE IMPROVEMENT AREA.
- 12 GAS CANOPY (REFER ARCHITECTURE PLANS).
- 13 ABOVE GROUND FUEL TANKS (REFER ARCHITECTURE PLANS/FUEL PLANS).
- 14 FUTURE CARWASH.
- 15 DRIVEWAY PER COUNTY STANDARD DRAWING 103C.
- 16 CONSTRUCT TYPE-2 VERTICAL CURB & GUTTER PER COUNTY OF EL DORADO STANDARD PLAN 104.
- 17 RETAINING WALL FOR DETAIL REFER ARCHITECTURE/STRUCTURAL PLAN.
- 18 12" RCP STORM DRAIN.

PROPOSED CONDITIONS AREA DESCRIPTION

AREA	AC	SQ FT
TOTAL LOT AREA	3.83	166,795
TOTAL DRAINAGE AREA	3.83	166,795
IMPERVIOUS AREA		
ASPHALT	1.78	77,687
CONCRETE (WALKWAY, CURB, UST & FUEL CANOPY)	0.21	9,049
BUILDING AREA (C-STORE, QSR, VISITOR CENTER)	0.22	9,787
FUTURE CARWASH	0.04	1,892
TOTAL IMPERVIOUS AREA	2.26	98,415
PERVIOUS AREA		
LANDSCAPE AREA	1.57	68,380

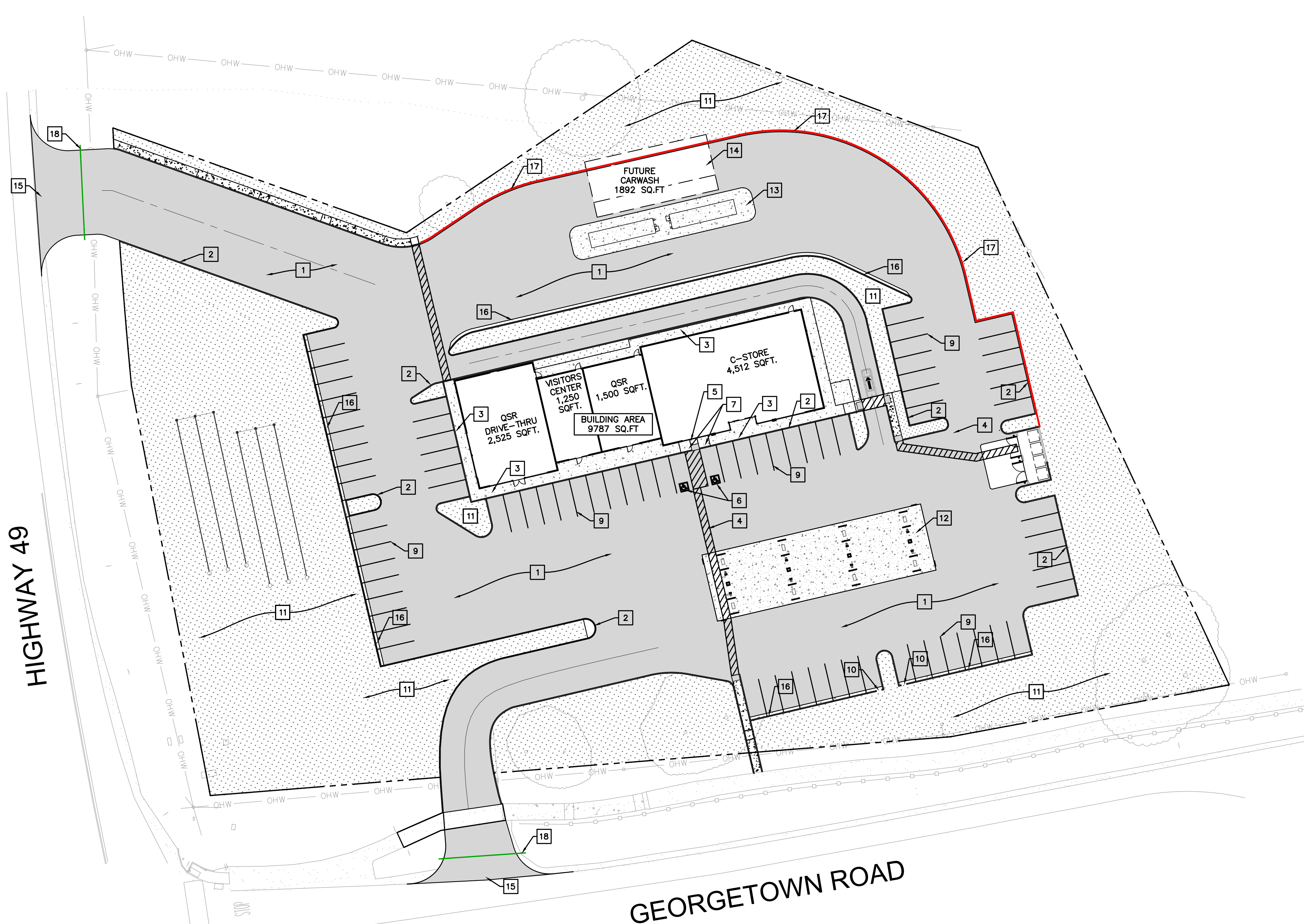

ENGINEERS NOTE TO CONTRACTOR:
 THE EXISTENCE AND LOCATION OF ANY UNDERGROUND UTILITIES, PIPES, AND/OR STRUCTURES SHOWN ON THESE PLANS WERE OBTAINED BY A SEARCH OF AVAILABLE RECORDS. TO THE BEST OF OUR KNOWLEDGE, THERE ARE NO EXISTING UTILITIES EXCEPT AS SHOWN ON THESE PLANS. THE CONTRACTOR SHALL ASCERTAIN THE TRUE VERTICAL AND HORIZONTAL LOCATION OF THOSE UNDERGROUND UTILITIES TO BE USED AND SHALL BE RESPONSIBLE FOR ANY DAMAGE TO ANY PUBLIC OR PRIVATE UTILITIES, SHOWN OR NOT SHOWN HEREON. IF THE CONTRACTOR ENCOUNTERS ANY DISCREPANCIES, CONFLICTS OR AREAS WHICH HE FEELS UNWORKABLE, HE SHALL NOTIFY THE GRADING ENGINEER IMMEDIATELY PRIOR TO CONTINUING OR DEVIATING FROM THIS PLAN.

UNAUTHORIZED CHANGES & USES:
 THE ENGINEER PREPARING THESE PLANS WILL NOT BE RESPONSIBLE FOR, OR LIABLE FOR, UNAUTHORIZED CHANGES TO OR USES OF THESE PLANS. ALL CHANGES TO THE PLANS MUST BE IN WRITING AND MUST BE APPROVED BY THE PREPARER OF THESE PLANS. CONSTRUCTION CONTRACTOR AGREES THAT IN ACCORDANCE WITH GENERALLY ACCEPTED CONSTRUCTION PRACTICES, CONSTRUCTION CONTRACTOR WILL BE REQUIRED TO ASSUME SOLE AND COMPLETE RESPONSIBILITY FOR JOB SITE CONDITIONS DURING THE COURSE OF CONSTRUCTION OF THE PROJECT, INCLUDING SAFETY OF ALL PERSONS AND PROPERTY, THAT THIS REQUIREMENT SHALL BE MADE TO APPLY CONTINUOUSLY AND NOT BE LIMITED TO NORMAL WORKING HOURS, AND CONSTRUCTION CONTRACTOR FURTHER AGREES TO DEFEND, INDEMNIFY AND HOLD DESIGN PROFESSIONAL HARMLESS FROM ANY AND ALL LIABILITY, REAL OR ALLEGED, IN CONNECTION WITH THE PERFORMANCE OF WORK ON THIS PROJECT, EXCEPTING LIABILITY ARISING FROM THE SOLE NEGLIGENCE OF DESIGN PROFESSIONAL.

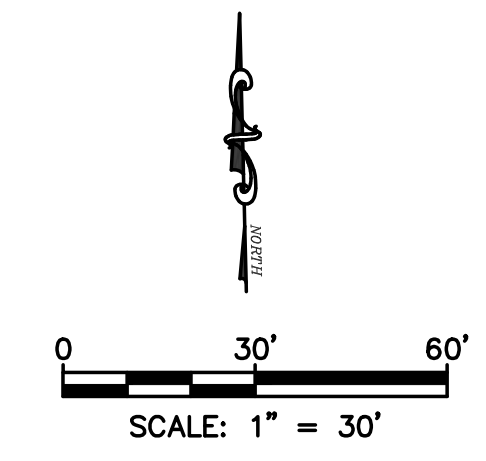

UNDERGROUND SERVICE ALERT			
 Call: TOLL FREE 1-800-227-2600 KNOW WHAT'S BELOW. CALL BEFORE YOU DIG TWO WORKING DAYS BEFORE YOU DIG			
NO.	BY	DATE	REVISION

PREPARED BY:



Manjit Saini

PREPARED FOR:

**NE CNR OF HWY- 49
 & GEORGETOWN RD
 COOL, CA 95614
 APN: 071-080-007**

TITLE:

SITE IMPROVEMENT PLAN

DATE:	12/30/2022	SHEET NO.	5 OF 12
DESIGNED BY:	N.GORAYA	REV.	0
DRAWN BY:	P. SINGH		
CHECKED BY:	M. SAINI		
APPROVED BY:	M. SAINI		

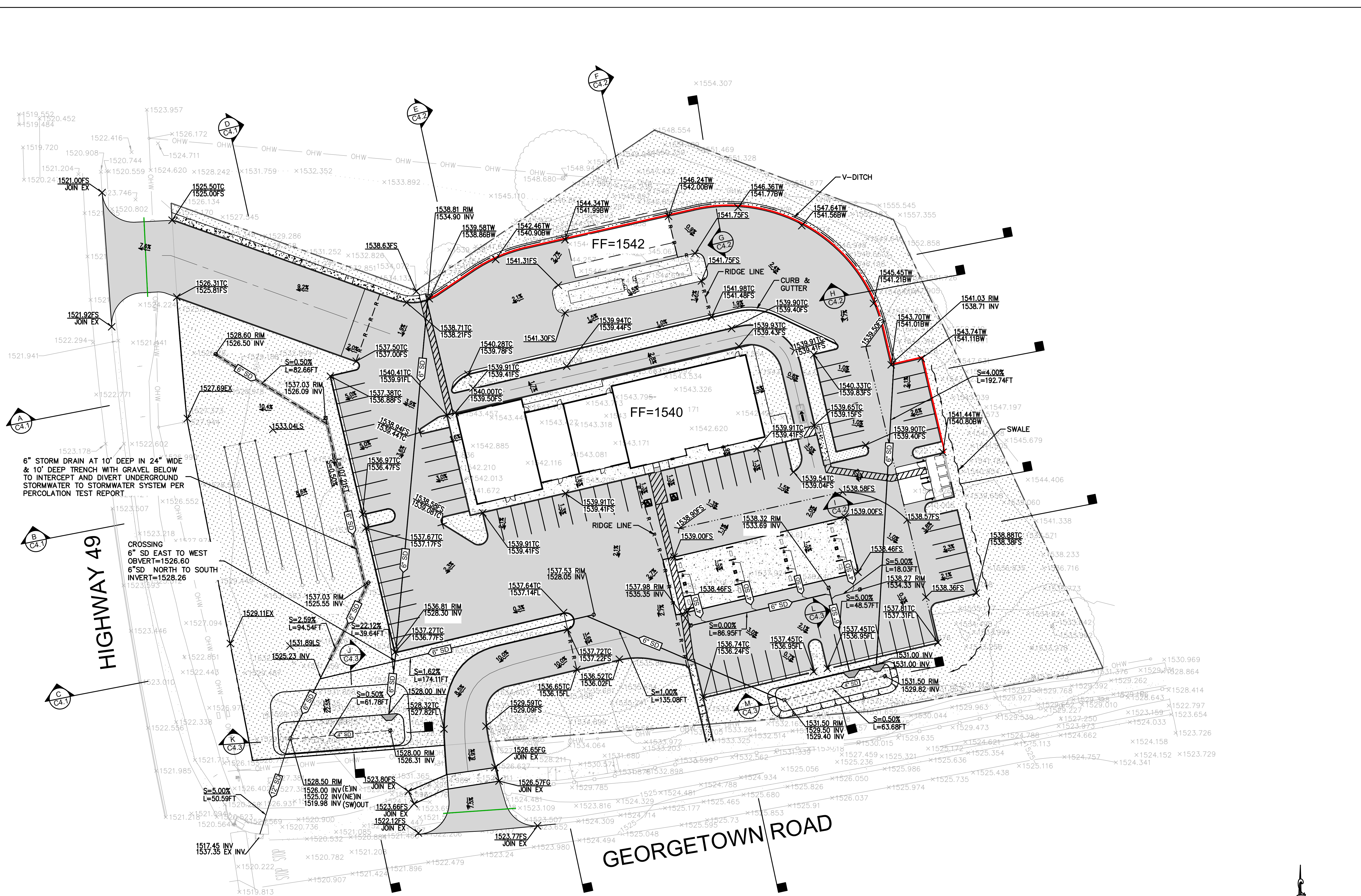

LEGEND

	BOUNDARY
	LANDSCAPE
	ASPHALT
	CONCRETE
	BIORETENTION
	LEACH LINES
	CULVERT
	STORM DRAIN STORM DRAIN PERFORATED STORM DRAIN
	CATCH BASIN
	STORM CLEANOUT
	SWALE
	FLOW LINE
	RIDGE LINE
	RETAINING WALL
	SLOPE
	EXISTING ELEVATION NEW ELEVATION

ABBREVIATIONS

A.B.	AGGREGATE BASE
A.C.	ASPHALT CONCRETE
BW	BOTTOM OF WALL
C & G	CURB AND GUTTER
ELEV.	ELEVATION
EX.	EXISTING
FF	FINISH FLOOR
FL	FLOWLINE
FG	FINISHED GRADE
FS	FINISH SURFACE
INV.	PIPE INVERT ELEVATION
(N)	NEW
T.C.	TOP OF CURB
T.W.	TOP OF WALL ELEVATION
V	VERTICAL
+ -	PLUS OR MINUS (NOT EXACT)

6" STORM DRAIN AT 10' DEEP IN 24" WIDE & 10' DEEP TRENCH WITH GRAVEL BELOW TO INTERCEPT AND DIVERT UNDERGROUND STORMWATER TO STORMWATER SYSTEM PER PERCOLATION TEST REPORT

CROSSING
6" SD EAST TO WEST
OBVERT=1526.60
6" SD NORTH TO SOUTH
INVERT=1526.26

ENGINEERS NOTE TO CONTRACTOR:
THE EXISTENCE AND LOCATION OF ANY UNDERGROUND UTILITIES, PIPES, AND/OR STRUCTURES SHOWN ON THESE PLANS WERE OBTAINED BY A SEARCH OF AVAILABLE RECORDS. TO THE BEST OF OUR KNOWLEDGE, THERE ARE NO EXISTING UTILITIES EXCEPT AS SHOWN ON THESE PLANS. THE CONTRACTOR SHALL ASCERTAIN THE TRUE VERTICAL AND HORIZONTAL LOCATION OF THOSE UNDERGROUND UTILITIES TO BE USED AND SHALL BE RESPONSIBLE FOR ANY DAMAGE TO ANY PUBLIC OR PRIVATE UTILITIES, SHOWN OR NOT SHOWN HEREON. IF THE CONTRACTOR ENCOUNTERS ANY DISCREPANCIES, CONFLICTS OR AREAS WHICH HE FEELS UNWORKABLE, HE SHALL NOTIFY THE GRADING ENGINEER IMMEDIATELY PRIOR TO CONTINUING OR DEVIATING FROM THIS PLAN.

UNAUTHORIZED CHANGES & USES:
THE ENGINEER PREPARING THESE PLANS WILL NOT BE RESPONSIBLE FOR, OR LIABLE FOR, UNAUTHORIZED CHANGES TO OR USES OF THESE PLANS. ALL CHANGES TO THE PLANS MUST BE IN WRITING AND MUST BE APPROVED BY THE PREPARER OF THESE PLANS. CONSTRUCTION CONTRACTOR AGREES THAT IN ACCORDANCE WITH GENERALLY ACCEPTED CONSTRUCTION PRACTICES, CONSTRUCTION CONTRACTOR WILL BE REQUIRED TO ASSUME SOLE AND COMPLETE RESPONSIBILITY FOR JOB SITE CONDITIONS DURING THE COURSE OF CONSTRUCTION OF THE PROJECT, INCLUDING SAFETY OF ALL PERSONS AND PROPERTY, THAT THIS REQUIREMENT SHALL BE MADE TO APPLY CONTINUOUSLY AND NOT BE LIMITED TO NORMAL WORKING HOURS, AND CONSTRUCTION CONTRACTOR FURTHER AGREES TO DEFEND, INDEMNIFY AND HOLD DESIGN PROFESSIONAL HARMLESS FROM ANY AND ALL LIABILITY, REAL OR ALLEGED, IN CONNECTION WITH THE PERFORMANCE OF WORK ON THIS PROJECT, EXCEPTING LIABILITY ARISING FROM THE SOLE NEGLIGENCE OF DESIGN PROFESSIONAL.

UNDERGROUND SERVICE ALERT			
NO.	BY	DATE	REVISION

PREPARED BY:

Manjit Saini

PREPARED FOR:

**NE CNR OF HWY- 49
& GEORGETOWN RD
COOL, CA 95614
APN: 071-080-007**

TITLE:

GRADING & DRAINAG PLAN

DATE:	12/30/2022	SHEET NO.	
DESIGNED BY:	N.GORAYA		C-4.0
DRAWN BY:	P. SINGH		6 OF 12
CHECKED BY:	M. SAINI	REV.	0
APPROVED BY:	M. SAINI		

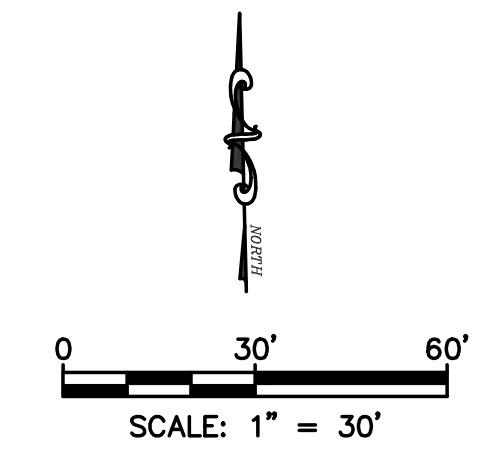

LEGEND

- EXISTING GROUND
- NEW GROUND

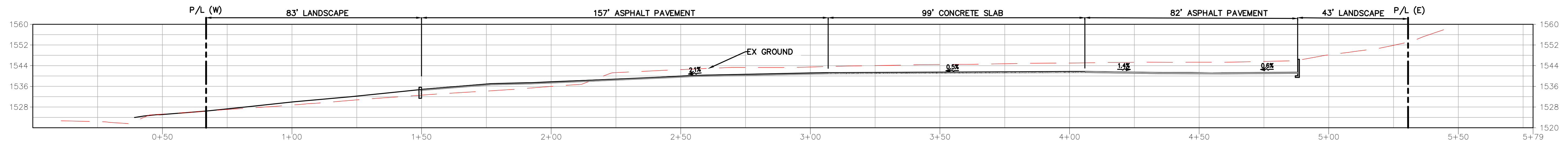

SECTION (A)
 HORIZONTAL SCALE: 1"=20'
 VERTICAL SCALE: 1"=20'

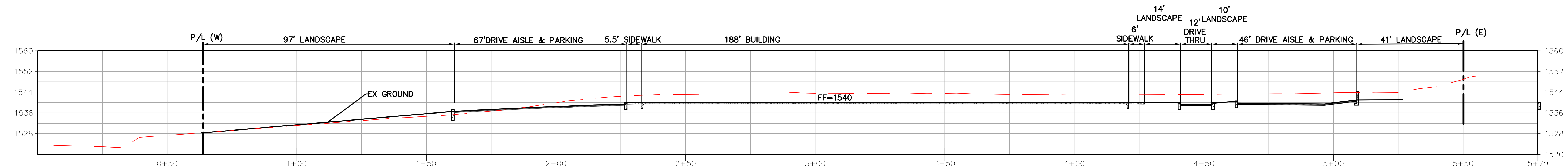

SECTION (B)
 HORIZONTAL SCALE: 1"=20'
 VERTICAL SCALE: 1"=20'

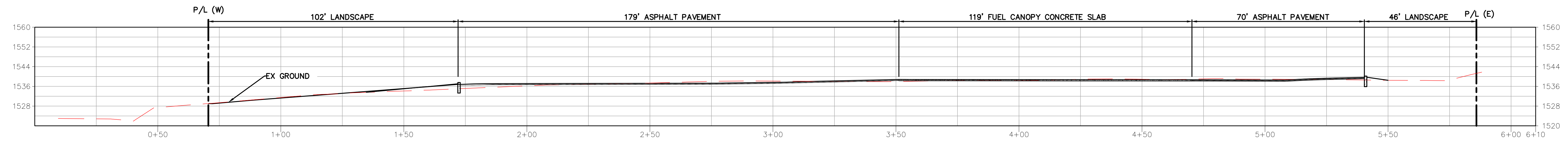

SECTION (C)
 HORIZONTAL SCALE: 1"=20'
 VERTICAL SCALE: 1"=20'

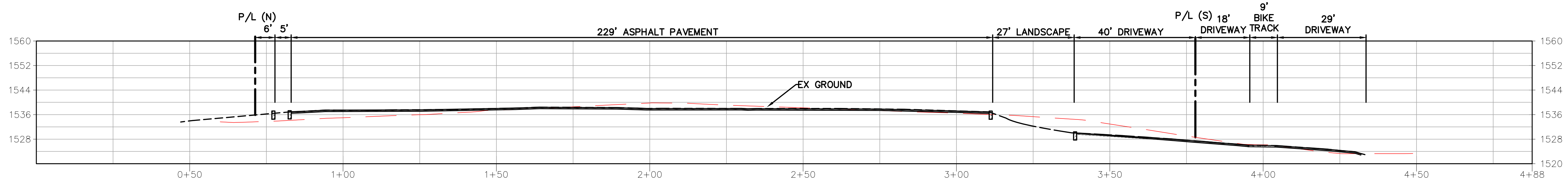

SECTION (D)
 HORIZONTAL SCALE: 1"=20'
 VERTICAL SCALE: 1"=20'

ENGINEERS NOTE TO CONTRACTOR:
 THE EXISTENCE AND LOCATION OF ANY UNDERGROUND UTILITIES, PIPES, AND/OR STRUCTURES SHOWN ON THESE PLANS WERE OBTAINED BY A SEARCH OF AVAILABLE RECORDS. TO THE BEST OF OUR KNOWLEDGE, THERE ARE NO EXISTING UTILITIES EXCEPT AS SHOWN ON THESE PLANS. THE CONTRACTOR SHALL ASCERTAIN THE TRUE VERTICAL AND HORIZONTAL LOCATION OF THOSE UNDERGROUND UTILITIES TO BE USED AND SHALL BE RESPONSIBLE FOR ANY DAMAGE TO ANY PUBLIC OR PRIVATE UTILITIES, SHOWN OR NOT SHOWN HEREON. IF THE CONTRACTOR ENCOUNTERS ANY DISCREPANCIES, CONFLICTS OR AREAS WHICH HE FEELS UNWORKABLE, HE SHALL NOTIFY THE GRADING ENGINEER IMMEDIATELY PRIOR TO CONTINUING OR DEVIATING FROM THIS PLAN.

UNAUTHORIZED CHANGES & USES:
 THE ENGINEER PREPARING THESE PLANS WILL NOT BE RESPONSIBLE FOR, OR LIABLE FOR, UNAUTHORIZED CHANGES TO OR USES OF THESE PLANS. ALL CHANGES TO THE PLANS MUST BE IN WRITING AND MUST BE APPROVED BY THE PREPARER OF THESE PLANS. CONSTRUCTION CONTRACTOR AGREES THAT IN ACCORDANCE WITH GENERALLY ACCEPTED CONSTRUCTION PRACTICES, CONSTRUCTION CONTRACTOR WILL BE REQUIRED TO ASSUME SOLE AND COMPLETE RESPONSIBILITY FOR JOB SITE CONDITIONS DURING THE COURSE OF CONSTRUCTION OF THE PROJECT, INCLUDING SAFETY OF ALL PERSONS AND PROPERTY, THAT THIS REQUIREMENT SHALL BE MADE TO APPLY CONTINUOUSLY AND NOT BE LIMITED TO NORMAL WORKING HOURS, AND CONSTRUCTION CONTRACTOR FURTHER AGREES TO DEFEND, INDEMNIFY AND HOLD DESIGN PROFESSIONAL HARMLESS FROM ANY AND ALL LIABILITY, REAL OR ALLEGED, IN CONNECTION WITH THE PERFORMANCE OF WORK ON THIS PROJECT, EXCEPTING LIABILITY ARISING FROM THE SOLE NEGLIGENCE OF DESIGN PROFESSIONAL.

UNDERGROUND SERVICE ALERT			
Call: TOLL FREE 1-800-227-2600 KNOW WHAT'S BELOW. CALL BEFORE YOU DIG TWO WORKING DAYS BEFORE YOU DIG			
NO.	BY	DATE	REVISION

PREPARED BY:

Manjit Saini

PREPARED FOR:

**NE CNR OF HWY- 49
 & GEORGETOWN RD
 COOL, CA 95614
 APN: 071-080-007**

TITLE:

SITE SECTIONS-1

DATE:	12/30/2022	SHEET NO.	7 OF 12
DESIGNED BY:	N.GORAYA	REV.	0
DRAWN BY:	P. SINGH		
CHECKED BY:	M. SAINI		
APPROVED BY:	M. SAINI		

LEGEND

- EXISTING GROUND
- NEW GROUND

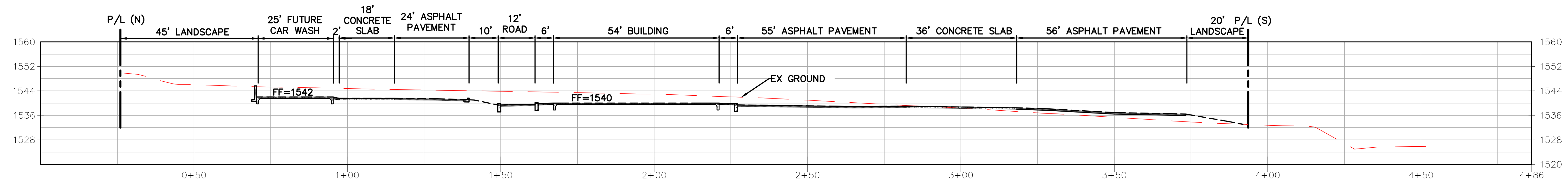

SECTION (E)
HORIZONTAL SCALE: 1"=20'
VERTICAL SCALE: 1"=20'

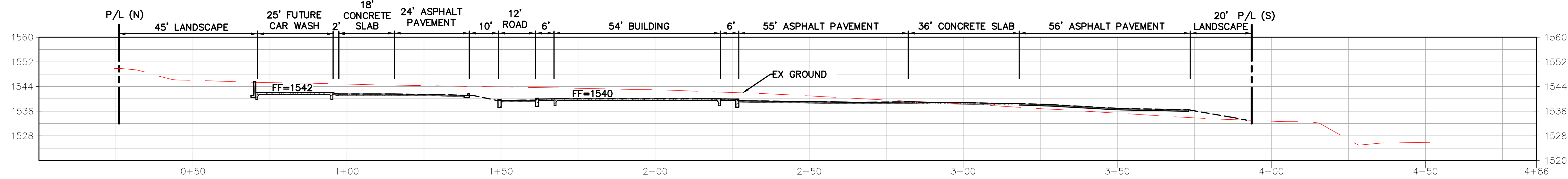

SECTION (F)
HORIZONTAL SCALE: 1"=20'
VERTICAL SCALE: 1"=20'

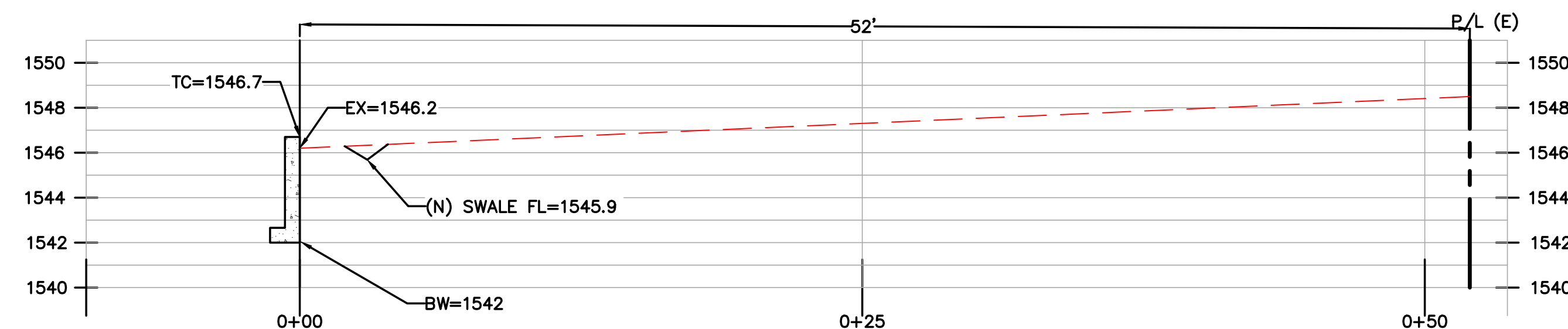

SECTION (G)
HORIZONTAL SCALE: 1"=5'
VERTICAL SCALE: 1"=5'

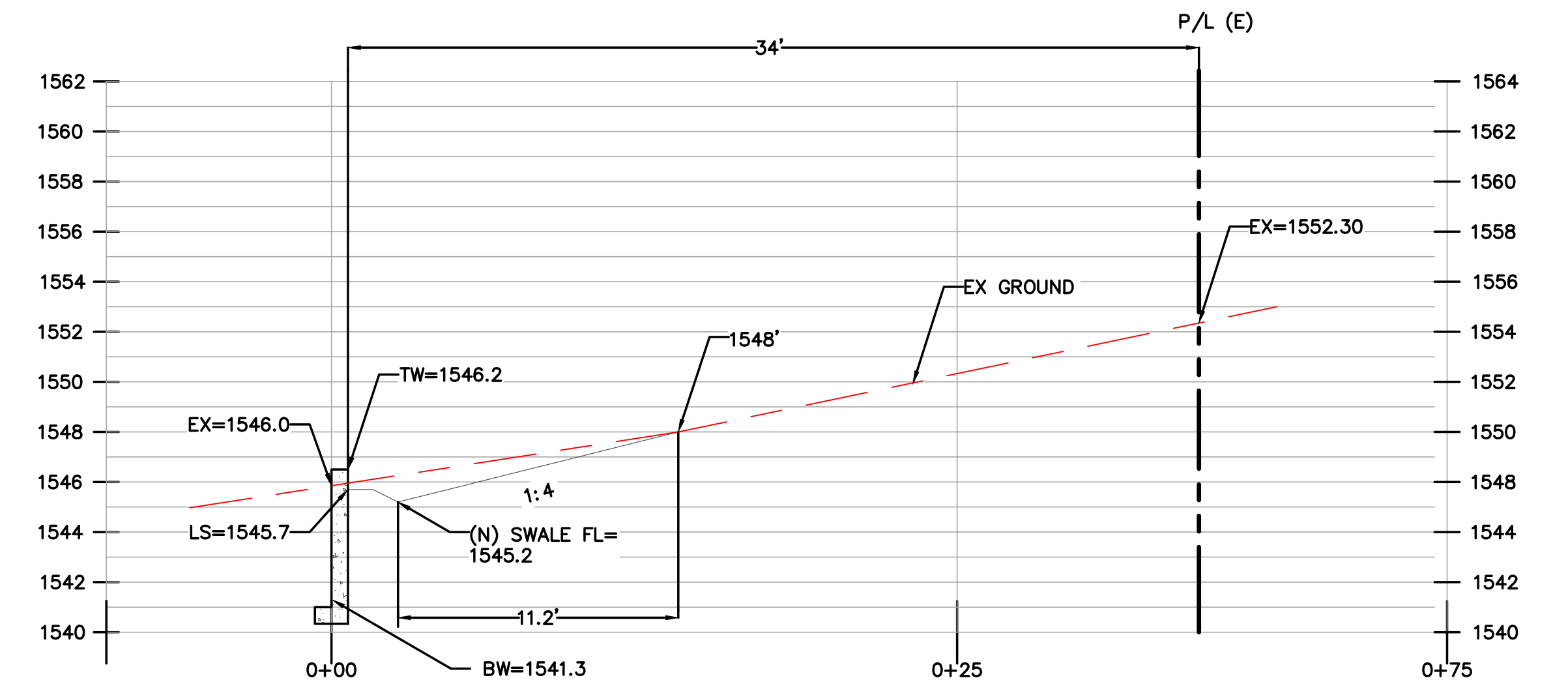

SECTION (H)
HORIZONTAL SCALE: 1"=5'
VERTICAL SCALE: 1"=5'

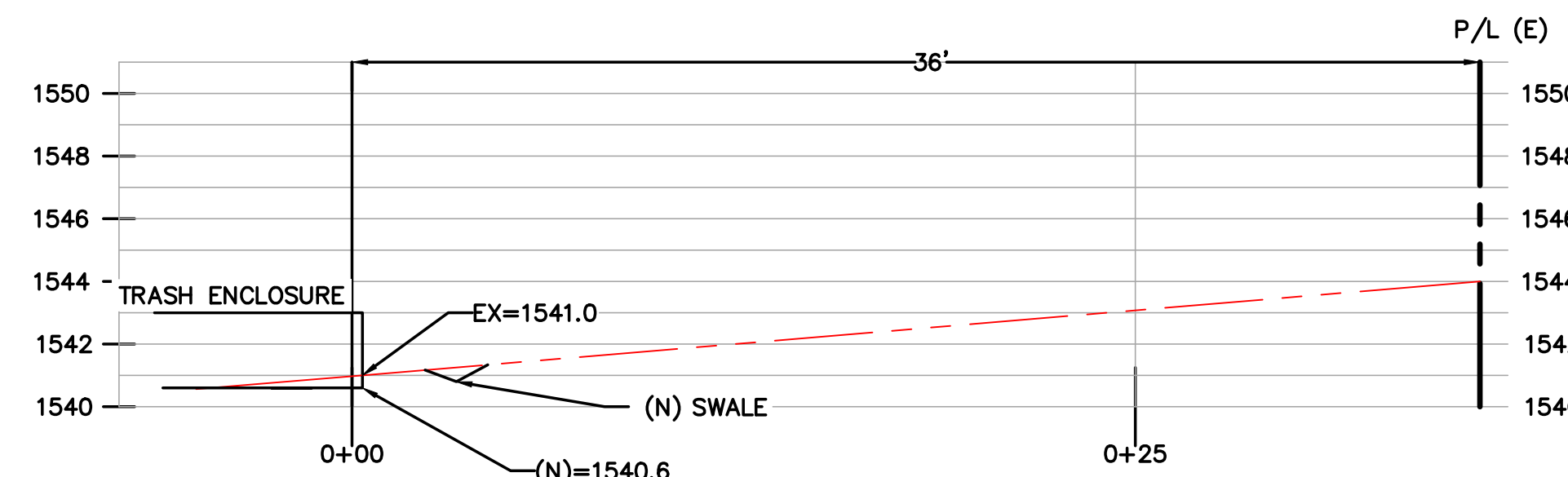

SECTION (I)
HORIZONTAL SCALE: 1"=5'
VERTICAL SCALE: 1"=5'

ENGINEERS NOTE TO CONTRACTOR:
THE EXISTENCE AND LOCATION OF ANY UNDERGROUND UTILITIES, PIPES, AND/OR STRUCTURES SHOWN ON THESE PLANS WERE OBTAINED BY A SEARCH OF AVAILABLE RECORDS. TO THE BEST OF OUR KNOWLEDGE, THERE ARE NO EXISTING UTILITIES EXCEPT AS SHOWN ON THESE PLANS. THE CONTRACTOR SHALL ASCERTAIN THE TRUE VERTICAL AND HORIZONTAL LOCATION OF THOSE UNDERGROUND UTILITIES TO BE USED AND SHALL BE RESPONSIBLE FOR ANY DAMAGE TO ANY PUBLIC OR PRIVATE UTILITIES, SHOWN OR NOT SHOWN HEREON. IF THE CONTRACTOR ENCOUNTERS ANY DISCREPANCIES, CONFLICTS OR AREAS WHICH HE FEELS UNWORKABLE, HE SHALL NOTIFY THE GRADING ENGINEER IMMEDIATELY PRIOR TO CONTINUING OR DEVIATING FROM THIS PLAN.

UNAUTHORIZED CHANGES & USES:
THE ENGINEER PREPARING THESE PLANS WILL NOT BE RESPONSIBLE FOR, OR LIABLE FOR, UNAUTHORIZED CHANGES TO OR USES OF THESE PLANS. ALL CHANGES TO THE PLANS MUST BE IN WRITING AND MUST BE APPROVED BY THE PREPARER OF THESE PLANS. CONSTRUCTION CONTRACTOR AGREES THAT IN ACCORDANCE WITH GENERALLY ACCEPTED CONSTRUCTION PRACTICES, CONSTRUCTION CONTRACTOR WILL BE REQUIRED TO ASSUME SOLE AND COMPLETE RESPONSIBILITY FOR JOB SITE CONDITIONS DURING THE COURSE OF CONSTRUCTION OF THE PROJECT, INCLUDING SAFETY OF ALL PERSONS AND PROPERTY, THAT THIS REQUIREMENT SHALL BE MADE TO APPLY CONTINUOUSLY AND NOT BE LIMITED TO NORMAL WORKING HOURS, AND CONSTRUCTION CONTRACTOR FURTHER AGREES TO DEFEND, INDEMNIFY AND HOLD DESIGN PROFESSIONAL HARMLESS FROM ANY AND ALL LIABILITY, REAL OR ALLEGED, IN CONNECTION WITH THE PERFORMANCE OF WORK ON THIS PROJECT, EXCEPTING LIABILITY ARISING FROM THE SOLE NEGLIGENCE OF DESIGN PROFESSIONAL.

UNDERGROUND SERVICE ALERT			
NO.	BY	DATE	REVISION

PREPARED BY:

Manjit Saini

PREPARED FOR:

**NE CNR OF HWY- 49
& GEORGETOWN RD
COOL, CA 95614
APN: 071-080-007**

TITLE:

SITE SECTION-2

DATE:	12/30/2022	SHEET NO.	8 OF 12
DESIGNED BY:	N.GORAYA	REV.	0
DRAWN BY:	P. SINGH		
CHECKED BY:	M. SAINI		
APPROVED BY:	M. SAINI		



LEGEND

- EXISTING GROUND
- NEW GROUND

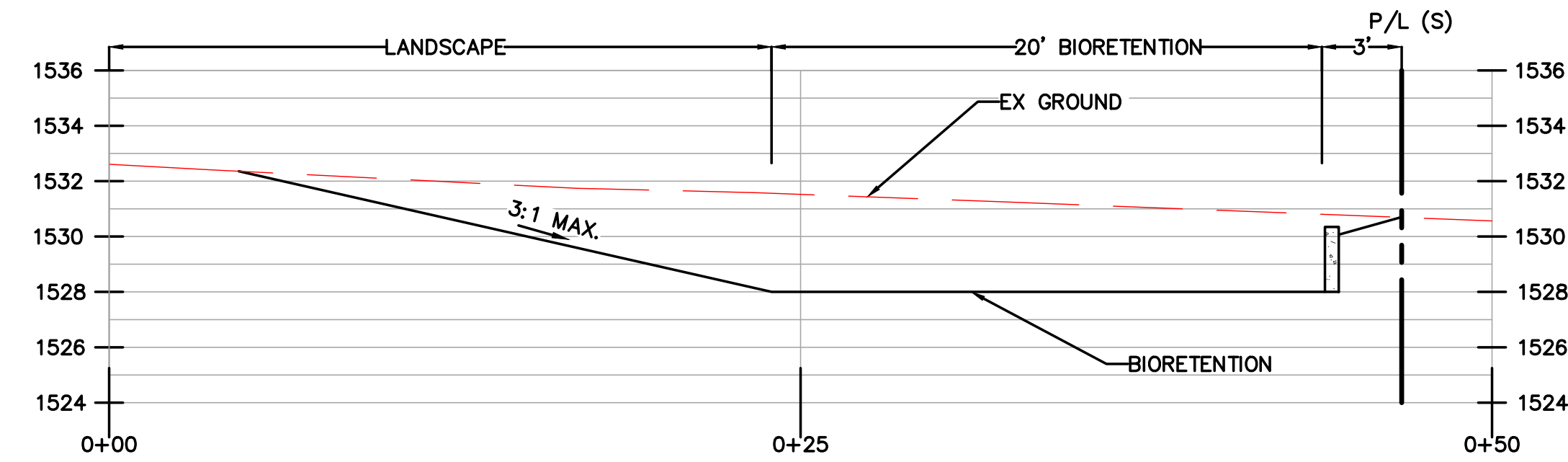

SECTION (J)
HORIZONTAL SCALE: 1"=5'
VERTICAL SCALE: 1"=5'

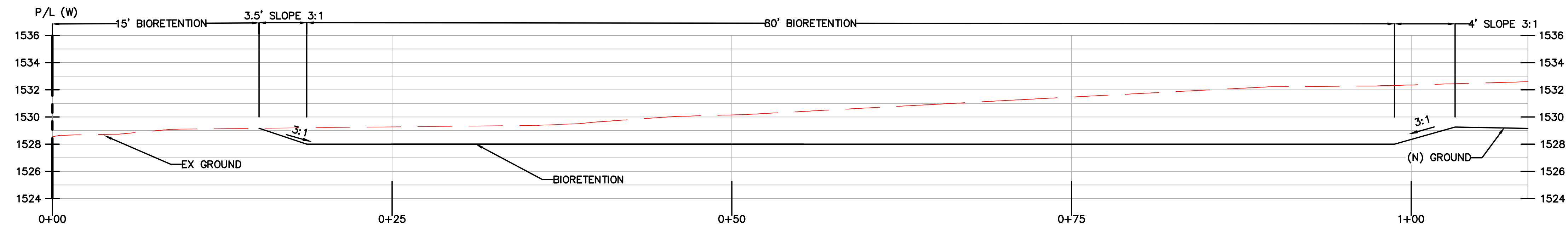

SECTION (K)
HORIZONTAL SCALE: 1"=5'
VERTICAL SCALE: 1"=5'

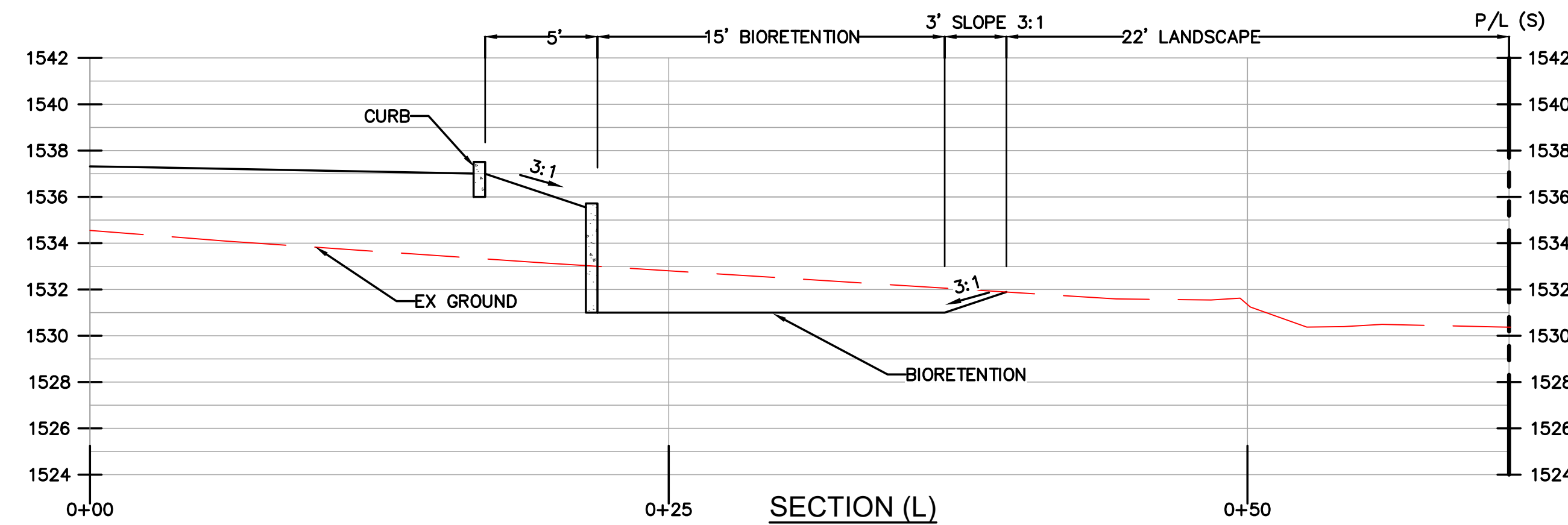

SECTION (L)
HORIZONTAL SCALE: 1"=5'
VERTICAL SCALE: 1"=5'

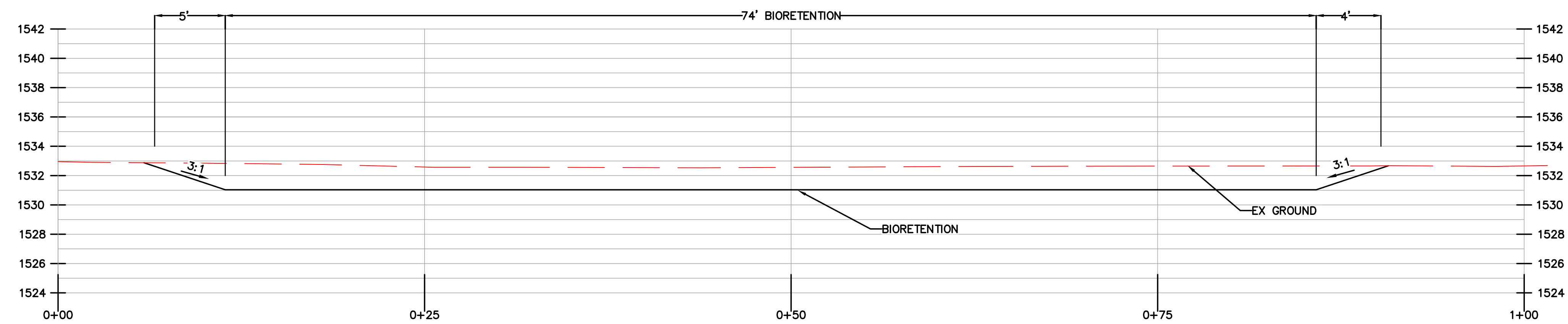

SECTION (M)
HORIZONTAL SCALE: 1"=5'
VERTICAL SCALE: 1"=5'

ENGINEERS NOTE TO CONTRACTOR:
THE EXISTENCE AND LOCATION OF ANY UNDERGROUND UTILITIES, PIPES, AND/OR STRUCTURES SHOWN ON THESE PLANS WERE OBTAINED BY A SEARCH OF AVAILABLE RECORDS. TO THE BEST OF OUR KNOWLEDGE, THERE ARE NO EXISTING UTILITIES EXCEPT AS SHOWN ON THESE PLANS. THE CONTRACTOR SHALL ASCERTAIN THE TRUE VERTICAL AND HORIZONTAL LOCATION OF THOSE UNDERGROUND UTILITIES TO BE USED AND SHALL BE RESPONSIBLE FOR ANY DAMAGE TO ANY PUBLIC OR PRIVATE UTILITIES, SHOWN OR NOT SHOWN HEREON. IF THE CONTRACTOR ENCOUNTERS ANY DISCREPANCIES, CONFLICTS OR AREAS WHICH HE FEELS UNWORKABLE, HE SHALL NOTIFY THE GRADING ENGINEER IMMEDIATELY PRIOR TO CONTINUING OR DEVIATING FROM THIS PLAN.

UNAUTHORIZED CHANGES & USES:
THE ENGINEER PREPARING THESE PLANS WILL NOT BE RESPONSIBLE FOR, OR LIABLE FOR, UNAUTHORIZED CHANGES TO OR USES OF THESE PLANS. ALL CHANGES TO THE PLANS MUST BE IN WRITING AND MUST BE APPROVED BY THE PREPARER OF THESE PLANS. CONSTRUCTION CONTRACTOR AGREES THAT IN ACCORDANCE WITH GENERALLY ACCEPTED CONSTRUCTION PRACTICES, CONSTRUCTION CONTRACTOR WILL BE REQUIRED TO ASSUME SOLE AND COMPLETE RESPONSIBILITY FOR JOB SITE CONDITIONS DURING THE COURSE OF CONSTRUCTION OF THE PROJECT, INCLUDING SAFETY OF ALL PERSONS AND PROPERTY, THAT THIS REQUIREMENT SHALL BE MADE TO APPLY CONTINUOUSLY AND NOT BE LIMITED TO NORMAL WORKING HOURS, AND CONSTRUCTION CONTRACTOR FURTHER AGREES TO DEFEND, INDEMNIFY AND HOLD DESIGN PROFESSIONAL HARMLESS FROM ANY AND ALL LIABILITY, REAL OR ALLEGED, IN CONNECTION WITH THE PERFORMANCE OF WORK ON THIS PROJECT, EXCEPTING LIABILITY ARISING FROM THE SOLE NEGLIGENCE OF DESIGN PROFESSIONAL.

UNDERGROUND SERVICE ALERT			
Call: TOLL FREE 1-800-227-2600 KNOW WHAT'S BELOW. CALL BEFORE YOU DIG TWO WORKING DAYS BEFORE YOU DIG			
NO.	BY	DATE	REVISION

PREPARED BY:

Manjit Saini

PREPARED FOR:

**NE CNR OF HWY- 49
& GEORGETOWN RD
COOL, CA 95614
APN: 071-080-007**

TITLE:

SITE SECTION-3

DATE:	12/30/2022	SHEET NO.	9 OF 12
DESIGNED BY:	N.GORAYA	REV.	0
DRAWN BY:	P. SINGH		
CHECKED BY:	M. SAINI		
APPROVED BY:	M. SAINI		

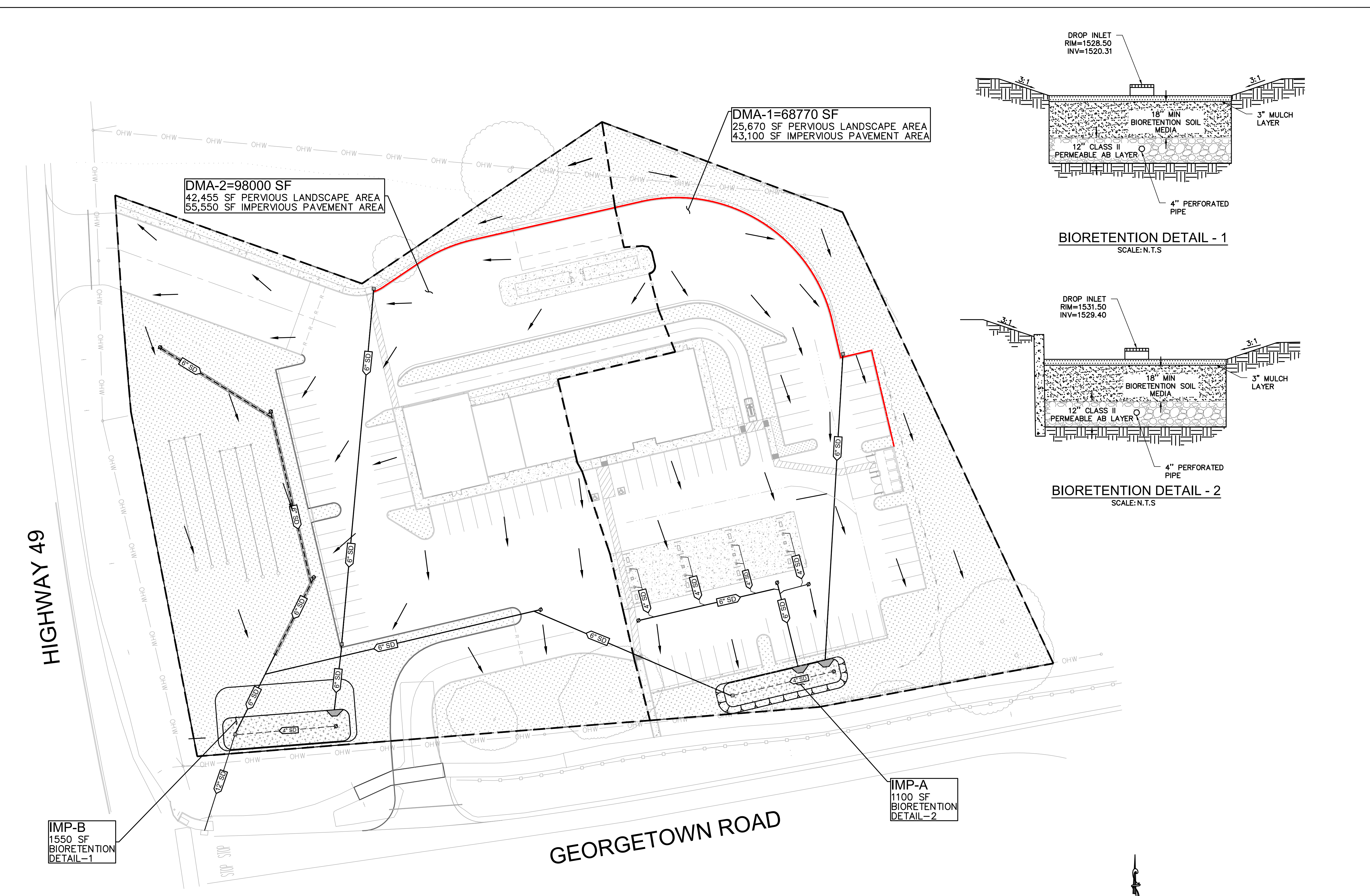

LEGEND

- PROPERTY LINE
- CATCH BASIN
- FLOW ARROW
- - - DMA BOUNDARY
- ▨ BIORETENTION
- CLEANOUT
- 4" SD 4" STORM DRAIN
- 6" SD 6" STORM DRAIN

STORMWATER QUALITY AREAS

STORMWATER QUALITY AREAS						
DMA-1*	IMPERVIOUS AREA (SF)	TOTAL AREA (SF)	PERCENTAGE IMPERVIOUS	DRAIN TO	REQUIRED BIORETENTION AREA (SF)	DESIGN BIORETENTION AREA (SF) 2*
DMA-1	43,100	68,770	63	IMP-A	1076	1100
DMA-2	55,550	98,000	57	IMP-B	1550	1550

1* DMA—DRAINAGE MANAGEMENT AREA.
2* BIOFILTRATION AREA IS ESTIMATED ON 18" MODIFIED SOIL.

BIORETENTION DETAIL - 1
SCALE: N.T.S.

BIORETENTION DETAIL - 2
SCALE: N.T.S.

BIORETENTION VOLUME CALCULATIONS

BIORETENTION-1 VOLUME				
	SF	DEPTH (FT)	VOID RATIO	CF
PONDING AREA	1100	0.5	1	550
SOIL MEDIA (25%)	1100	1.5	0.25	412.5
GRAVEL (40%)	1100	1	0.4	440
TOTAL VOLUME				1402.5

BIORETENTION-2 VOLUME				
	SF	DEPTH (FT)	VOID RATIO	CF
PONDING AREA	1550	0.5	1	775
SOIL MEDIA (25%)	1550	1.5	0.25	581.25
GRAVEL (40%)	1550	1	0.4	620
TOTAL VOLUME				1976.25

ENGINEERS NOTE TO CONTRACTOR:
THE EXISTENCE AND LOCATION OF ANY UNDERGROUND UTILITIES, PIPES, AND/OR STRUCTURES SHOWN ON THESE PLANS WERE OBTAINED BY A SEARCH OF AVAILABLE RECORDS. TO THE BEST OF OUR KNOWLEDGE, THERE ARE NO EXISTING UTILITIES EXCEPT AS SHOWN ON THESE PLANS. THE CONTRACTOR SHALL ASCERTAIN THE TRUE VERTICAL AND HORIZONTAL LOCATION OF THOSE UNDERGROUND UTILITIES TO BE USED AND SHALL BE RESPONSIBLE FOR ANY DAMAGE TO ANY PUBLIC OR PRIVATE UTILITIES, SHOWN OR NOT SHOWN HEREON. IF THE CONTRACTOR ENCOUNTERS ANY DISCREPANCIES, CONFLICTS OR AREAS WHICH HE FEELS UNWORKABLE, HE SHALL NOTIFY THE GRADING ENGINEER IMMEDIATELY PRIOR TO CONTINUING OR DEVIATING FROM THIS PLAN.

UNAUTHORIZED CHANGES & USES:
THE ENGINEER PREPARING THESE PLANS WILL NOT BE RESPONSIBLE FOR, OR LIABLE FOR, UNAUTHORIZED CHANGES TO OR USES OF THESE PLANS. ALL CHANGES TO THE PLANS MUST BE IN WRITING AND MUST BE APPROVED BY THE PREPARER OF THESE PLANS. CONSTRUCTION CONTRACTOR AGREES THAT IN ACCORDANCE WITH GENERALLY ACCEPTED CONSTRUCTION PRACTICES, CONSTRUCTION CONTRACTOR WILL BE REQUIRED TO ASSUME SOLE AND COMPLETE RESPONSIBILITY FOR JOB SITE CONDITIONS DURING THE COURSE OF CONSTRUCTION OF THE PROJECT, INCLUDING SAFETY OF ALL PERSONS AND PROPERTY, THAT THIS REQUIREMENT SHALL BE MADE TO APPLY CONTINUOUSLY AND NOT BE LIMITED TO NORMAL WORKING HOURS, AND CONSTRUCTION CONTRACTOR FURTHER AGREES TO DEFEND, INDEMNIFY AND HOLD DESIGN PROFESSIONAL HARMLESS FROM ANY AND ALL LIABILITY, REAL OR ALLEGED, IN CONNECTION WITH THE PERFORMANCE OF WORK ON THIS PROJECT, EXCEPTING LIABILITY ARISING FROM THE SOLE NEGLIGENCE OF DESIGN PROFESSIONAL.

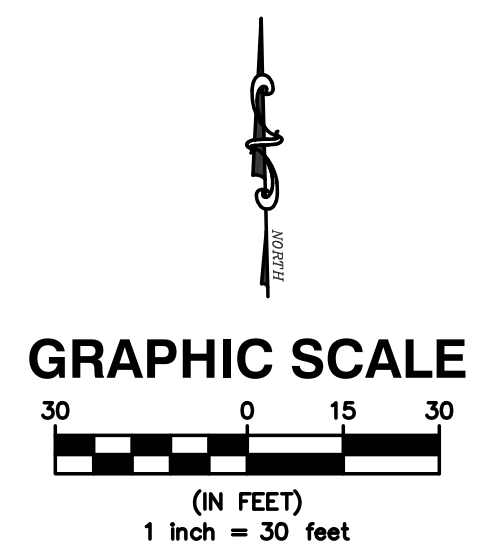

UNDERGROUND SERVICE ALERT			
NO.	BY	DATE	REVISION

PREPARED BY:

Manjit Saini

PREPARED FOR:

**NE CNR OF HWY- 49
& GEORGETOWN RD
COOL, CA 95614
APN: 071-080-007**

TITLE:

STORMWATER MANAGEMENT PLAN

DATE:	12/30/2022	SHEET NO.	C-9.0
DESIGNED BY:	N.GORAYA		10 OF 12
DRAWN BY:	P. SINGH		
CHECKED BY:	M. SAINI	REV.	0
APPROVED BY:	M. SAINI		

HIGHWAY 49

GEORGETOWN ROAD

IMP-B
1550 SF
BIORETENTION
DETAIL-1

IMP-A
1100 SF
BIORETENTION
DETAIL-2

DMA-1=68770 SF
25,670 SF PEROVIOUS LANDSCAPE AREA
43,100 SF IMPERVIOUS PAVEMENT AREA

DMA-2=98000 SF
42,455 SF PEROVIOUS LANDSCAPE AREA
55,550 SF IMPERVIOUS PAVEMENT AREA

LEGEND

- BOUNDARY
- LEACH LINES
- CULVERT
- 6" SD STORM DRAIN
- 4" SD STORM DRAIN
- 4" SD PERFORATED STORM DRAIN
- 6" SS SANITARY DRAIN
- ☐ CATCH BASIN
- STORM CLEANOUT
- SANITARY CLEANOUT

GENERAL CONSTRUCTION NOTES

1. VERIFY THE SIZES AND MATERIAL OF ALL UTILITY PIPES WITH BUILDING MECHANICAL.
2. COORDINATE WITH UTILITIES AGENCIES TO OBTAIN ALL THE PERMITS TO INSTALL UTILITIES AT THE SITE AND MAKE CONNECTIONS.
3. UTILITIES SHALL BE INSTALLED IN ACCORDANCE WITH THE STANDARDS/SPECIFICATIONS OF THE UTILITY AGENCY.
4. VERIFY EXISTING UTILITIES PRIOR TO CONSTRUCTION.

WATER LINE CONSTRUCTION NOTES

- ① INSTALL NEW DOMESTIC (POTABLE), CARWASH, IRRIGATION & FIRE SERVICES TIE-IN WITH EXISTING WATER MAIN LINE. CONTRACTOR TO VERIFY LOCATION AND DEPTH PRIOR TO CONSTRUCTION.
- ② INSTALL 2" INCH WATER METER FOR POTABLE WATER SERVICE & CAR WASH PER COUNTY STANDARDS.
- ③ INSTALL REDUCED PRESSURE BACKFLOW PREVENTER FOR POTABLE SERVICE & CAR WASH SERVICE PER COUNTY STANDARDS.
- ④ INSTALL 2" INCH DOMESTIC BRASS (AWWA C800-01) PIPE FOR CAR WASH SERVICE, TRENCH & BACKFILL PER COUNTY STANDARDS.
- ⑤ INSTALL 2" INCH SCHEDULE 40 PIPE FOR POTABLE SERVICE, TRENCH & BACKFILL PER COUNTY STANDARDS.
- ⑥ INSTALL 1.5" INCH WATER METER FOR IRRIGATION SERVICE PER COUNTY STANDARDS.
- ⑦ INSTALL REDUCED PRESSURE BACKFLOW PREVENTER FOR IRRIGATION SERVICE PER COUNTY STANDARDS.
- ⑧ INSTALL REDUCED PRESSURE PRINCIPLE DEVICE WITH FDC PER PER COUNTY STANDARDS.
- ⑨ INSTALL 6" PVC C900 FIRE LINE TO FIRE SPRINKLER SYSTEM, TRENCH & BACKFILL PER COUNTY STANDARDS.
- ⑩ DOMESTIC (POTABLE WATER SERVICE) POINT OF CONNECTION (P.O.C). GENERAL CONTRACTOR TO CAP DOMESTIC WATER LINE MIN. 18" BELOW FINISH GRADE OF PARKING LOT AND MARK STUB OUT LOCATION WITH WOODEN 2X4 PAINTED BLUE.
- ⑪ FIRE POINT OF CONNECTION (P.O.C). GENERAL CONTRACTOR TO CAP FIRE WATER LINE MIN. 18 INCH BELOW FINISH GRADE OF PARKING LOT AND MARK STUB OUT LOCATION WITH WOODEN 2X4 PAINTED BLUE.
- ⑫ CAR WASH POINT OF CONNECTION (P.O.C). GENERAL CONTRACTOR TO CAP CAR WASH WATER LINE MIN. 18" BELOW FINISH GRADE OF PARKING LOT AND MARK STUB OUT LOCATION WITH WOODEN 2X4 PAINTED BLUE.
- ⑬ IRRIGATION POINT OF CONNECTION (P.O.C).

SANITARY SEWER CONSTRUCTION NOTES

- S1 INSTALL 6" PVC SDR 26 SANITARY SEWER.
- S2 PIPE BEDDING FOR SANITARY SEWER AS PER COUNTY STANDARDS.
- S3 INSTALL SEWER CLEANOUT AS PER COUNTY STANDARDS.
- S4 INSTALL OIL AND GREASE INTERCEPTOR PER COUNTY STANDARDS.
- SS SANITARY SERVICE POINT OF CONNECTION. GENERAL CONTRACTOR MARK STUB OUT LOCATION WITH WOODEN 2X4 PAINTED BLUE.
- SS INSTALL SEPTIC TANK PER COUNTY STANDARDS.
- S7 INSTALL DIVERSION VALVE FOR LEACH FIELD PER COUNTY STANDARDS.
- S8 INSTALL SAND AND OIL INTERCEPTOR PER PER COUNTY STANDARDS.

STORMDRAIN SYSTEM NOTES

- ① INSTALL 6" PVC SDR 35 STORM DRAIN.
- ② INSTALL CATCH BASIN PER COUNTY STANDARDS.
- ③ INSTALL 4" PERFORATED STORM DRAIN.
- ④ NOT USED.
- ⑤ INSTALL STORM CLEANOUT AS PER COUNTY STANDARDS.
- ⑥ BIORETENTION AREA.

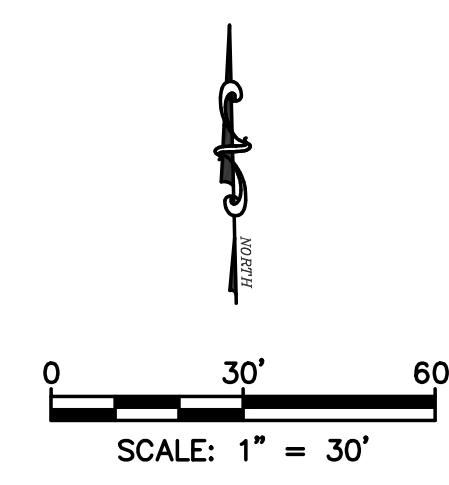
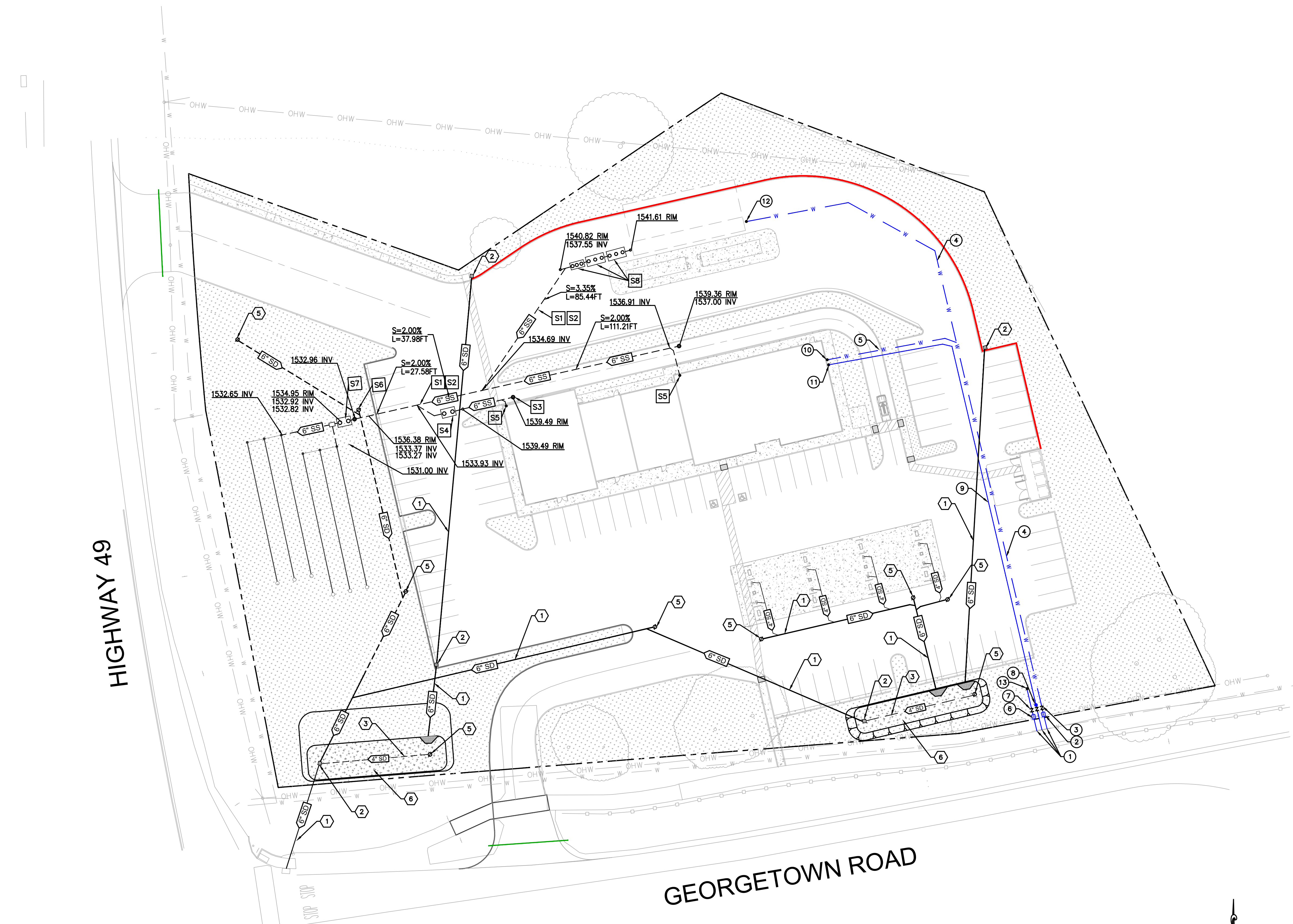

ENGINEERS NOTE TO CONTRACTOR:
 THE EXISTENCE AND LOCATION OF ANY UNDERGROUND UTILITIES, PIPES, AND/OR STRUCTURES SHOWN ON THESE PLANS WERE OBTAINED BY A SEARCH OF AVAILABLE RECORDS. TO THE BEST OF OUR KNOWLEDGE, THERE ARE NO EXISTING UTILITIES EXCEPT AS SHOWN ON THESE PLANS. THE CONTRACTOR SHALL ASCERTAIN THE TRUE VERTICAL AND HORIZONTAL LOCATION OF THOSE UNDERGROUND UTILITIES TO BE USED AND SHALL BE RESPONSIBLE FOR ANY DAMAGE TO ANY PUBLIC OR PRIVATE UTILITIES, SHOWN OR NOT SHOWN HEREON. IF THE CONTRACTOR ENCOUNTERS ANY DISCREPANCIES, CONFLICTS OR AREAS WHICH HE FEELS UNWORKABLE, HE SHALL NOTIFY THE GRADING ENGINEER IMMEDIATELY PRIOR TO CONTINUING OR DEVIATING FROM THIS PLAN.

UNAUTHORIZED CHANGES & USES:
 THE ENGINEER PREPARING THESE PLANS WILL NOT BE RESPONSIBLE FOR, OR LIABLE FOR, UNAUTHORIZED CHANGES TO OR USES OF THESE PLANS. ALL CHANGES TO THE PLANS MUST BE IN WRITING AND MUST BE APPROVED BY THE PREPARER OF THESE PLANS. CONSTRUCTION CONTRACTOR AGREES THAT IN ACCORDANCE WITH GENERALLY ACCEPTED CONSTRUCTION PRACTICES, CONSTRUCTION CONTRACTOR WILL BE REQUIRED TO ASSUME SOLE AND COMPLETE RESPONSIBILITY FOR JOB SITE CONDITIONS DURING THE COURSE OF CONSTRUCTION OF THE PROJECT, INCLUDING SAFETY OF ALL PERSONS AND PROPERTY, THAT THIS REQUIREMENT SHALL BE MADE TO APPLY CONTINUOUSLY AND NOT BE LIMITED TO NORMAL WORKING HOURS, AND CONSTRUCTION CONTRACTOR FURTHER AGREES TO DEFEND, INDEMNIFY AND HOLD DESIGN PROFESSIONAL HARMLESS FROM ANY AND ALL LIABILITY, REAL OR ALLEGED, IN CONNECTION WITH THE PERFORMANCE OF WORK ON THIS PROJECT, EXCEPTING LIABILITY ARISING FROM THE SOLE NEGLIGENCE OF DESIGN PROFESSIONAL.

NO.	BY	DATE	REVISION

PREPARED BY:

Manjit Saini

PREPARED FOR:

**NE CNR OF HWY- 49
 & GEORGETOWN RD
 COOL, CA 95614
 APN: 071-080-007**

TITLE:

UTILITY PLAN

DATE:	12/30/2022	SHEET NO.	11 OF 12
DESIGNED BY:	N.GORAYA	REV.	0
DRAWN BY:	P. SINGH		
CHECKED BY:	M. SAINI		
APPROVED BY:	M. SAINI		

UNDERGROUND SERVICE ALERT

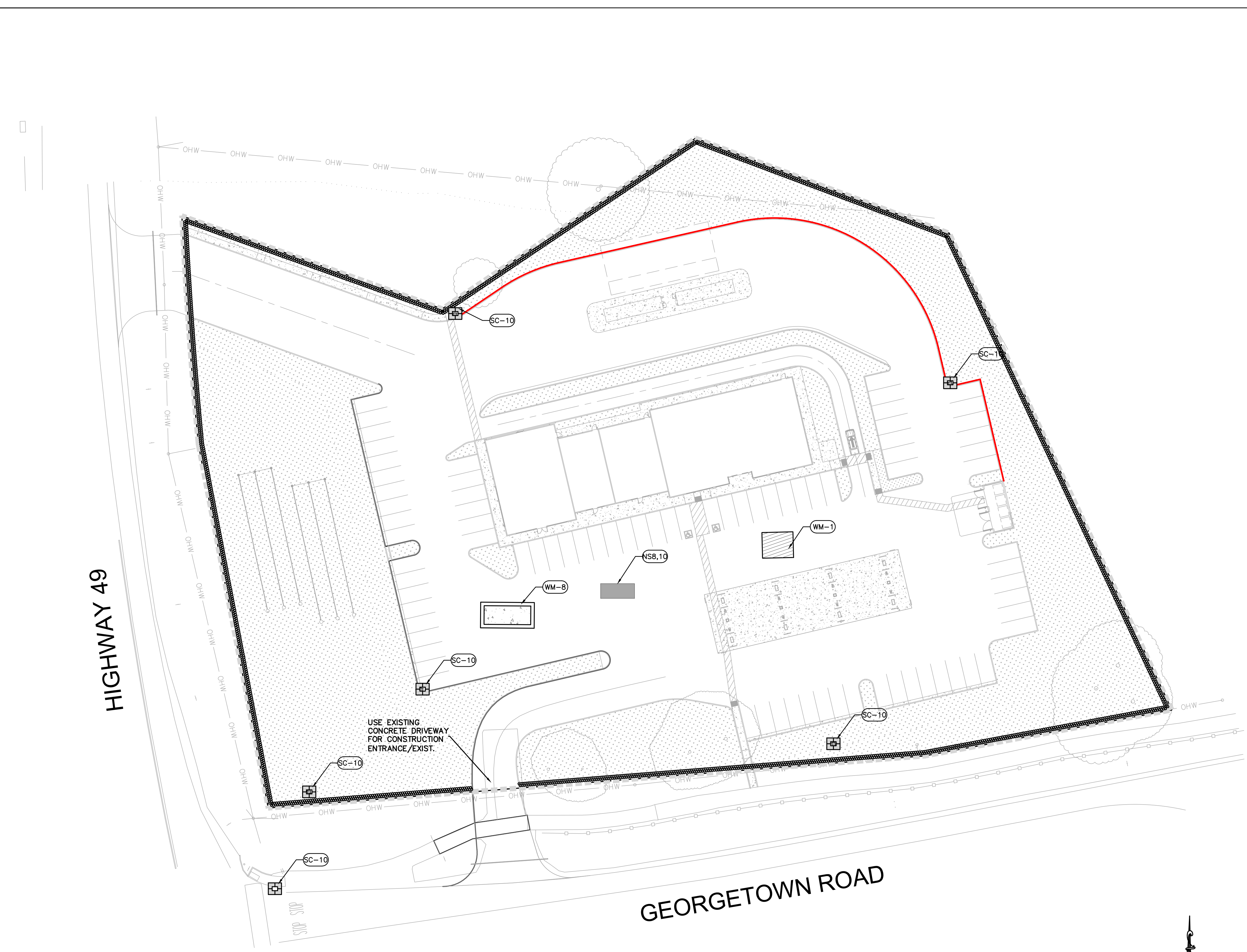

BMP LEGEND

- STABILIZED CONSTRUCTION ENTRANCE/EXIT (TC-1)
- CONCRETE WASHOUT AREA (WM-8)
- VEHICLE CLEANING AND MAINTENANCE (NS-8,10)
- MATERIAL STORAGE (WM-1)
- FIBER ROLL (SC-5)
- DRAIN INLET PROTECTION (SC-10)
- DISTURBED AREA

BMPs	MAINTENANCE
VEHICLE AND EQUIPMENT CLEANING/MAINTENANCE AREA	<ol style="list-style-type: none"> INSPECT AND MAINTENANCE IS MINIMAL, ALTHOUGH SOME BERM REPAIR MAY BE NECESSARY. INSPECT SUMP REGULARLY AND REMOVE LIQUIDS AND SEDIMENT AS NEEDED. VEHICLES AND EQUIPMENT SHOULD BE INSPECTED ON EACH DAY OF USE. LEAKS SHOULD BE REPAIRED IMMEDIATELY OR THE PROBLEM VEHICLE(S) OR EQUIPMENT SHOULD BE REMOVED FROM THE PROJECT SITE. KEEP STORAGE AREA CLEAN AND WELL ORGANIZED, INCLUDING A CURRENT LIST OF ALL MATERIALS ONSITE.
FIBER ROLL	<ol style="list-style-type: none"> REPAIR OR REPLACE SPLIT, TORN, UNRAVELING, OR SLUMPING FIBER ROLLS. IF THE FIBRE ROLL IS USED AS A SEDIMENT CAPTURE DEVICE, OR AS AN EROSION CONTROL DEVICE TO MAINTAIN SHEET FLOWS, SEDIMENT THAT ACCUMULATES IN THE BMP SHOULD BE PERIODICALLY REMOVED IN ORDER TO MAINTAIN BMP EFFECTIVENESS. SEDIMENT SHOULD BE REMOVED WHEN SEDIMENT ACCUMULATION REACHES ONE-THIRD THE DESIGNATED STORAGE DEPTH. IF FIBRE ROLLS ARE USED FOR EROSION CONTROL, SUCH AS IN A CHECK DAM, SEDIMENT REMOVAL SHOULD NOT BE REQUIRED AS LONG AS THE SYSTEM CONTINUES TO CONTROL THE GRADE. SEDIMENT CONTROL BMPs WILL LIKELY BE REQUIRED IN CONJUNCTION WITH THIS TYPE OF APPLICATION.
CONCRETE WASHOUTS	<ol style="list-style-type: none"> TEMPORARY CONCRETE WASHOUT FACILITIES SHOULD BE MAINTAINED TO PROVIDE ADEQUATE HOLDING CAPACITY WITH A MINIMUM FREEBOARD OF 4IN. FOR ABOVE GRADE FACILITIES. MAINTAINING TEMPORARY CONCRETE WASHOUT FACILITIES SHOULD INCLUDE REMOVING AND DISPOSING OF HARDENED CONCRETE AND RETURNING THE FACILITIES TO A FUNCTIONAL CONDITION. HARDENED CONCRETE MATERIALS SHOULD BE REMOVED AND PROPERLY DISPOSED OR RECYCLED IN ACCORDANCE WITH FEDERAL, STATE OR LOCAL REGULATIONS. CONCRETE WASHOUTS SHALL BE CLEANED WHEN THE WASTE VOLUME IN THE WASHOUT REACHES 75 PERCENT OF CAPACITY. INSPECT WASHOUT FACILITIES FOR DAMAGE (E.G. TORN LINER, EVIDENCE OF LEAKS, SIGNAGE, ETC.). REPAIR ALL IDENTIFIED DAMAGE.
STABILIZED CONSTRUCTION ACCESS	<ol style="list-style-type: none"> INSPECT STABILIZED CONSTRUCTION ACCESS DAILY FOR DAMAGE AND EFFECTIVENESS OF PREVENTING SOIL, SEDIMENT, AND CONSTRUCTION DEBRIS FROM BEING TRACKED ONTO PUBLIC STREETS. STREETS ADJACENT TO STABILIZED CONSTRUCTION ACCESS AREAS SHALL BE SWEEP DAILY TO REMOVE LOOSE MATERIALS. REMOVE AGGREGATE, SEPARATE, AND DISPOSED OF SEDIMENT IF CONSTRUCTION ACCESS IS CLOGGED WITH SEDIMENT OR AS DIRECTED BY THE COUNTY INSPECTOR.
MATERIAL & WASTE DISPOSAL LOCATION	INSPECT SITE ON A WEEKLY BASIS TO EXAMINE CONSTRUCTION MATERIALS ARE PROPERLY STORED AND WASTE IS PROPERLY DISPOSED TO PREVENT WATER POLLUTION.

NOTE:
BMPs MUST BE INSPECTED IN ACCORDANCE WITH GENERAL PERMIT REQUIREMENTS FOR THE ASSOCIATED PROJECT TYPE AND RISK LEVEL. IT IS RECOMMENDED THAT AT A MINIMUM, BMPs BE INSPECTED WEEKLY, PRIOR TO FORECASTED RAIN EVENTS, DAILY DURING EXTENDED RAIN EVENTS, AND AFTER THE CONCLUSION OF RAIN EVENTS.

SEDIMENT CONTROL	REFERENCE ID	TEMPORARY TRACKING CONTROL	REFERENCE ID
SILT FENCE	SE-1	STABILIZED CONSTRUCTION ENTRANCE/EXIT	TC-1
FIBRE ROLLS	SE-5		
INLET SEDIMENT CONTROL	SE-10		
WASTE MANAGEMENT AND MATERIALS POLLUTION CONTROL	REFERENCE ID	NON-STORMWATER MANAGEMENT CONTROL	REFERENCE ID
MATERIAL DELIVERY AND STORAGE	WM-1	VEHICLE AND EQUIPMENT CLEANING	NS-8
CONCRETE WASHOUT AREA	WM-8	VEHICLE AND EQUIPMENT MAINTENANCE	NS-10

NOTE:
FOR DETAILS ON CONSTRUCTION AND IMPLEMENTATION OF BMPs REFER CASQA MANUAL 2009

DISTURBED AREA=3.83 ACRES

ENGINEERS NOTE TO CONTRACTOR:
THE EXISTENCE AND LOCATION OF ANY UNDERGROUND UTILITIES, PIPES, AND/OR STRUCTURES SHOWN ON THESE PLANS WERE OBTAINED BY A SEARCH OF AVAILABLE RECORDS. TO THE BEST OF OUR KNOWLEDGE, THERE ARE NO EXISTING UTILITIES EXCEPT AS SHOWN ON THESE PLANS. THE CONTRACTOR SHALL ASCERTAIN THE TRUE VERTICAL AND HORIZONTAL LOCATION OF THOSE UNDERGROUND UTILITIES TO BE USED AND SHALL BE RESPONSIBLE FOR ANY DAMAGE TO ANY PUBLIC OR PRIVATE UTILITIES, SHOWN OR NOT SHOWN HEREON. IF THE CONTRACTOR ENCOUNTERS ANY DISCREPANCIES, CONFLICTS OR AREAS WHICH HE FEELS UNWORKABLE, HE SHALL NOTIFY THE GRADING ENGINEER IMMEDIATELY PRIOR TO CONTINUING OR DEVIATING FROM THIS PLAN.

UNAUTHORIZED CHANGES & USES:
THE ENGINEER PREPARING THESE PLANS WILL NOT BE RESPONSIBLE FOR, OR LIABLE FOR, UNAUTHORIZED CHANGES TO OR USES OF THESE PLANS. ALL CHANGES TO THE PLANS MUST BE IN WRITING AND MUST BE APPROVED BY THE PREPARER OF THESE PLANS. CONSTRUCTION CONTRACTOR AGREES THAT IN ACCORDANCE WITH GENERALLY ACCEPTED CONSTRUCTION PRACTICES, CONSTRUCTION CONTRACTOR WILL BE REQUIRED TO ASSUME SOLE AND COMPLETE RESPONSIBILITY FOR JOB SITE CONDITIONS DURING THE COURSE OF CONSTRUCTION OF THE PROJECT, INCLUDING SAFETY OF ALL PERSONS AND PROPERTY, THAT THIS REQUIREMENT SHALL BE MADE TO APPLY CONTINUOUSLY AND NOT BE LIMITED TO NORMAL WORKING HOURS, AND CONSTRUCTION CONTRACTOR FURTHER AGREES TO DEFEND, INDEMNIFY AND HOLD DESIGN PROFESSIONAL HARMLESS FROM ANY AND ALL LIABILITY, REAL OR ALLEGED, IN CONNECTION WITH THE PERFORMANCE OF WORK ON THIS PROJECT, EXCEPTING LIABILITY ARISING FROM THE SOLE NEGLIGENCE OF DESIGN PROFESSIONAL.

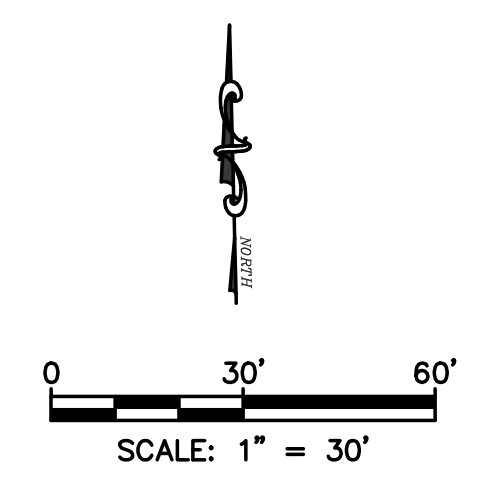

NO.	BY	DATE	REVISION

PREPARED BY:

Manjit Saini

PREPARED FOR:

**NE CNR OF HWY- 49
& GEORGETOWN RD
COOL, CA 95614
APN: 071-080-007**

TITLE:

**EROSION & SEDIMENT
CONTROL PLAN**

DATE:	12/30/2022	SHEET NO.	12 OF 12
DESIGNED BY:	N.GORAYA	REV.	0
DRAWN BY:	P. SINGH		
CHECKED BY:	M. SAINI		
APPROVED BY:	M. SAINI		

UNDERGROUND SERVICE ALERT

Call: TOLL FREE
1-800-227-2600

KNOW WHAT'S BELOW.
CALL BEFORE YOU DIG

TWO WORKING DAYS BEFORE YOU DIG